



DENTAL COMPRESSOR PM CHECKLIST For Lubricated Compressors

Refer to the owner's manual for specific safety information and PM Schedule.

WARNING: To avoid personal injury, do not perform these steps while compressor is running. Compressor head and connection tubing is hot during operation. Wait until unit and tubing are cool.

NOTE: For models with more than one compressor head, follow the same procedure(s) for each compressor head.

PREP

- 1) Remove power from the compressor by first turning the compressor off and then disconnecting the unit from the power source.
- 2) Bleed all the stored air from the system by opening the safety valve. **Note: A loud blast of air will occur when the safety valve is opened.** Make sure the tank pressure gauge reads 0 PSI once the air has been completely exhausted.
- 3) Using a stiff brush, clean between the cooling vanes and ribs on the compressor head and fan, removing any dust and debris. Wipe down the compressor, making note of any visible oil or water stains and investigate potential causes.

CHANGING THE OIL

For Copeland Head Compressors:

- 1) Remove the oil drain plug and drain the oil into RPI's **Disposal Bag (HCG/RPI Part #RPB838)** included in this Kit. Or, if the compressor has been upgraded with the RPI **Drain Valve (HCG/RPI Part #RPV841)**, simply attach the **Tubing (HCG/RPI Part #RPT849)** to the drain valve, then open the drain valve tee-handle to allow oil to drain into RPI's **Disposal Bag (HCG/RPI Part #RPB838)**.
- 2) Once oil no longer flows from the drain port or valve, tip the compressor head assembly to allow trapped oil to drain from the compressor head. Or simply use RPI's **Syringe Pump/Extractor (HCG/RPI Part #RPT842)** by placing the tubing down through the fill spout and extracting the remaining oil from the compressor head.
- 3) Clean the drain port and threads, then reinstall the drain plug. Or, if the compressor has the RPI Drain Valve, then simply close the tee-handle and remove tubing.
- 4) Attach the yorcker cap onto the bottle of **Compressor Oil (HCG/RPI Part #CML001)** included in this Kit - *SDS sheet available on RPI website, www.rpiparts.com*. Place the extended tube into the fill spout and begin adding oil until the oil level fills between 1/2 to 3/4 of the oil sight glass. **Do not overfill.**

For Jun-Air Series 700 Compressors:

- 1) Remove the ribbed cover.
- 2) Extract the oil from the motor housing using a suction tube (or other method), or RPI's **Syringe Pump/Extractor (HCG/RPI Part #RPT842)**. Place used oil in RPI's **Disposal Bag (HCG/RPI Part #RPB838)** included in this Kit. If dirt particles are present at the bottom of the motor housing, clean with a lint free cloth.
- 3) Inspect, clean, and replace the **Ribbed Cover O-Ring (HCG/RPI Part #RPO848)** included in this Kit, and reinstall the cover onto the motor housing. Remove the oil plug from the top of the ribbed cover.
- 4) Remove the cap on **Synthetic Compressor Oil (HCG/RPI Part #CML119)** included in this Kit - *SDS sheet available on RPI website, www.rpiparts.com*. Pour into the oil plug opening and begin adding oil into the motor housing until the oil level fills between 1/2 to 3/4 of the oil sight glass. **Do not overfill.**
- 5) After replacing the oil, clean the **Oil Plug (HCG/RPI Part #CMP196)**. Replace the **Oil Plug Gasket (HCG/RPI Part #CMG197)** included in this Kit and reinstall the oil plug.

FILTERS

- When replacing the **air intake filters**, always work on one element at a time. For air intake filters that are mounted inside the compressor head or housing, use a lint free cloth to clean out dust and debris that may be present. Once the air intake filters have been replaced, write the date on the PM Sticker(s) provided with each filter element and place on or near the air intake filter assembly.
- When replacing the **particle, coalescing or carbon filter elements**, always work on one element at a time. Elements with downward hanging bowls should be removed slowly as they may be full of oil and water. Once the bowl is removed, unscrew the used element, replace with new element, and check the float for proper function. Replace the **Bowl O-ring** included in this Kit before reinstalling the bowl. Once the elements have been replaced, write the date on the PM Sticker(s) included in this Kit and place in an easily visible location on or near the filter assembly.
- Inspect purge mufflers and exhaust silencers. Replace as needed.

INSPECT & CLEAN

- Empty the collection bottle or bucket and replace as needed. Check the tubing that runs to the bottle or bucket for any twists, kinks or damage and replace if necessary.
- Clean and wipe down the compressor, removing any spills or hand prints.
- Reconnect power to the compressor and turn the unit on.

FINAL CHECKS

- Watch and listen as the compressor pumps the holding tank back up to capacity (-100 PSI), checking for any air or oil leaks. Make sure the pressure switch turns the compressor off at -100 PSI.
- Bleed off air and make sure compressor turns back on at -80 PSI and off again at -100 PSI. Run several cycles to confirm the pressure switch is functioning properly.
- Check the condition of the Moisture Indicator. For dry air, the color must be blue; pink means that the desiccant drying chamber must be serviced or replaced. Consult the label on the moisture indicator to evaluate moisture content.
- Dispose of used compressor oil, filters and mufflers in accordance with local, state and federal regulations.
- Write the RPI PM Kit Number and date on the PM Sticker included in this Kit and place in an easily visible location on the compressor.



LUBRICATED COMPRESSOR PM KITS

RPI Parts Included In PM Kits

HCG/RPI Part #	OEM Part #	Models	Air Intake Filter Elements						Coalescing Filter Elements						Oil		Acc.											
			CME004	CME067	CME069	CME071	CME074	CMF013	CMF014	CMF073	CMF075	CMK065	CME043	CME044	CME102	CME103	CME104	CME105	CME107	CME110	CMK024	CMK027	CML001	CML119	RPB838	RPO848	CMG197	
APOLLO/MIDMARK																												
CMK173	ACA85407	ALCQL82/D	4																									
CMK160	ACA85402	ALCRL62/D	3																									
CMK167	ACA85400	ALCSL11/D, 12/D, 21/D, & 22/D	1																									
CMK159	ACA85401	ALCTL31/D, 32/D, 41/D & 42/D	2																									
DENTALEZ /CUSTOM AIR/JUN-AIR/RAMVAC																												
CMK152	65468176	CA-711 & 721																										
CMK153	65468177	CA-713 & 723																										
CMK154	65468178	CA-725																										
MATRIX/MIDMARK																												
CMK185	No OEM Part # Available	AMD-2 & 2-115																										
CMK186	No OEM Part # Available	AMD-4																										
CMK187	No OEM Part # Available	AMD-6																										
CMK167	77000958	AMD-100 & 101	1																									
CMK168	77000959	AMD-100-2	2																									
CMK169	77000960	AMD-100-3	3																									
CMK263	No OEM Part # Available	AMD-100 & AMD-102 (Manufactured before Midmark acquired Matrix)																										
CMK264	No OEM Part # Available	AMD-100-2 (Manufactured before Midmark acquired Matrix)																										
CMK265	No OEM Part # Available	AMD-100-3 (Manufactured before Midmark acquired Matrix)																										
CMK266	No OEM Part # Available	AC-075, AC-100 & AC-101																										
CMK267	No OEM Part # Available	AC-100-2																										
CMK268	No OEM Part # Available	ACD-075, ACD-100 & ACD-101																										
CMK269	No OEM Part # Available	ACD-100-2																										
MIDMARK																												
CMK158	77001633	CL21 & CL22	1																									
CMK159	77001634	CL32	2																									
CMK160	77001635	CL52	3																									
TECH WEST																												
CMK188	CSKL-1	ACL2S1/ND & ACL2S2/ND (2005 and earlier)		1																								
CMK182	CSKL-1P	ACL2S1 & 2S2 (2006 and later)		1																								
CMK189	CSKL-2	ACL4D2/ND (2005 and earlier)		1																								
CMK183	CSKL-2P	ACL4D2 (2006 and later)		1																								
CMK190	CSKL-3	ACL6T2/ND (2005 and earlier)			1																							
CMK184	CSKL-3P	ACL6T2 (2006 and later)			1																							

LUBRICATED COMPRESSOR PM TOOLS & PARTS

Fits APOLLO/MATRIX/MIDMARK, DENTALEZ/CUSTOM AIR/JUN-AIR/RAMVAC, and TECH WEST

HCG/RPI Part #RPT842
OEM Part # (No OEM Part # Available)

SYRINGE PUMP/EXTRACTOR

- 200 CC capacity
- This essential tool allows complete removal of oil from a compressor without needing to tilt or disassemble the unit - It's the RPI Advantage!
- Also available: Cap (HCG/RPI Part #RPC847), Seal Kit (HCG/RPI Part #RPK846), and Tubing (HCG/RPI Part #RPT276)

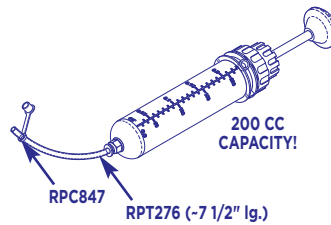

HCG/RPI Part #RPV841
OEM Part #PVV50525 (Plug)

DRAIN VALVE

- Replace the existing drain plug with RPI's new Drain Valve and make your next compressor oil change a breeze! RPI's Drain Valve has a special Tee-handle that allows you to easily open and close the valve to control the flow of oil as it is draining into the Disposal Bag - It's the RPI Advantage!

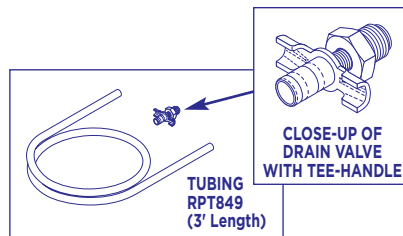

HCG/RPI Part #RPB838
OEM Part # (No OEM Part # Available)

DISPOSAL BAG

- 3 per package
- RPI's one gallon bag is constructed of durable clear plastic with an expandable base, a built in handle and a tight sealing cap. It's the perfect solution for carrying, storing and disposing of used oil!

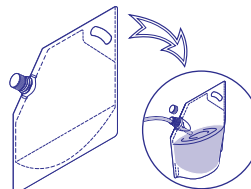

HCG/RPI Part #CMP196
OEM Part #JA7167000 (DentalEZ/
 Custom Air/RamVac)/**7167000** (Jun-Air)

OIL PLUG

- Includes all parts as shown
- Fits:** Ribbed Cover

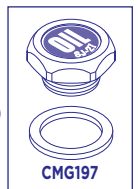

HCG/RPI Part #CMG197
OEM Part #JA6235000 (DentalEZ/
 Custom Air/RamVac)/**6235000** (Jun-Air)

DRAIN PLUG GASKET

- 3 per package
- Size: .668" ID x .889" OD x .066" thk
- Fits:** Oil Plug



HCG/RPI Part #RPO848
OEM Part #JA6244000
 (DentalEZ/Custom Air/RamVac)/
6244000 (Jun-Air)

O-RING (RIB COVER GASKET)

- Size: 176mm ID x 182mm OD x 3mm C/S
- Fits:** Ribbed Cover of the JunAir M6 Motors

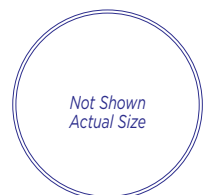

Fits JUN-AIR Series 700 Compressors