

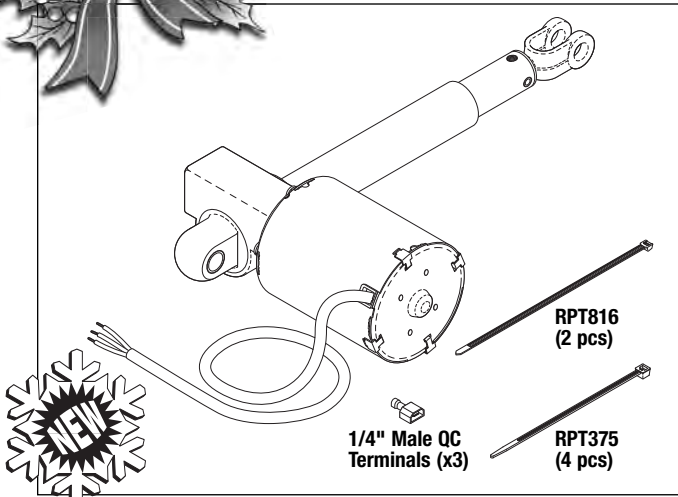

# Just in time for the holidays ...

## New parts to fit Midmark®•Ritter® 411 & 419 Exam Tables and Chairs



**RPI Part #MIA164**  
**OEM Part #002-0215-00 & 002-0590-00**

### BACK & FOOT ACTUATOR

- 2.7 A @ 115VAC
- Includes: (2 pcs) Cable Tie (RPI Part #RPT816), (4 pcs) Cable Tie (RPI Part #RPT375) & (3) 1/4" Male QC Terminals
- Also available: Brake & Coupler Kit (RPI Part #MIK167)

**Fits:** Table Back and/or Foot Section

**Model 411:** -001 thru -008 with Serial # prefixes AV & DJ

**Model 419:** -001 and -002 with Serial # prefix AY

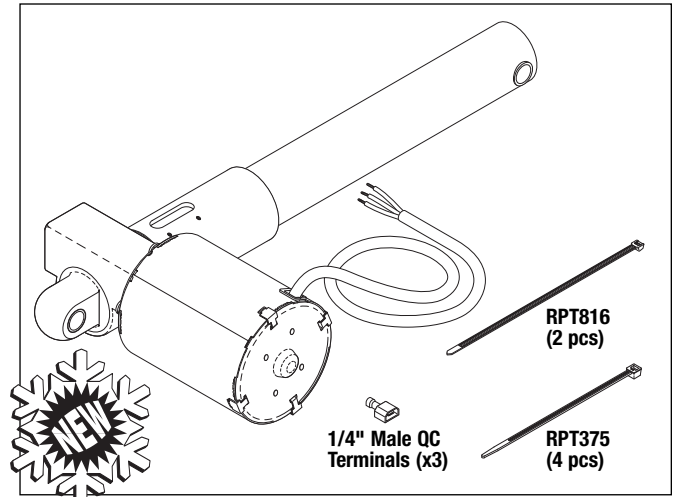

**RPI Part #MIA165**  
**OEM Part #002-0214-00 & 002-0562-00**

### BASE & TILT ACTUATOR

- 2.7 A @ 115VAC
- Includes: (2 pcs) Cable Tie (RPI Part #RPT816), (4 pcs) Cable Tie (RPI Part #RPT375) & (3) 1/4" Male QC Terminals
- Also available: Brake & Coupler Kit (RPI Part #MIK167) and Support Bar (RPI Part #MIT177)

**Fits:** Table Base and/or Tilt Section

**Model 411:** -001 thru -008 with Serial # prefixes AV & DJ

**Model 419:** -001 and -002 with Serial # prefix AY

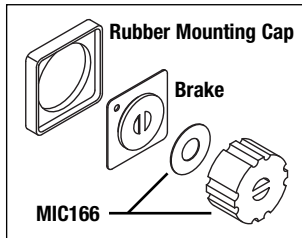

**RPI Part #MIK167**  
**OEM Part #016-0237-00 (Brake only)**

### BRAKE & COUPLER KIT

- Includes all parts as shown
- Also included in: Back & Foot Actuator (RPI Part #MIA164) and Base & Tilt Actuator (RPI Part #MIA165)

**Fits:** Only fits Back & Foot Actuator and Base & Tilt Actuator manufactured by Motion Systems

**Model 411:** -001 thru -008 with Serial # prefixes AV & DJ

**Model 419:** -001 and -002 with Serial # prefix AY

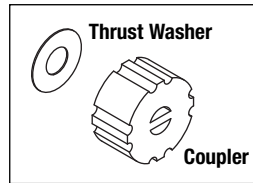

**RPI Part #MIC166**  
**OEM Part #016-0509-00**

### MOTOR COUPLER

- Size: 1.00" OD x .48" thk.
- Couples 5/16" dia. slotted shafts
- Includes all parts as shown
- Also included in: Brake & Coupler Kit (RPI Part #MIK167), Back & Foot Actuator (RPI Part #MIA164) & Base & Tilt Actuator (RPI Part #MIA165)

**Fits:** Back & Foot Actuator and Base & Tilt Actuator

**Model 411:** -001 thru -008 with Serial # prefixes AV & DJ

**Model 419:** -001 and -002 with Serial # prefix AY

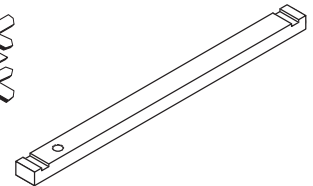

**RPI Part #MIT177**  
**OEM Part #051-0412-00**

### SUPPORT BAR

- Use to support the weight of the table top when replacing the base actuator and the Gas Cylinder.
- Also available: Base & Tilt Actuator (RPI Part #MIA165) & Gas Cylinder (RPI Part #MIC176)

**Fits:** Left and Right Side Panels

**Model 411:** -001 thru -008 with Serial # prefixes AV & DJ

**Model 419:** -001 and -002 with Serial # prefix AY

**Look for more new parts to fit Midmark®•Ritter® Exam Tables and Chairs in the beginning of next year!**