

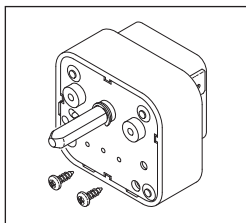

Models: Henry Schein® Dental, L&R, Ney (Dentsply) & Patterson Dental Ultrasonic Cleaners

# New Parts to fit Ultrasonic Cleaners!

**RPI Part #RPT766**  
**OEM Part #32380**



**TIMER (30 MINUTE)**

- 30 minutes with hold
- 15A per pole; 120/240V; DPST
- Includes: mounting screws
- Also available: Thermostat Knob (RPI Part #TUK050)

**Fits:** 30 Minute Ultrasonic Cleaner

**Models:** Henry Schein Dental Ultrasonic Cleaners, L&R Ultrasonic Cleaners, Ney (Dentsply) Ultrasonic Cleaners & Patterson Dental Ultrasonic Cleaners

**RPI Part #RPT767**  
**OEM Part #40872**

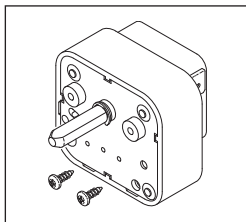

**TIMER (60 MINUTE)**

- 60 minutes without hold
- 15A per pole; 120/240V; DPST
- Includes: mounting screws
- Also available: Thermostat Knob (RPI Part #TUK050)

**Fits:** 60 Minute Ultrasonic Cleaner

**Models:** Henry Schein Dental Ultrasonic Cleaners, L&R Ultrasonic Cleaners, Ney (Dentsply) Ultrasonic Cleaners & Patterson Dental Ultrasonic Cleaners

**RPI Part #TUK050**  
**OEM Part #** (No OEM Part # Available)

**THERMOSTAT KNOB**

- Material: Black plastic
- Size: Fits .250" dia. 'D' Shaft

**Fits:** Timer

**Models:** Henry Schein Dental Ultrasonic Cleaners, L&R Ultrasonic Cleaners, Ney (Dentsply) Ultrasonic Cleaners & Patterson Dental Ultrasonic Cleaners

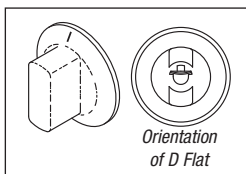

**RPI Part #RPS768**  
**OEM Part #32040**

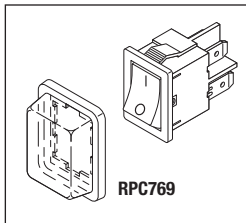

**SWITCH**

- 15A @ 250 VAC, DPDT
- Illuminated green lens; black body
- Includes: Switch Cover (RPI Part #RPC769)
- Used as a Heater Switch or a Power Switch

**Fits:** Front / Side Panel

**Models:** Henry Schein Dental Ultrasonic Cleaners, L&R Ultrasonic Cleaners, Ney (Dentsply) Ultrasonic Cleaners & Patterson Dental Ultrasonic Cleaners

**RPI Part #RPC769**  
**OEM Part #** (No OEM Part # Available)

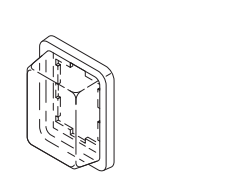

**SWITCH COVER**

- Fits .82" x .59" switch bezel
- This rubber switch cover will extend the life of the switch by preventing moisture from entering into it
- Material: Clear silicone rubber
- Also included in: Switch (RPI Part #RPS768)

**Fits:** Switch

**Models:** Henry Schein Dental Ultrasonic Cleaners, L&R Ultrasonic Cleaners, Ney (Dentsply) Ultrasonic Cleaners & Patterson Dental Ultrasonic Cleaners

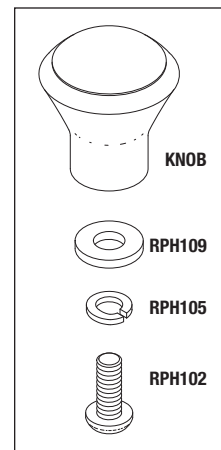

**RPI Part #RPK801**  
**OEM Part #40668**

**KNOB KIT**

- Includes all parts as shown

**Fits:** Lid Cover

**Models:** Henry Schein Dental Ultrasonic Cleaners, L&R Ultrasonic Cleaners, Ney (Dentsply) Ultrasonic Cleaners & Patterson Dental Ultrasonic Cleaners

**RPI Part #RPH109**  
**OEM Part #** (No OEM Part # Available)

**#10 FLAT WASHER**

- 25 per package
- Material: Stainless steel
- Also included in: Knob Kit (RPI Part #RPK801) and Hardware Kit (RPI Part #RPK402)

**Fits:** Lid Cover

**Models:** See Knob Kit (RPI Part #RPK801)

**RPI Part #RPH105**  
**OEM Part #** (No OEM Part # Available)

**#8 SPLIT LOCK WASHER**

- 50 per package
- Material: Stainless steel
- Also included in: Knob Kit (RPI Part #RPK801) and Hardware Kit (RPI Part #RPK402)

**Fits:** Lid Cover

**Models:** See Knob Kit (RPI Part #RPK801)

**RPI Part #RPH102**  
**OEM Part #** (No OEM Part # Available)

**SCREW (8-32 x 1/2)**

- 50 per package
- Material: Stainless steel
- Size: #8-32 x 1/2" lg.
- Also included in: Knob Kit (RPI Part #RPK801) and Hardware Kit (RPI Part #RPK402)

**Fits:** Lid Cover

**Models:** See Knob Kit (RPI Part #RPK801)

DENTAL ULTRASONIC CLEANERS

Henry Schein® Dental, L&R, Ney (Dentsply) & Patterson Dental

SECTION

4

PAGE  
1550

UPDATED  
05/12

# Dental Equipment

## Models: Henry Schein® Dental, L&R, Ney (Dentsply) & Patterson Dental Ultrasonic Cleaners

### RPI Part #RPB640

OEM Part # (No OEM Part # Available)

#### BUMPER

- 4 per package
- Material: Polyurethane
- Size: ~ 1/2" square x 15/64" H
- Self adhesive backing

Fits: Chassis

Models: Henry Schein Dental Ultrasonic Cleaners, L&R Ultrasonic Cleaners, Ney (Dentsply) Ultrasonic Cleaners & Patterson Dental Ultrasonic Cleaners

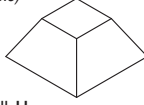

### RPI Part #RPH742

OEM Part # (No OEM Part # Available)

#### PHILLIPS PAN HEAD SCREW #6

- 25 per package
- Material: Zinc plated steel
- Size: #6 self tapping screw x 1/2" lg.

Fits: Chassis

Models: Henry Schein Dental Ultrasonic Cleaners, L&R Ultrasonic Cleaners, Ney (Dentsply) Ultrasonic Cleaners & Patterson Dental Ultrasonic Cleaners

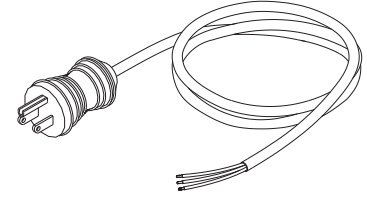
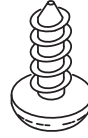

### RPI Part #RPC028

OEM Part # (No OEM Part # Available)

#### HOSPITAL GRADE POWER CORD

- 18/3 SJT, 60°C; 10A@125VAC
- Use Strain Relief Bushing (RPI Part #RPB164) when replacing power cord

Fits: Chassis

Models: Henry Schein Dental Ultrasonic Cleaners, L&R Ultrasonic Cleaners, Ney (Dentsply) Ultrasonic Cleaners & Patterson Dental Ultrasonic Cleaners

### RPI Part #RPH800

OEM Part #32409



#### FUSE HOLDER

- 3/16" quick connect / solder tabs
- Accommodates metric 5mm x 20mm fuse
- 16A @ 250VAC
- Mounting hole size: .500" dia.
- Includes: mounting hardware

Fits: Rear Panel

Models: Henry Schein Dental Ultrasonic Cleaners, L&R Ultrasonic Cleaners, Ney (Dentsply) Ultrasonic Cleaners & Patterson Dental Ultrasonic Cleaners

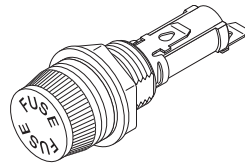

### RPI Part #RPK538

OEM Part # (No OEM Part # Available)

#### FUSE KIT (5mm x 20mm TIME DELAY)

- Most Fuses to fit the variety of Ultrasonic Cleaners on the market can be found in this Kit. Also, see our other Fuse Kits in the General Shop Aids Section of our Catalog
- Kit includes 18-compartment Storage Case (RPI Part #RPB417)
- Fuses are also sold separately in quantities indicated below

Models: Henry Schein Dental Ultrasonic Cleaners, L&R Ultrasonic Cleaners, Ney (Dentsply) Ultrasonic Cleaners & Patterson Dental Ultrasonic Cleaners

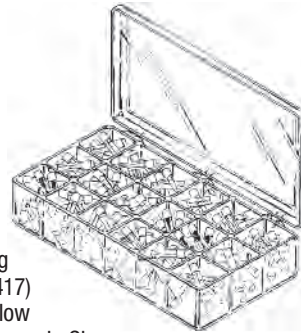

### RPI Part #RPC557

OEM Part # (No OEM Part # Available)

#### HOSPITAL GRADE POWER CORD

- 16/3 SJT, 60°C; 13A@125VAC

Fits: Power Input Module

Models: Henry Schein Dental Ultrasonic Cleaners, L&R Ultrasonic Cleaners, Ney (Dentsply) Ultrasonic Cleaners & Patterson Dental Ultrasonic Cleaners

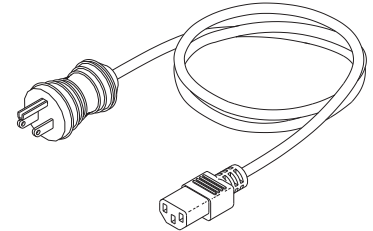

RPI PART #	OEM PART #	AMPS	VOLTS	TYPE	QTY
RPF521	No OEM Part # Available	1/32A	250V	Glass	5
RPF522	No OEM Part # Available	1/20A	250V	Glass	5
RPF523	No OEM Part # Available	1/10A	250V	Glass	5
RPF524	No OEM Part # Available	1/8A	250V	Glass	5
RPF525	No OEM Part # Available	1/5A	250V	Glass	5
RPF368	No OEM Part # Available	1/4A	250V	Glass	5
RPF526	No OEM Part # Available	2/5A	250V	Glass	5
RPF527	No OEM Part # Available	1/2A	250V	Glass	5
RPF528	No OEM Part # Available	4/5A	250V	Glass	5
RPF529	32025	1A	250V	Glass	5
RPF530	No OEM Part # Available	1-1/4A	250V	Glass	5
RPF531	32027	2A	250V	Glass	5
RPF532	32028	2-1/2A	250V	Glass	5
RPF533	No OEM Part # Available	4A	250V	Glass	5
RPF534	32030	5A	250V	Glass	5
RPF535	30125	8A	250V	Glass	5
RPF536	No OEM Part # Available	10A	250V	Glass	5
RPF537	31226	15A	250V	Glass	5

### RPI Part #RPT604

OEM Part # (No OEM Part # Available)

#### DRAIN TUBING

- 1/4" ID x 3/8" OD
- Material: Clear flexible PVC
- Sold by the foot (reel not included)
- 68 Durometer

Fits: Drain Port

Models: Henry Schein Dental Ultrasonic Cleaners, L&R Ultrasonic Cleaners, Ney (Dentsply) Ultrasonic Cleaners & Patterson Dental Ultrasonic Cleaners

