

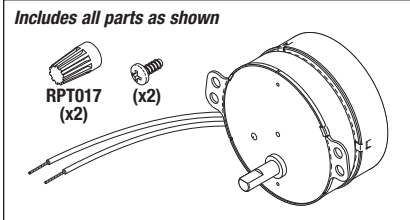

Models: 421105 Nutator, 421106 Nutator, H5500 Mini LabRoller™, S0500 GyroMini™ & S0600 Enduro™ MiniMix™

RPI Now Offers a New Line Of Parts To Fit LABORATORY NUTATORS AND ROTATORS!



RPI Part #CAM118
OEM Part #42110601/421507/NE110

MOTOR (20 RPM, 230V)

- Bi-directional operation
- Offset shaft



Fits: Motor Housing
Model: 421106 Nutator

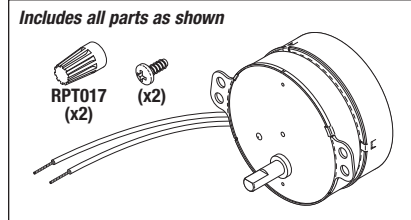

RPI Part #CAM116
OEM Part #42110501/4210504/NE100

MOTOR (24 RPM, 115V)

- Bi-directional operation
- Offset shaft



Fits: Motor Housing
Models: 421105 Nutator & S0500 GyroMini

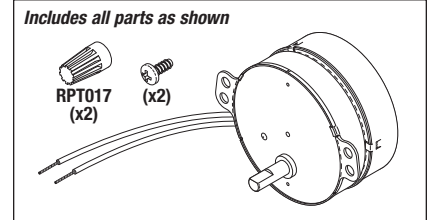

RPI Part #CAM117
OEM Part #NE111

MOTOR (18 RPM, 115V)

- Bi-directional operation
- Offset shaft



Fits: Motor Housing
Model: S0600 Enduro MiniMix

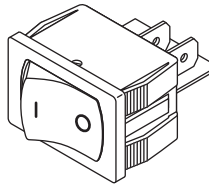

RPI Part #CAS122
OEM Part #NE210

POWER SWITCH

- Rocker switch
- 16A @ 250VAC; SPST; .187" Tabs
- Color: Black Body with white I/O marking

Fits: Chassis
Models: S0500 GyroMini, S0600 Enduro MiniMix & H5500 Mini LabRoller

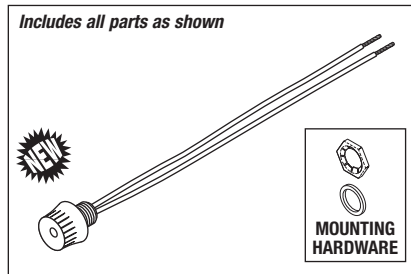

RPI Part #CAS119
OEM Part #42110502/421505

POWER SWITCH

- Rotary style: On-Off-On-Off
- 3A@125VAC; SPST; Wire length: ~6" lg.

Fits: Chassis
Model: 421105 Nutator

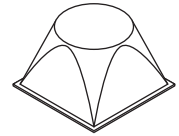

RPI Part #RPB866
OEM Part # (No OEM Part # Available)

BUMPER/FOOT

- 4 per package
- Size: .81" Square x .52" Ht.
- Material: Grey Polyurethane
- Self adhesive backing

Fits: Base
Model: 421105 Nutator

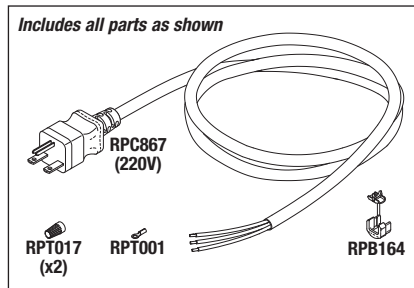

RPI Part #CAK121
OEM Part # (No OEM Part # Available)

POWER CORD KIT

- 220VAC; Length: ~8 ft.
- Also available: Strain Relief Bushing Pliers (RPI Part #RPT172)

Fits: Chassis
Model: 421106 Nutator

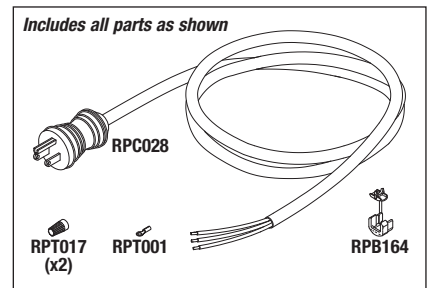

RPI Part #CAK120
OEM Part #42110503/421503

POWER CORD KIT

- 115VAC; Length: ~8 ft.
- Also available: Strain Relief Bushing Pliers (RPI Part #RPT172)

Fits: Chassis
Model: 421105 Nutator



replacement parts industries, inc.

CALL (800) 221-9723 • FAX (818) 882-7028 • EMAIL order@riparts.com • WEBSITE www.riparts.com

The above parts are manufactured by Replacement Parts Industries, Inc. to fit the equipment noted. All product names used in this document are trademarks or registered trademarks of their respective holders. SHOW 03/14



replacement parts industries, inc.

20338 Corisco Street • Chatsworth, California • 91311

PRESORTED STANDARD
U.S. POSTAGE PAID
VAN NUYS, CA
PERMIT NO. 2399

ADDRESS SERVICES REQUESTED

CALL (800) 221-9723 • FAX (818) 882-7028 • EMAIL order@rpiparts.com • WEBSITE www.rpiparts.com

RPI Mixes Things Up With Our New Line Of Parts To Fit Laboratory Nutators and Rotators!

NUTATORS

New Parts to fit Clay Adams 421105 & 421106 Nutators including:

- Motor (20 RPM, 230V)
- Motor (24 RPM, 115V)
- Power Cord Kit
- Power Switch
- Bumper/Foot

New Parts to fit Labnet International, Inc. S0500 GyroMini™ & S0600 Enduro™ MiniMix™ Nutators including:

- Motor (18 RPM, 115V)
- Motor (24 RPM, 115V)
- Power Switch

ROTATORS

New Part to fit Labnet International, Inc. H5500 Mini LabRoller™ Rotators including:

- Power Switch

