

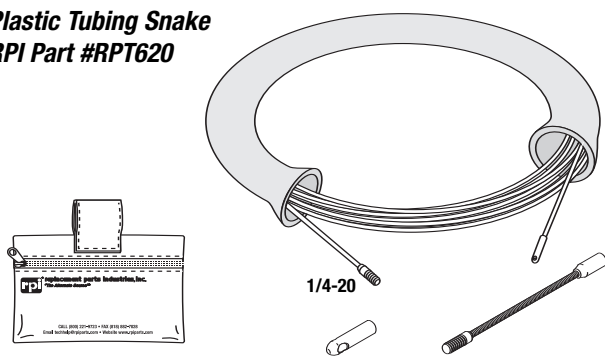

# PLASTIC & METAL TUBING SNAKES

**Plastic Tubing Snake**  
RPI Part #RPT620



Accessory Pouch (5" w x 4" h)  
RPI Part #RPP634

Bullet Tip (5/16" dia.)  
RPI Part #RPA627

Flexible Extension  
RPI Part #RPA625

**Metal Tubing Snake**  
RPI Part #RPT629

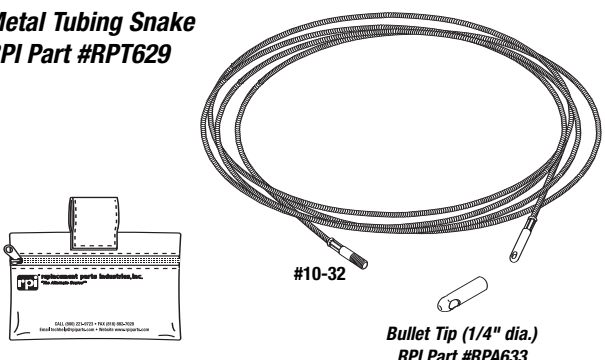

Accessory Pouch (5" w x 4" h)  
RPI Part #RPP634

Bullet Tip (1/4" dia.)  
RPI Part #RPA633

**PLASTIC TUBING SNAKE**

RPI Part #RPT620

OEM Part #: (No OEM Part # Available)

- 15' of 3/16" dia. non-conductive fiberglass rod with conduit holder
- Includes Bullet Tip (RPI Part #RPA627), Flexible Extension (RPI Part #RPA625), and Accessory Pouch (RPI Part #RPP634)
- One end has fixed 3/16" dia. brass tip with 1/8" dia. hole; Opposite end has a 1/4-20 male thread adapter for adding attachments
- Minimum bend radius: 2.5"

**METAL TUBING SNAKE**

RPI Part #RPT629

OEM Part#: (No OEM Part # Available)

- 12' of 1/8" dia. flex cable
- Includes Bullet Tip (RPI Part #RPA633), and Accessory Pouch (RPI Part #RPP634)
- One end has a fixed 3/16" dia. brass tip with 1/8" dia. hole; Opposite end has a #10-32 male thread adapter for adding attachments
- Minimum bend radius: 3/4"

**FLEXIBLE EXTENSION**

RPI Part #RPA625

- 3" long

Fits: Plastic Tubing Snake

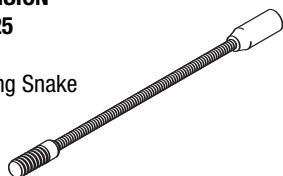

**BULLET TIP (5/16" dia.)**

RPI Part #RPA627

- 5/16" dia. body with 3/16" dia. hole

Fits: Plastic Tubing Snake

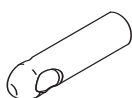

**FIBER-OPTIC PULLER (5/16" dia.)**

RPI Part #RPA623

- Includes (1) #6-32 x 3/32" lg set screw to lock fiber-optic tube in place
- 5/16" dia. bullet-shaped tip
- 1-3/8" lg.

Fits: Plastic Tubing Snake

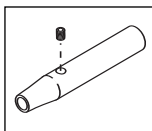

**CONNECTOR (PLASTIC SNAKE)**

RPI Part #RPA621

- Allows two Plastic Snakes to be connected for a 30' reach

Fits: Plastic Tubing Snake

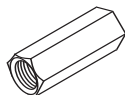

**THE ATTACHMENTS SHOWN BELOW FIT BOTH SNAKES!**

The Metal Snake requires the Adapter - RPI Part #RPA631

**HOOK ATTACHMENT**

RPI Part #RPA624

- 3-5/8" lg
- Hook: 1-1/8" wide with a .40" wide opening

Fits: Both Snakes (Metal Snake requires Adapter – RPI Part #RPA631)

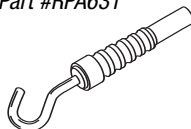

**PULLING EYE RING**

RPI Part #RPA626

- 3/4" dia. pulling ring
- 5/16" dia. body

Fits: Both Snakes (Metal Snake requires Adapter – RPI Part #RPA631)

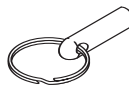

**MAGNET ATTACHMENT**

RPI Part #RPA622

- 15/32" dia. magnet tip

Fits: Both Snakes (Metal Snake requires Adapter – RPI Part #RPA631)



**ACCESSORY POUCH**

RPI Part #RPP634

- 5" w x 4" h
- 600 Denier Polyester
- Velcro® belt-loop flap

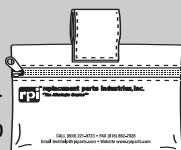

**ADAPTER**

RPI Part #RPA631

- Allows a step-up for use with Plastic Snake attachments (Hook Attachment, Pulling Eye Ring, and Magnet Attachment)

Fits: Metal Snake

1/4-20 Male



#10-32 Female

**BULLET TIP (1/4" dia.)**

RPI Part #RPA633

- 1/4" dia. body with 3/16" dia. hole

Fits: Metal Snake

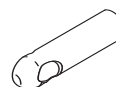

**FIBER-OPTIC PULLER (1/4" dia.)**

RPI Part #RPA630

- Includes (1) #6-32 x 3/32" lg. set screw to lock fiber-optic tube in place
- 1/4" dia. bullet-shaped tip
- 1-1/8" lg

Fits: Metal Snake

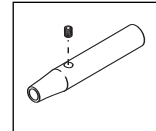

**CONNECTOR (METAL SNAKE)**

RPI Part #RPA632

- Allows two Metal Snakes to be connected for a 24' reach

Fits: Metal Snake

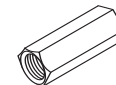

replacement parts industries, inc.

CALL (800) 221-9723 • FAX (818) 882-7028 • EMAIL [order@rpiparts.com](mailto:order@rpiparts.com) • WEBSITE [www.rpiparts.com](http://www.rpiparts.com)

All product names used in this document are trademarks or registered trademarks of their respective holders. Fiver WEB PDF 12/06

# Pull-Push Wire, Cable, Tubing, and Fiber Optic Bundles with RPI Plastic & Metal Snakes

There is a multitude of uses for RPI's newest tools that easily pull and push wire, cable, tubing, and fiber optic bundles behind walls, above ceilings, inside operatories, through crawl spaces, and under floors.

Hard-to-reach spaces in hospitals, dental and doctor offices, laboratories, x-ray rooms, central monitoring stations, or computer stations can easily be accessed with RPI's "plastic" and "metal" snakes.

What's more, both snake tools are offered with a variety of attachments that screw on to the tip of the snakes and allow you

to customize them for the requirements of each job.

The RPI Plastic Tubing Snake (RPI Part #RPT620), made of a fiberglass rod that is polypropylene coated, eliminates the chance of electric shock when working through "J" boxes.

The plastic tubing snake is more rigid than a standard metal snake, making it quicker and easier to push lines through as needed.

The snake is 15 feet long and comes with two tip attachments – a bullet tip with a

small through-hole, and a three inch flexible extension.

Other attachments available include a metal hook, a powerful magnet so strong that it can pick up tools, a pulling eye ring, and a custom designed fiber-optic bundle puller. In addition, there is a special attachment that allows two snakes to be connected for a 30 foot reach.

The snake includes a sturdy, zippered pouch for storing the attachments. The pouch has a strap with a large Velcro® strip so that you can secure it onto the PVC holder. It's the RPI advantage!

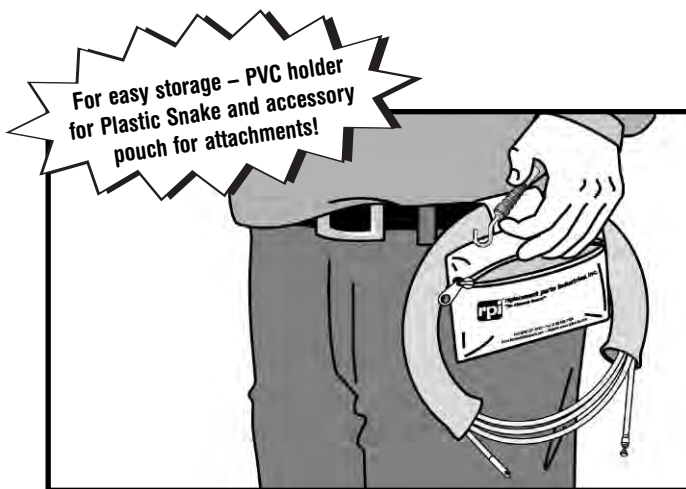

For easy storage – PVC holder for Plastic Snake and accessory pouch for attachments!

Accessory Pouch (RPI Part #RPP634)

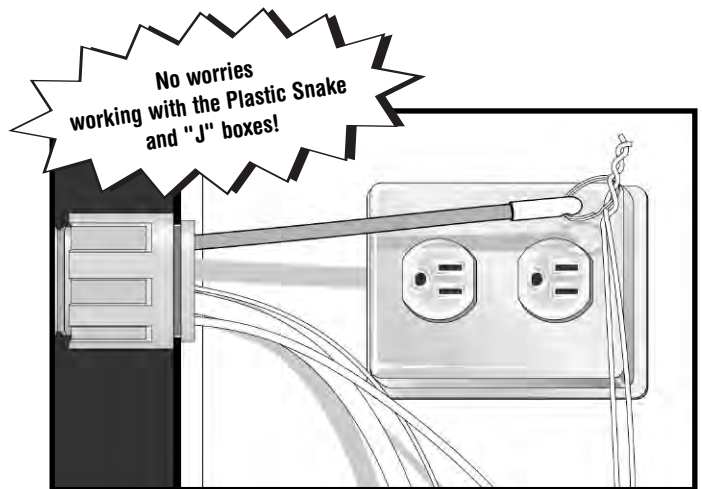

No worries working with the Plastic Snake and "J" boxes!

Plastic Tubing Snake (RPI Part #RPT620)

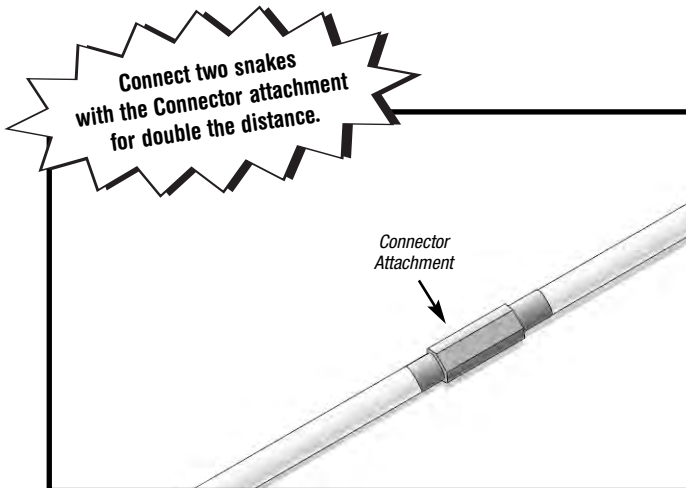

Connect two snakes with the Connector attachment for double the distance.

Plastic Snake Connector (RPI Part #RPA621)  
Metal Snake Connector (RPI Part #RPA632)

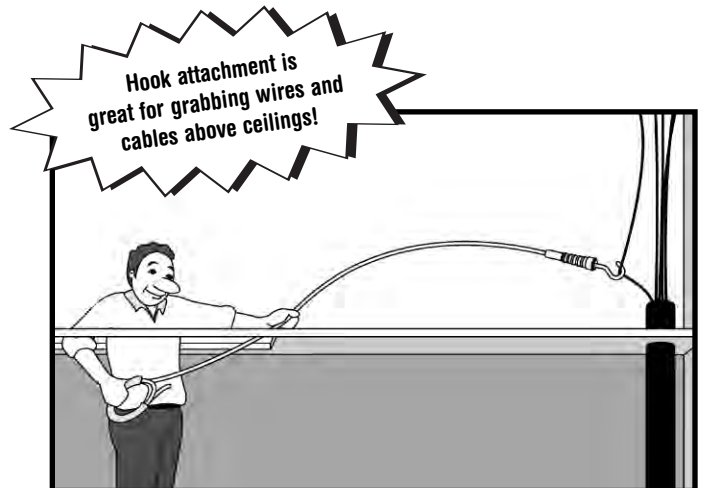

Hook attachment is great for grabbing wires and cables above ceilings!

Hook Attachment (RPI Part #RPA624)

**To order:**  
**CALL (800) 221-9723 • FAX (818) 882-7028**  
**EMAIL [order@rpiparts.com](mailto:order@rpiparts.com) • WEBSITE [www.rpiparts.com](http://www.rpiparts.com)**

The custom-designed PVC holder houses the fiberglass rod and makes it easy to access and recoil the rod. The holder also allows for the convenience of securing it with one hand while directing the rod with the other hand, or the holder can be "hooked" in a stationary position to allow for both hands to direct the rod while working. Either way, this unique holder gives you flexibility when maneuvering through tight spaces.

RPI also offers a traditional metal snake that is great to use to get around tight corners. The metal snake is also quite unique as it too is designed to allow for a

variety of attachments that easily screw on the tip of the snake.

The RPI "Metal Tubing Snake" (RPI Part #RPT629) is 12 feet long, comes in a reusable slide lock bag, and includes a screw-on bullet tip with through hole. Other attachments include a fiber-optic bundle puller, a connector that allows two snakes to reach 24 feet, as well as a step-up adapter that makes it possible for the metal snake tip to accommodate the RPI plastic snake's metal hook, magnet, and pulling eye ring attachments. The sturdy, zippered accessory pouch is also included.

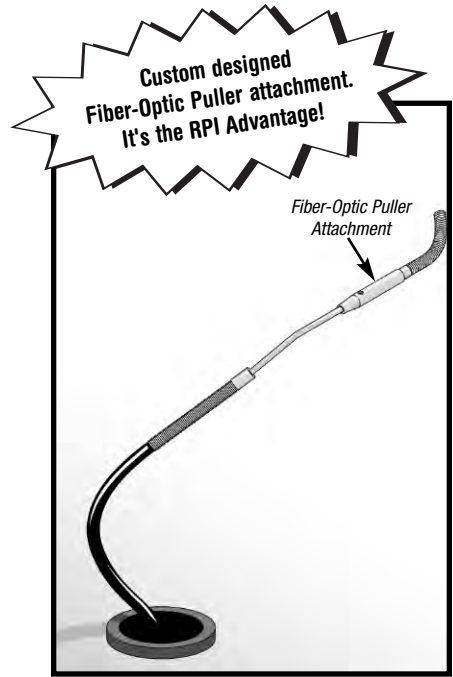

*Plastic Snake Fiber-Optic Puller (RPI Part #RPA623)  
 Metal Snake Fiber-Optic Puller (RPI Part #RPA630)*

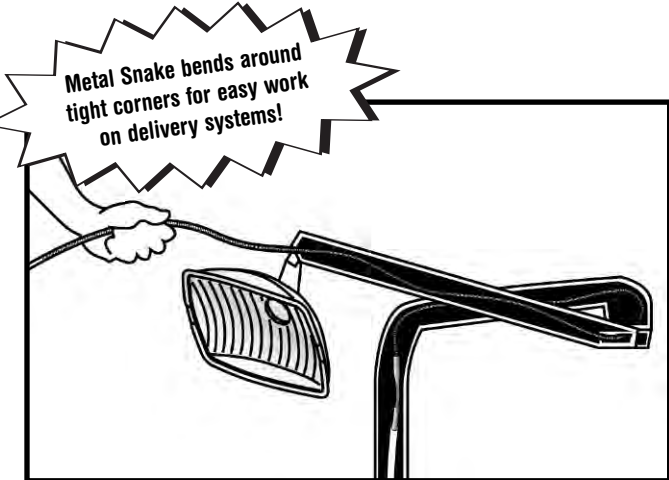

*Metal Tubing Snake (RPI Part #RPT629)*

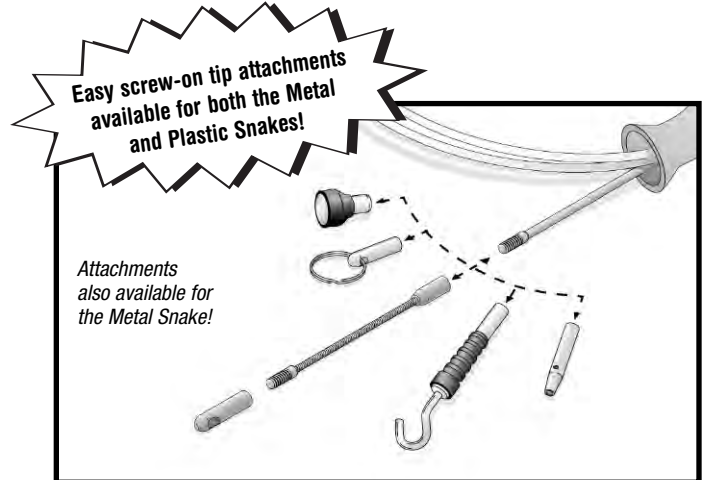

*See front page for a complete listing of the tip attachments.*

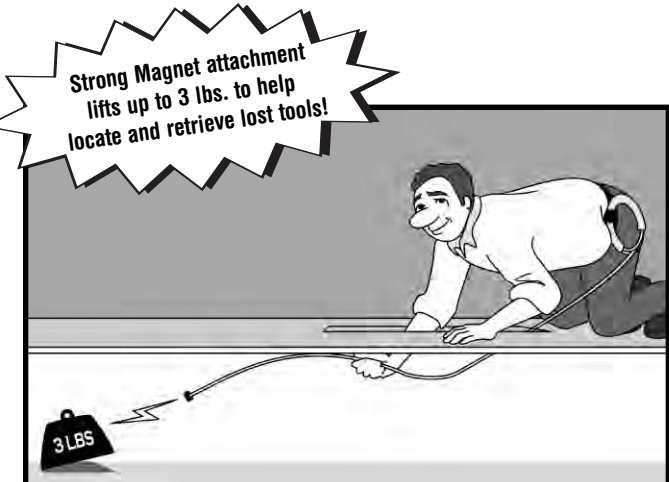

*Magnet Attachment (RPI Part #RPA622)*

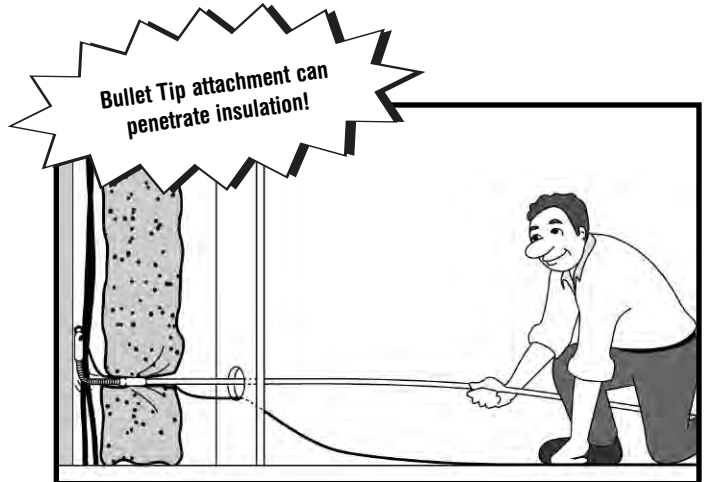

*Plastic Snake Bullet Tip (RPI Part #RPA627)  
 Metal Snake Bullet Tip (RPI Part #RPA633)*