

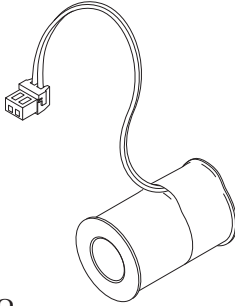

# More New Parts to Fit PELTON & CRANE SPIRIT® DELIVERY UNITS



**RPI Part #PCC777**  
**OEM Part #**  
*(No OEM Part # Available)*

**WATER SOLENOID COIL**

- Coil Rating: 12VDC; ~44Ω
- Coil: .990" L x .620" W with .363" dia. through hole
- Wire #: 24 AWG; 5-3/8" lg with JST connector

**Fits:** Drive Solenoid & Plug Assembly  
**Models:** Spirit, Spirit II, Spirit IIE & Spirit EC

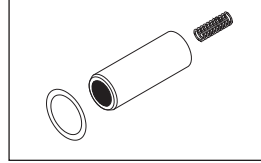

**RPI Part #PCK754**  
**OEM Part #** *(No OEM Part # Available)*

**WATER SOLENOID REPAIR KIT**

- Includes plunger body with rubber insert, spring, and O-ring (RPI Part #RPO302)

**Fits:** Drive Solenoid & Plug Assembly  
*(OEM Part #15 35 371)*

**Models:** Spirit, Spirit II, Spirit IIE & Spirit EC



**RPI Part #PCC790**  
**OEM Part #33 02 762**

**HANDPIECE BLOCK CONNECTOR**

- 8 per package
- .365" dia. x .365" lg.; Material: Brass
- Includes (2) O-rings (RPI Part #RPO305) per connector (installed)

**Fits:** High & low speed handpiece blocks  
**Models:** Spirit, Spirit II, Spirit IIE & Spirit EC

**RPI Part #PCS788**  
**OEM Part #021833**

**AIR VALVE STEM**

- 2.56" lg.; Stainless steel
- Includes O-ring (RPI Part #RPO312)
- Uses 3/32" hex key

**Fits:** High & low speed handpiece blocks  
**Models:** Spirit, Spirit II, Spirit IIE & Spirit EC

**RPI Part #PCS789**  
**OEM Part #020177**

**WATER VALVE STEM**

- 3.12" lg.; Stainless steel
- Includes O-ring (RPI Part #RPO312)

**Fits:** High & low speed handpiece blocks

**Models:** Spirit, Spirit II, Spirit IIE & Spirit EC

**RPI Part #PCS791**  
**OEM Part #94 47 897**

**WATER VALVE STEM**

- 5.60" lg.; Stainless Steel
- Includes O-ring (RPI Part #RPO312)
- Uses 1/8" hex key

**Fits:** Scaler or electronic motor assembly

**Models:** Spirit IIE & EC

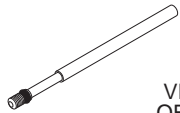

VIEW OF TIP

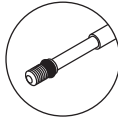

VIEW OF TIP

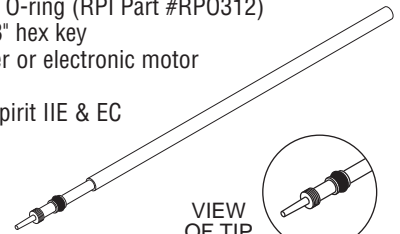
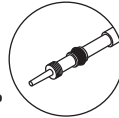

VIEW OF TIP

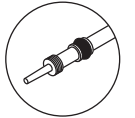

**Listing of NEW parts to fit Pelton & Crane Spirit<sup>®</sup> Delivery Units introduced since April, 2007.**  
**For more parts to fit the Spirit, see the RPI catalog or website.**

| RPI PART # | OEM PART#                        | DESCRIPTION                  | SPIRIT | SPIRIT II | SPIRIT IIE | SPIRIT AC | SPIRIT EC |
|------------|----------------------------------|------------------------------|--------|-----------|------------|-----------|-----------|
| PCC772     | 94 33 541                        | FEMALE QUICK CONNECT (1/16") |        |           |            | •         |           |
| PCC773     | 94 33 533                        | MALE QUICK CONNECT (1/16")   |        |           |            | •         |           |
| PCC777     | <i>(No OEM Part # Available)</i> | WATER SOLENOID COIL          | •      | •         | •          |           | •         |
| PCC790     | 33 02 762                        | HANDPIECE BLOCK CONNECTOR    | •      | •         | •          |           | •         |
| PCG760     | 30 04 484                        | PRESSURE GAUGE               |        |           |            | •         |           |
| PCK754     | <i>(No OEM Part # Available)</i> | WATER SOLENOID REPAIR KIT    | •      | •         | •          |           | •         |
| PCK775     | 51 51 779                        | ANTI-SIPHON VALVE KIT        |        |           |            | 1         |           |
| PCL768     | 30 03 402                        | AIR INDICATOR (GREEN)        |        |           |            | •         |           |
| PCS788     | 021833                           | AIR VALVE STEM               | •      | •         | •          |           | •         |
| PCS789     | 020177                           | WATER VALVE STEM             | •      | •         | •          |           | •         |
| PCS791     | 94 47 897                        | WATER VALVE STEM             |        |           | •          |           | •         |
| PCV765     | <i>(No OEM Part # Available)</i> | VALVE STEM                   |        |           |            | •         |           |
| PCV766     | 15 33 764                        | VALVE TOGGLE SWITCH          |        |           |            | •         |           |
| PCV767     | 18 98 902                        | CHECK VALVE                  |        |           |            | •         |           |
| PCV787     | 33 07 431                        | AUTOHOLDER VALVE             |        |           |            | •         |           |
| RPO617     | 70 32 741                        | O-RING                       |        |           |            | •         |           |

1 = Fits Spirit AC Serial #4839 and below.



**replacement parts industries, inc.**

CALL (800) 221-9723 • FAX (818) 882-7028 • EMAIL [order@rpiparts.com](mailto:order@rpiparts.com) • WEBSITE [www.rpiparts.com](http://www.rpiparts.com)

The above parts are manufactured by Replacement Parts Industries, Inc. to fit Pelton & Crane equipment. All product names used in this document are trademarks or registered trademarks of their respective holders. WEB FLYER 05/07