

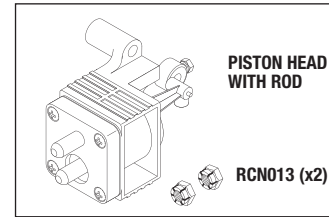

**NEW PARTS TO FIT TUTTNAUER "E" SERIES**

**TUTTNAUER**

**AIR PUMP (115VAC)**  
**RPI Part #TUP100**  
**OEM Part #02200051**  
**Models: EZ9, EZ10, 2340EA, 2540EA & 3870EA**

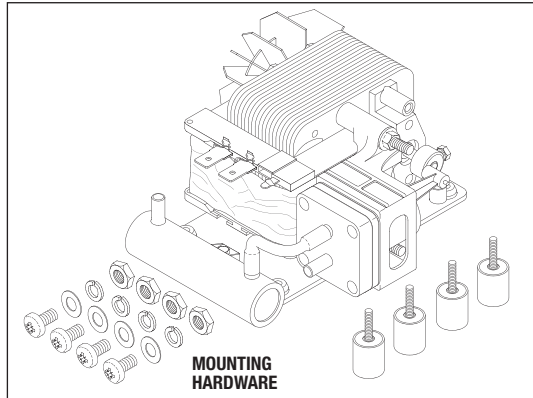

**AIR PUMP REPAIR KIT**  
**RPI Part #TUK102**  
**OEM Part # (No OEM Part # Available)**  
**Models: EZ9, EZ10, EZ10k, 2340EA/EKA, 2540EA/EKA & 3870EA**

**AIR PUMP (230VAC)**  
**RPI Part #TUP101**  
**OEM Part #02200052**  
**Models: EZ10k, 2340EA/EKA, 2540EA/EKA & 3870EA**

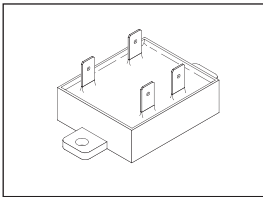

**SOLID STATE RELAY (PUMP)**  
**RPI Part #TUR105**  
**OEM Part #04400339**  
**Models: EZ9, EZ10, EZ10k, 2340EA/EK/EKA & 2540EA/EK/EKA**

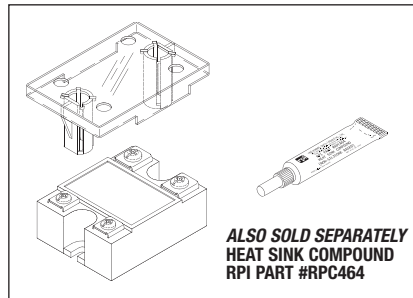

**SOLID STATE RELAY (HEATER)**  
**RPI Part #TUR104**  
**OEM Part #04400338**  
**Models: EZ9, EZ10, EZ10k, 1730E, 2340E/EA/EK/EKA & 2540E/EA/EK/EKA**

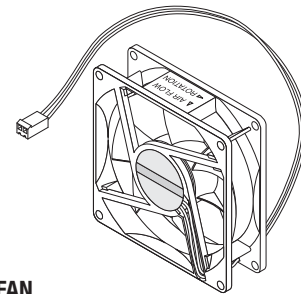

**AXIAL FAN**  
**RPI Part #TUF071**  
**OEM Part #04203801**  
**Models: EZ9, EZ10, EZ10k, 1730E/EK, 2340E/EA/EK/EKA & 2540E/EA/EK/EKA**

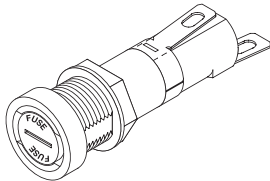

**FUSE HOLDER**  
**RPI Part #RPH659**  
**OEM Part #01910103**  
**Models: EZ9, EZ10, EZ10k, 1730E/EK, 2340E/EA/EK/EKA, 2540E/EA/EK/EKA & 3870E/EA**

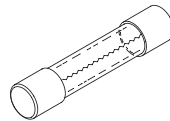

**FUSE (2A, 250V) (AIR PUMP)**  
**RPI Part #RPF047**  
**OEM Part #ELE035-0056**  
**Models: EZ9, EZ10, EZ10k, 2340EA, 2540EA & 3870EA**

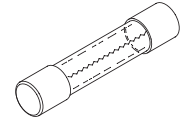

**FUSE (1-1/4A, 250V) (AIR PUMP\* and WATER PUMP\*)**  
**RPI Part #RPF073**  
**OEM Part #ELE035-0055**  
**Models: EZ9, EZ10, EZ10k, 1730E/EK, 2340E/EA/EK/EKA, 2540E/EA/EK/EKA & 3870E/EA**  
 \* Depending on Voltage

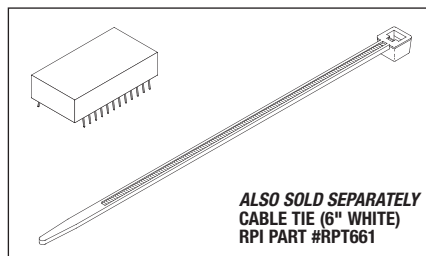

**CLOCK CHIP (WITH BATTERY)**  
**RPI Part #TUC107**  
**OEM Part #0180202**  
**Models: EZ9, EZ10, EZ10k, 1730E, 2340E/EA/EK/EKA & 2540E/EA/EK/EKA**

**FUSE (2A, 250V) (POWER SUPPLY)**  
**RPI Part #RPF367**  
**OEM Part #01910105**  
**Models: EZ9, EZ10, 1730E, 2340E/EA/EK/EKA & 2540E/EA/EKA**



**replacement parts industries, inc.**

CALL (800) 221-9723 • FAX (818) 882-7028 • EMAIL [order@riparts.com](mailto:order@riparts.com) • WEBSITE [www.riparts.com](http://www.riparts.com)

The above parts are manufactured by Replacement Parts Industries, Inc. to fit Tuttnauer equipment. All product names used in this document are trademarks or registered trademarks of their respective holders. WEB 01/08

## Introducing... Trouble-Shooting Guide for the Tuttnauer "M" Series!

The RPI Trouble-Shooting Guide for the "M" Series is a great source for:

- Preventative Maintenance Tips
- Water/Steam System Trouble-Shooting Tips
- Multi-Purpose Valve Assembly Trouble-Shooting Tips
- Electrical Trouble-Shooting Tips and Diagrams
- Detailed Exploded View
- Complete Listing of RPI Parts to fit Tuttnauer "M" Series

Download the new guide from RPI's website today!  
[www.rpiparts.com](http://www.rpiparts.com)

Click [RPI Tech Help](#). Select [Trouble-Shooting Guides and Exploded Views](#).

