

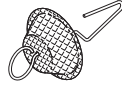

# New Parts to fit Pelton & Crane Delta Sterilizers



RPI Part #PCF233  
OEM Part #040978



**FILTER IN-LINE ASSEMBLY**



RPI Part #PCK231  
OEM Part #1539241  
(Door Gasket only)

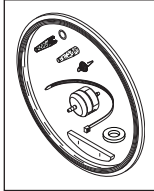

**STERILIZER PM KIT**  
• Use with 8" Chamber  
See back of flyer for more details!



RPI Part #PCK232  
OEM Part #1539407  
(Door Gasket only)

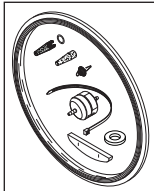

**STERILIZER PM KIT**  
• Use with 10" Chamber  
See back of flyer for more details!



RPI Part #PCL229  
OEM Part #3325052

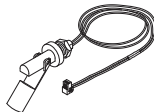

**WATER LEVEL ASSEMBLY**



RPI Part #PCP228  
OEM Part #3325086  
**PUMP (115VAC)**

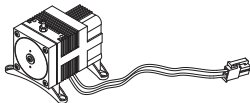

RPI Part #PCR227  
OEM Part #3339913  
**RESERVOIR (UPGRADE)**

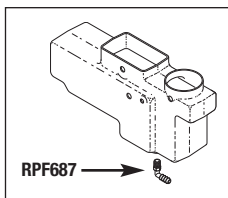

RPI Part #PCS230  
OEM Part #054544/3325094  
**SURFACE SENSOR ASSEMBLY**

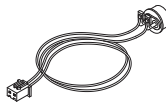

## Look to RPI for Parts to fit Pelton & Crane Delta Sterilizers

We cross-referenced parts for the Pelton & Crane Delta sterilizer against RPI parts that fit other Pelton & Crane sterilizers. The result was a great list of parts that fit the AE8, XL8, Q8, AF10, XL10 and Q10. But we didn't stop there. We also added new parts to the list. Take a look below at the chart (new parts are in **bold type**).

The new parts we added include the Water Level Assembly, Pump, Reservoir, and Surface Sensor Assembly. We also upgraded our PM Kits to include the HEPA Filter (RPI Part #RPF644) and the new Filter In-Line Assembly (RPI Part #PCF233). These upgraded kits have new part #'s – PCK231 and PCK232. Update your catalog, Section 10, page 1000, by adding these two filters to the PM Kits and replacing Part #PCK222 with PCK231 for the 8" units; and, PCK223 with PCK232 for the 10" units.

RPI PART #	OEM PART #	DESCRIPTION	AE8	XL8	Q8	AF10	XL10	Q10
ADC058	OEM # N/A	CORD CLIP	•	•	•	•	•	•
AMV097	4205055	SAFETY RELIEF VALVE	•	•	•	•	•	•
ILS014	026169	SPANNER NUT	•	•	•	•	•	•
PCC176	1881106	CONDENSATION COIL W/FITTING	•	•	•	•	•	•
PCF009	1881031	FILTER - FILL LINE	•	•	•	•	•	•
PCF179	1539308	RUBBER FOOT ASSEMBLY	•	•	•	•	•	•
PCF180	1881122	FRONT LEVELING FOOT	•	•	•	•	•	•
<b>PCF233</b>	040978	FILTER IN-LINE ASSEMBLY	•	•	•	•	•	•
PCG065	1539241	DOOR GASKET (8")	•	•	•			
PCG066	1539407	DOOR GASKET (10")				•	•	•
PCH096	019769	HEATER & PLUG ASSEMBLY				<b>1</b>	•	•
PCK167	9432311	RESERVOIR FILTER KIT	•	•	•	•	•	•
PCK171	1539449	COUPLING-VENT/CONDENSOR KIT	•	•	•	•	•	•
PCK202	<b>(2)</b>	FILL/VENT PLUNGER KIT	•	•	•	•	•	•
PCK203	<b>(3)</b>	DUMP PLUNGER KIT	•	•	•	•	•	•
PCK204	<b>(4)</b>	BELLOWS PLUNGER KIT	•	•	•	•	•	•
PCK225	004439	FILTER & TUBE KIT	•	•	•	•	•	•
<b>PCK231</b>	1539241	STERILIZER PM KIT (8")	•	•	•			
<b>PCK232</b>	1539407	STERILIZER PM KIT (10")				•	•	•
<b>PCL229</b>	3325052	WATER LEVEL ASSEMBLY	•	•	•	•	•	•
PCN136	004076	SPEEDNUT	•	•	•	•	•	•
PCP200	1539514	INSULATION PAD	•	•	•	•	•	•
PCP201	1539720	INSULATION PAD				•	•	•
<b>PCP228</b>	3325086	PUMP (115VAC)	•	•	•	•	•	•
<b>PCR227</b>	3339913	RESERVOIR (UPGRADE)	•	•	•	•	•	•
PCS067	3322281	SPACER (DOOR)	•	•	•	•	•	•
PCS170	1539936	BLACK COVER SCREW	•	•	•	•	•	•
<b>PCS230</b>	<b>(5)</b>	SURFACE SENSOR ASSEMBLY	•	•	•	•	•	•
PCT010	1881023	FILL CHAMBER TUBE	•	•	•	•	•	•
PCT142	1539357	INSTRUMENT TRAY (SM)				•	•	•
PCT143	<b>(6)</b>	INSTRUMENT TRAY (LG)				•	•	•
PCT192	1521512	OVERHEAT THERMOSTAT	•	•	•	•	•	•
PCW177	1539563	MANIFOLD WASHER	•	•	•	•	•	•
RPB365	7740640	STRAIN RELIEF <b>(7)</b>	•	•	•	•	•	•
RPC288	1530661	POWER CORD	•	•	•	•	•	•
RPC463	044176	KWIK™ CLAMP (6/PKG)	•	•	•	•	•	•
RPF426	1522494	FEMALE QC FITTING (GRY)	•	•	•	•	•	•
RPF427	1522502	MALE QC FITTING (GRY)	•	•	•	•	•	•
RPF644	4197146	HEPA FILTER	•	•	•	•	•	•
<b>RPF687</b>	1539381	ELBOW FITTING (3/8 BARB)	•	•	•	•	•	•
RPH285	1522510	DRAIN HOSE <b>(9)</b>	•	•	•	•	•	•
RPI268	OEM # N/A	CHAMBER INSULATION	•	•	•			
RPI269	OEM # N/A	CHAMBER INSULATION				•	•	•
RPK431	4193376	DRAIN TUBE ASSEMBLY KIT	•	•	•	•	•	•
RPM542	OEM # N/A	CABLE TIE MOUNT (4-WAY)	•	•	•	•	•	•
RPO343	9435546	O-RING (12/PKG)	•	•	•	•	•	•
RPO358	1881072	O-RING (6/PKG)	•	•	•	•	•	•
RPT462	9448598	TUBING (SILBRAD®) <b>(8&amp;9)</b>	•	•	•	•	•	•
SCF002	OEM # N/A	COMPRESSOR FILTER	•	•	•	•	•	•

1 = Fits Serial #'s 006000 and above 2 = OEM Part #'s 5151787/9442922-V 3 = OEM Part #'s 5151803/9442930-V 4 = OEM Part #'s 5151795/9442948-V 5 = OEM Part #'s 054544/3325094 6 = OEM Part #'s 1539340/044159 7 = RPI is same fit and function as OEM, but does not look like the OEM's. 8 = Use with HEPA Filter (RPI Part #RPF644); 9 Sold by the foot.

# Introducing Two New Sterilizer PM Kits to fit Pelton & Crane Delta Sterilizers! And Look Inside for Even More New Parts!

**RPI Part #PCK231**  
**OEM Part #1539241 (Door Gasket only)**

**STERILIZER PM KIT**

- Use with 8" Chamber
- Includes:
  - Compressor Filter (RPI Part #SCF002)
  - Door Gasket (RPI Part #PCG065)
  - Spacer (Door) (RPI Part #PCS067)
  - Reservoir Filter Kit (RPI Part #PCK167)
  - HEPA Filter (RPI Part #RPF644)
  - Filter - Fill Line (RPI Part #PCF009)
  - Filter In-Line Assembly (RPI Part #PCF233)
  - Installation Check List

**Model:** Delta models AE8, XL8 & Q8

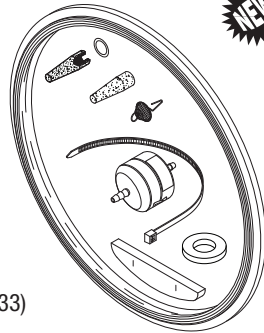

**RPI Part #PCK232**  
**OEM Part #1539407 (Door Gasket only)**

**STERILIZER PM KIT**

- Use with 10" Chamber
- Includes:
  - Compressor Filter (RPI Part #SCF002)
  - Door Gasket (RPI Part #PCG066)
  - Spacer (Door) (RPI Part #PCS067)
  - Reservoir Filter Kit (RPI Part #PCK167)
  - HEPA Filter (RPI Part #RPF644)
  - Filter - Fill Line (RPI Part #PCF009)
  - Filter In-Line Assembly (RPI Part #PCF233)
  - Installation Check List

**Model:** Delta models AF10, XL10 & Q10

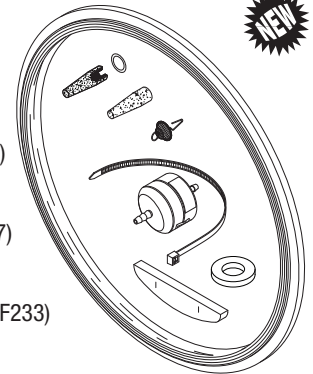

**replacement parts industries, inc.**

P.O. Box 5019 • Chatsworth, California • 91313-5019

PRESORTED STANDARD  
U.S. POSTAGE PAID  
VAN NUYS, CA  
PERMIT #2399

• Address Service Requested •

— An ISO 9001 Certified Company —



**New Parts to fit Pelton & Crane Delta Sterilizers  
In Stock and Ready to Ship!**

