



## New parts to fit Chattanooga Hydrocollators!

**RPI Part #CHH015**  
**OEM Part #22267**



**HEATING ELEMENT**

- 1500W, 120VAC, ~10 Ω
- Includes all parts as shown
- Also available: Bracket (Element Support) (RPI Part #CHB017)

**Fits:** Tank  
**Model:** M4

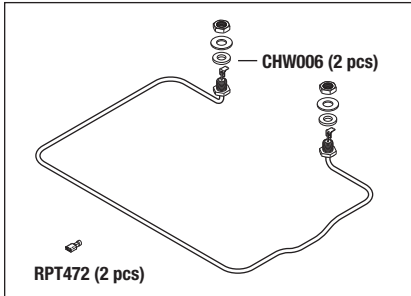

**RPI Part #CHH001**  
**OEM Part #10630**

**HEATING ELEMENT ASSEMBLY**

- 1000W, 120VAC, ~14.5 Ω
- Includes all parts as shown

**Fits:** Tank  
**Models:** E1, E2, M2, SS & SS2

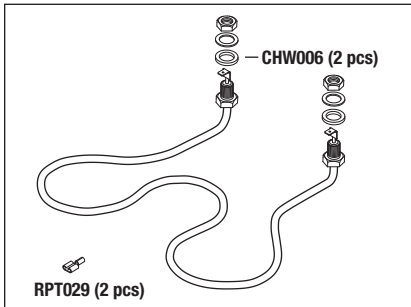

**RPI Part #CHH002**  
**OEM Part #21298**

**HEATING ELEMENT ASSEMBLY**

- 500W, 120VAC, ~30 Ω
- Includes all parts as shown

**Fits:** Tank  
**Model:** D3

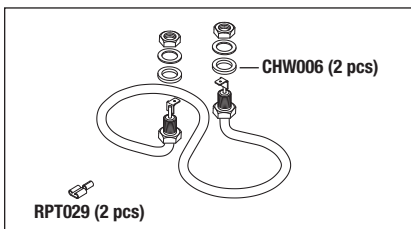

**RPI Part #CHT014**  
**OEM Part #20548**



**OVERHEAT THERMOSTAT**

- Manually resettable, Opens at 190°F (88°C)
- 10A @ 120VAC; 5A @ 240VAC
- Capillary ~ 24" lg. with soldered fitting
- Includes all parts as shown
- Also available: Bracket (Bulb Support) (RPI Part #CHB018)

**Fits:** Tank  
**Model:** M4

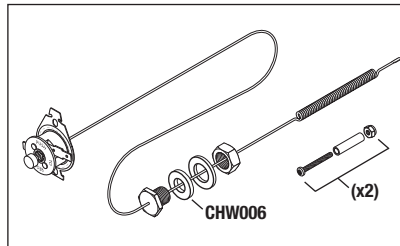

**RPI Part #CHB017**  
**OEM Part #22356**



**BRACKET (ELEMENT SUPPORT)**

- 2 per package
- Material: Stainless steel
- Includes all parts as shown

**Fits:** Heating Element  
**Model:** M4

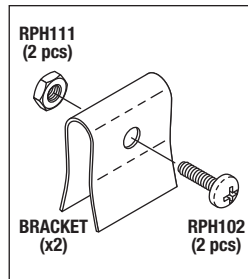

**RPI Part #CHB018**  
**OEM Part #21023**



**BRACKET (BULB SUPPORT)**

- Material: Stainless steel
- **Fits:** Attaches the Thermostat and Overheat Thermostat Capillary Bulbs to the Heating Element

**Models:** D3, E1, E2, M2, M4, SS & SS2

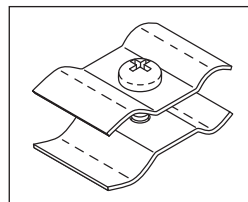

**RPI Part #CHW006**

**OEM Part #** (No OEM Part # Available)



**SEALING WASHER**

- 3 per package
- Size: .445" ID X .882" OD X .125" thk.
- Material: Red silicone
- **Fits:** Thermostat and Heater Bushing

**Models:** D3, E1, E2, M2, M4, SS & SS2

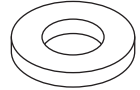

**RPI Part #CHT003**  
**OEM Part #10631**

**THERMOSTAT**

- Off at 140°F - 170°F
- 20A @ 120/240VAC
- Includes all parts as shown
- Also available: Bracket (Bulb Support) (RPI Part #CHB018)

**Fits:** Mounts to Chassis and Tank  
**Models:** D3, E1, E2, M2, M4, SS & SS2

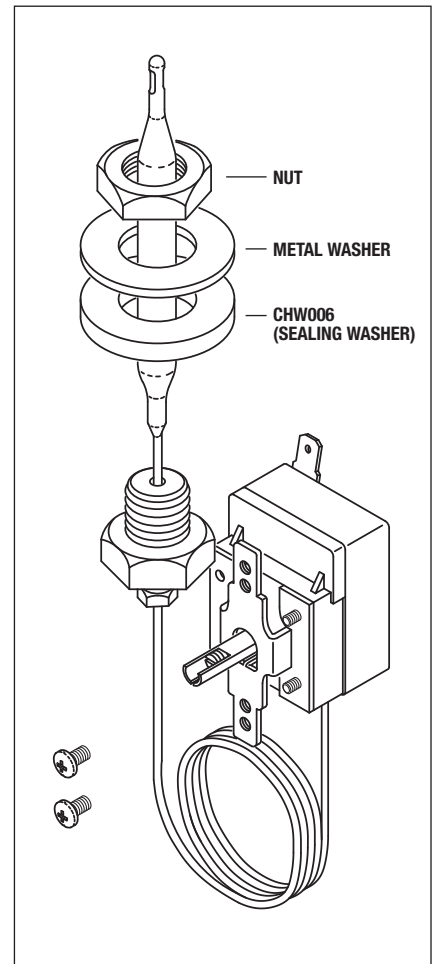

**replacement parts industries, inc.**

CALL (800) 221-9723 • FAX (818) 882-7028 • EMAIL [order@rpiparts.com](mailto:order@rpiparts.com) • WEBSITE [www.rpiparts.com](http://www.rpiparts.com)

The above parts are manufactured by Replacement Parts Industries, Inc. to fit Chattanooga equipment. All product names used in this document are trademarks or registered trademarks of their respective holders. Show 10/12

# Orthopedics & Physical Therapy

Models: D3, E1, E2, M2, M4, SS & SS2



**RPI Part #CHS004**  
**OEM Part #23406**

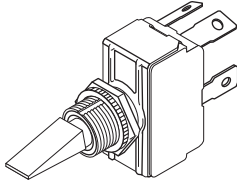

**POWER SWITCH**

- 20A @ 250VAC; DPST
- Switch (On-Off)
- .250" Tabs
- Includes: Mounting hardware

**Fits:** Chassis

**Models:** E1, E2, M2, M4, SS & SS2

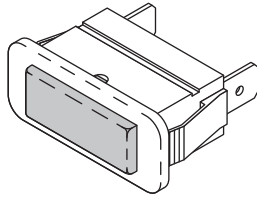

**RPI Part #CHL011**  
**OEM Part #22149**

**PILOT LIGHT (RED)**

- 1/3W @ 125VAC
- .250" Tabs
- Red lens with white body

**Fits:** Chassis

**Model:** M4

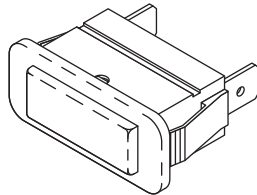

**RPI Part #CHL012**  
**OEM Part #22148 (New Style)**

**PILOT LIGHT (CLEAR)**

- New Style: .250" Tabs and 1.181" x .433" cut out
- 1/3W @ 125VAC
- Clear lens with white body

**Fits:** Chassis

**Models:** E1, E2, M2 & M4

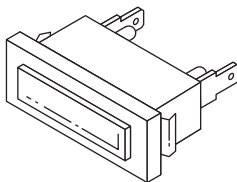

**RPI Part #CHL005**  
**OEM Part #22148 (Old Style)**

**STANDARD LIGHT**

- Old Style: .188" Tabs and 1.281" x .395" cut out
- 1/3W @ 125VAC
- Clear lens with metal bezel

**Fits:** Chassis

**Models:** E1, E2, M2, M4, SS & SS2

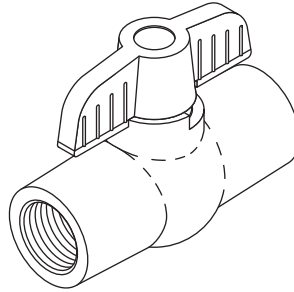

**RPI Part #CHV009**  
**OEM Part #21085**

**DRAIN VALVE (1/2")**

- Material: PVC
- Size: 1/2" FPT Inlet and Outlet
- Also available: Coupler (RPI Part #RPC810)

**Fits:** Drain Pipe

**Models:** M2, M4 & SS2

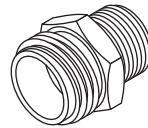

**RPI Part #RPC810**  
**OEM Part #23392**

**COUPLER**

- Material: Brass
- Size: 1/2" MPT x 3/4" male garden hose thread
- Also available: Drain Valve (1/2") (RPI Part #CHV009)

**Fits:** Drain Valve

**Models:** M2, M4 & SS2

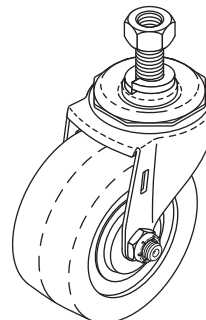

**RPI Part #CHC010**  
**OEM Part #21260**

**CASTER (3")**

- 3" dia. x 1-1/4" wide tread
- Load Capacity: 125 lbs.
- Non-marking soft rubber tread
- 7/16-14 X 7/8" Lg. threaded stem mount
- Height: 3-5/8"; Without brake
- Zinc plated steel, ball bearing swivel
- Includes: Mounting hardware

**Fits:** Chassis Base

**Model:** M4

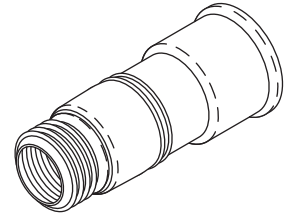

**RPI Part #RPA724**  
**OEM Part #21882**

**WATER THIEF**

- Connects a garden hose to a threadless faucet
- Also available: Washer (Hose Bib) (RPI Part #RPH756) & Drain Hose (RPI Part #CHH016)

**Fits:** Drain Hose

**Models:** E2, M2, M4, SS & SS2

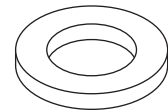

**RPI Part #RPH756**  
**OEM Part #**

**WASHER (HOSE BIB)**

- 10 per package
- Material: Red rubber
- Fits any standard garden hose thread
- Also available: Drain Hose (RPI Part #CHH016) & Water Thief (RPI Part #RPA724)

**Fits:** Drain Hose

**Models:** E2, M2, M4, SS & SS2

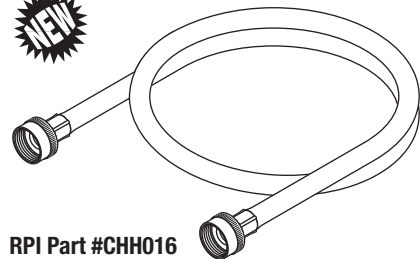

**RPI Part #CHH016**  
**OEM Part #21635**

**DRAIN HOSE**

- Material: Black rubber
- Length: 4 ft
- Fitting Size: 3/4" female garden hose thread
- Includes: (2 pcs) Washer (Hose Bib) (RPI Part #RPH756)
- Also available: Water Thief (RPI Part #RPA724)

**Fits:** Coupler

**Models:** E2, M2, M4, SS & SS2

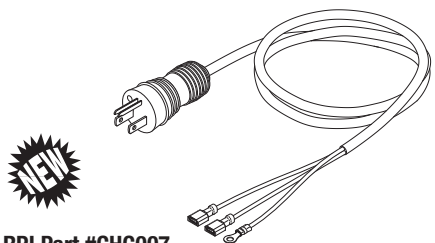

**RPI Part #CHC007**  
**OEM Part #20568**

**HOSPITAL GRADE POWER CORD**

- Length: 8 ft.
- Splash resistant
- 14/3 SJTOW, 105°C; 15A @ 125VAC
- Plug: NEMA 5-15P; Connector: (1) #10 Ring Terminal & (2) 1/4" QC Terminals
- Color: Black; .328" OD
- Also available: Strain Relief (RPI Part #RPB164)

**Fits:** Chassis

**Model:** M4

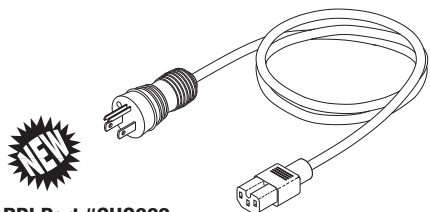

**RPI Part #CHC008**  
**OEM Part #20909**

**HOSPITAL GRADE POWER CORD**

- Length: 8 ft.
- Splash resistant
- Black, 14/3 SJTOW, 105°C; 15A @ 125VAC
- Plug Type: NEMA 5-15P
- Connector Type: EN60320-C15 (Keyed mating feature)
- Also available: AC Inlet Receptacle (RPI Part #RPR710)

**Fits:** AC Inlet Receptacle

**Model:** M4

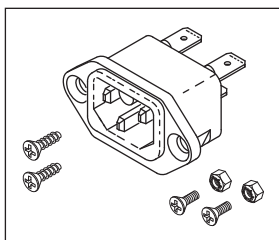

**RPI Part #RPR710**  
**OEM Part #20908**

**AC INLET RECEPTACLE**

- 15A @ 125VAC
- .250" Tabs
- Keyed Mating feature
- Includes all parts as shown

**Fits:** Chassis

**Model:** M4

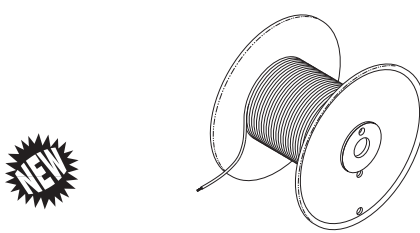

**RPI Part #RPW803**

**OEM Part #21031 (Harness Complete), 61579**  
**(Harness Complete) & 21617 (Harness Complete)**

**HOOK UP WIRE (BROWN)**

- Sold by the foot (Reel NOT included); Color: Brown
- #14 AWG, 41/30 strand, UL3173
- Voltage Rating: 600V
- Insulation: Polyolefin
- Max. Operating Temperature: 257°F (125°C)

**Models:** E1, E2, M2, M4, SS & SS2

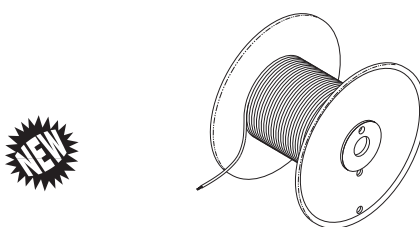

**RPI Part #RPW804**

**OEM Part #21031 (Harness Complete), 61579**  
**(Harness Complete) & 21617 (Harness Complete)**

**HOOK UP WIRE (BLUE)**

- Sold by the foot (Reel NOT included); Color: Blue
- #14 AWG, 41/30 strand, UL3173
- Voltage Rating: 600V
- Insulation: Polyolefin
- Max. Operating Temperature: 257°F (125°C)

**Models:** E1, E2, M2, M4, SS & SS2

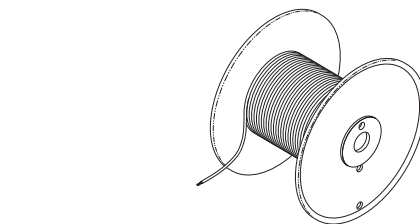

**RPI Part #RPW382**

**OEM Part #21031 (Harness Complete), 61579**  
**(Harness Complete) & 21617 (Harness Complete)**

**HOOK UP WIRE (BLACK)**

- Sold by the foot (Reel NOT included); Color: Black
- #14 AWG, 41/30 strand, UL3173
- Voltage Rating: 600V
- Insulation: Polyolefin
- Max. Operating Temperature: 257°F (125°C)

**Models:** E1, E2, M2, M4, SS & SS2

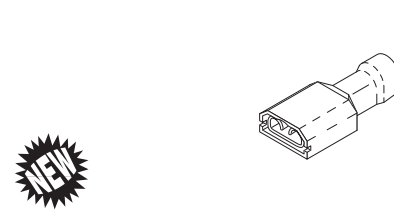

**RPI Part #RPT472**

**OEM Part #21031 (Harness Complete), 61579**  
**(Harness Complete) & 21617 (Harness Complete)**

**QC TERMINAL (1/4 FEMALE)**

- 20 per package
- Fully Insulated; Color: Blue
- Size: For #14 - 16 AWG Wire

**Models:** E1, E2, M2, M4, SS & SS2

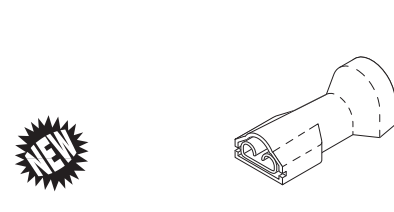

**RPI Part #RPT802**

**OEM Part #21031 (Harness Complete), 61579**  
**(Harness Complete) & 21617 (Harness Complete)**

**QC TERMINAL (1/4 FEMALE)**

- 20 per package
- Fully Insulated; Color: Yellow
- For #10-12 AWG Wire

**Models:** E1, E2, M2, M4, SS & SS2

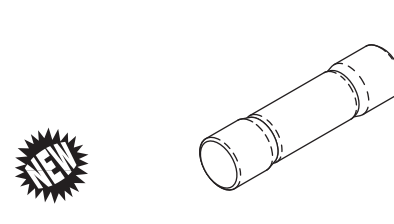

**RPI Part #RPF764**

**OEM Part #20906**

**FUSE (15A) - FAST ACTING**

- 1 per package
- 15A @ 600VAC
- Size: 13/32" dia. x 1-1/2" lg.

**Fits:** Fuse Holder

**Model:** M4



**replacement parts industries, inc.**

20338 Corisco Street • Chatsworth, California • 91311

PRESORTED STANDARD  
U.S. POSTAGE PAID  
VAN NUYS, CA  
PERMIT NO. 2399

ADDRESS SERVICES REQUESTED

**New Parts to fit  
Chattanooga  
Hydrocollators!**

## List of RPI parts to fit Chattanooga Hydrocollators

RPI PART #	OEM PART #	DESCRIPTION	MODELS						
			D3	E1	E2	M2	M4	SS	SS2
CHB017	22356	Bracket (Element Support) - 2/Pkg					•		
CHB018	21023	Bracket (Bulb Support)	•	•	•	•	•	•	•
CHC007	20568	Hospital Grade Power Cord					•		
CHC008	20909	Hospital Grade Power Cord					•		
CHC010	21260	Caster (3")					•		
CHH001	10630	Heating Element Assembly		•	•	•		•	•
CHH002	21298	Heating Element Assembly	•						
CHH015	22267	Heating Element					•		
CHH016	21635	Drain Hose			•	•	•	•	•
CHL005	22148 (Old Style)	Standard Light		•	•	•	•	•	•
CHL011	22149	Pilot Light (Red)					•		
CHL012	22148 (New Style)	Pilot Light (Clear)		•	•	•	•*	•	•
CHS004	23406	Power Switch		•	•	•	•	•	•
CHT003	10631	Thermostat	•	•	•	•	•	•	•
CHT014	20548	Overheat Thermostat					•		
CHV009	21085	Drain Valve (1/2")				•	•		•
CHW006	No OEM Part # Available	Sealing Washer - 3/Pkg	•	•	•	•	•	•	•
RPA724	21882	Water Thief			•	•	•	•	•
RPC810	23392	Coupler				•	•		•
RPF764	20906	Fuse (15A) - Fast Acting					•		
RPH756	No OEM Part # Available	Washer (Hose Bib) - 10/Pkg			•	•	•	•	•
RPR710	20908	AC Inlet Recepticle					•		
RPT472	21031 (Harness Complete) 21617 (Harness Complete) 61579 (Harness Complete)	QC Terminal (1/4 Female) - 20/Pkg		•	•	•	•	•	•
RPT802	21031 (Harness Complete) 21617 (Harness Complete) 61579 (Harness Complete)	QC Terminal (1/4 Female) - 20/Pkg		•	•	•	•	•	•
RPW382	21031 (Harness Complete) 21617 (Harness Complete) 61579 (Harness Complete)	Hook Up Wire (Black) - Sold by the Foot		•	•	•	•	•	•
RPW803	21031 (Harness Complete) 21617 (Harness Complete) 61579 (Harness Complete)	Hook Up Wire (Brown) - Sold by the Foot		•	•	•	•	•	•
RPW804	21031 (Harness Complete) 21617 (Harness Complete) 61579 (Harness Complete)	Hook Up Wire (Blue) - Sold by the Foot		•	•	•	•	•	•

\* Fits M4 Serial #5840 to present

CALL (800) 221-9723 • FAX (818) 882-7028 • EMAIL [order@rpiparts.com](mailto:order@rpiparts.com) • WEBSITE [www.rpiparts.com](http://www.rpiparts.com)