

RPI is Your Best Source for Dental Compressor Air Intake Filters

to fit

Air Techniques

Apollo/Midmark®

DentalEZ®/Custom Air/RamVac

Jun-Air

Matrx/Midmark®

MDT McKesson

Midmark®

Tech West Turbine Ind.

For more information about the parts listed in this flyer, see our website www.rpiparts.com

INTAKE FILTER (AIR)

RPI Part #CME074
OEM Part #JA5412500 (Jun-Air)

INTAKE FILTER ELEMENT

- Sold 1 per package (See **NOTES** below for quantity required for each model)
- 1.36" OD x 3.28" H
- 5 micron paper filter with rubber end caps

NOTES: *Jun-Air:* CA-812 & CA-822 require 1 Intake Filter; CA-825, CA-825Q & CA-825D requires 2 Intake Filters; CA-827D requires 4 Intake Filters; & CA-8212T requires 6 Intake Filters

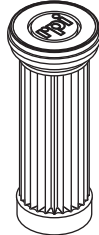

RPI Part #CMK065
OEM Part #89938 & 89831 (Air Techniques)

AIR FILTER ELEMENT KIT

- Sold 1 per package (See **NOTES** below for quantity required for each model)
- 1.25" OD x 3.74" H
- 10 micron paper filter

NOTES: *Air Techniques:* AirStar® 1, 10 & 10C require 1 air filter each; AirStar® 2-1, 2-2, 21, 21C, 22, 22C, 3, 30 & 30C require 2 air filters each; AirStar® 5, 50 & 50C require 4 air filters each; & AirStar® 7 & 70 require 5 air filters each

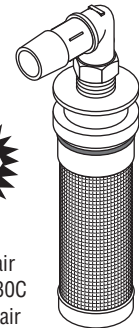

1/4" MPT

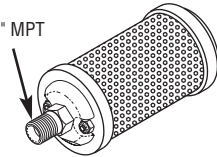

RPI Part #CMF002
OEM Part #80050 (Air Techniques)
& **PFM50955 (Apollo/Midmark®)**

AIR INTAKE FILTER (METAL STYLE)

- Auto Muffler MO2

RPI Part #CMF014
OEM Part #3-08-0632-10 (MDT McKesson)

FOAM ELEMENT

- Size: 2-1/2" dia. x 4-1/2" long

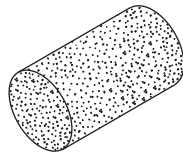

RPI Part #CMF011
OEM Part #60043-1 (Air Techniques)

FOAM ELEMENT

- Size: 4-1/4" diameter x 2" long

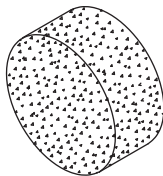

RPI Part #CMF013
OEM Part #77007079 (Matrx/Midmark®) & AAF-100 (Tech West Turbine Ind.)

FOAM ELEMENT

- Size: 2" diameter x 2" long

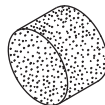

RPI Part #CMF075
OEM Part #JA5412400 (Jun-Air)

INTAKE FILTER

- 5 micron polyester filter

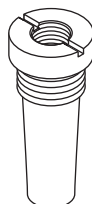

RPI Part #CMA068
OEM Part #TAF-100 (Tech West Turbine Ind.)

AIR FILTER ASSEMBLY

- Includes Air Filter Element (RPI Part #CME067)

Fits: 1 HP Compressor Head

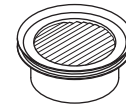
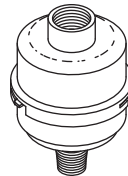

RPI Part #CME067
OEM Part #003965 (DentalEZ®/ Custom Air/ RamVac) & TIF-100 (Tech West Turbine Ind.)

AIR FILTER ELEMENT

- 2 micron paper filter

Fits: Air Filter Assembly

RPI Part #CMA070
OEM Part #TAF-200 (Tech West Turbine Ind.)

AIR FILTER ASSEMBLY

- Includes Air Filter Element (RPI Part #CME069)

Fits: 2 HP Compressor Head

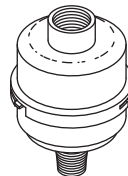

RPI Part #CME069
OEM Part #TIF-200 (Tech West Turbine Ind.)

AIR FILTER ELEMENT

- 2 micron paper filter

Fits: Air Filter Assembly

RPI Part #CMA072
OEM Part #004006 (DentalEZ®/ Custom Air/ RamVac)

AIR FILTER ASSEMBLY

- Includes Air Filter Element (RPI Part #CME080)

Fits: 1 HP Compressor Head

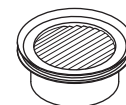
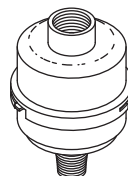

RPI Part #CME080
OEM Part #003965 (DentalEZ®/ Custom Air/ RamVac)

AIR FILTER ELEMENT

- 25 micron polyester filter

Fits: Air Filter Assembly

Air Techniques, Apollo/Midmark®, DentalEZ®/Custom Air/RamVac, Jun-Air, Matrx/Midmark®, MDT McKesson, Midmark®, & Tech West/Turbine Industries

SECTION

4

PAGE

414

UPDATED

01/11



INTAKE FILTER (FRESH AIR)

RPI Part #CME071
OEM Part #77001541 (Matrix/Midmark®)

AIR FILTER ELEMENT

- Sold 1 per package (See NOTES below for quantity required for each model)
- Used for Fresh Air intake
- Includes Rubber Air Filter Cap

Fits: Compressor heads

NOTES: **Matrix:** OL-2000 & OL2001 requires (2), OL4000 requires (4) & OL-6000 requires (6)

Midmark: P52 requires (4) & P72 requires (6)

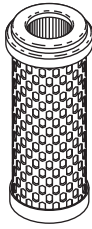

RPI Part #CMF073
OEM Part #JA5413210 (Jun-Air)

AIR INTAKE FILTER

- Sold 1 per package (See NOTES below for quantity required for each model)

- 5 micron polyester filter
- 1.58" OD x 2.39 H plastic housing
- Includes: 10.50" of .38" OD clear tubing

Fits: Compressor Head Assembly

NOTES: **DentalEz / Custom Air / RamVac:** CA-711 & CA721 require (1), CA-713 & CA-723 requires (2) and CA-725 requires (4)

Jun-Air: CA-711 & CA721 require (1), CA-713 & CA-723 requires (2) and CA-725 requires (4)

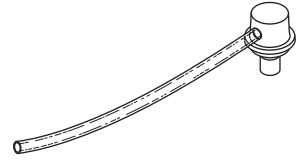

RPI Part #CMK003
OEM Part #PFM50955 (Apollo/Midmark®)
& ACP90505 (Midmark®)

FRESH AIR INTAKE FILTER KIT

- Includes filter housing, (2) Uniclamp (RPI Part #RPC442), PVC Tubing (RPI Part #RPT441), Cap (RPI Part #RPC443), Filter (RPI Part #CME004) and PM sticker

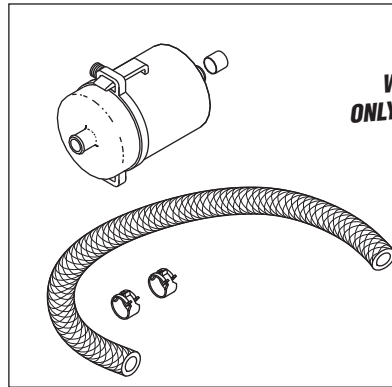

**THE RPI ADVANTAGE!
WITH THE RPI INTAKE FILTER KIT,
ONLY THE FILTER NEEDS REPLACEMENT -
NOT THE ENTIRE ASSEMBLY!**

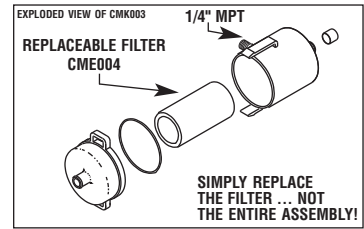

RPI Part #CME004
OEM Part #'s - Fits RPI Part #CMK003 only

REPLACEMENT FILTER ELEMENT

- Replacement filter element for (RPI Part #CMK003) only
- Includes O-ring and PM sticker
- 1.56" OD x 2.96" long

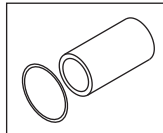

RPI Part #RPT441
OEM Part #PFM50955 (Complete Filter Kit)

PVC TUBING - CLEAR

- .50" ID x .728" OD
- Sold by the foot (reel not included)
- Replacement for tubing included in Fresh Air Intake Filter Kit (RPI Part #CMK003)

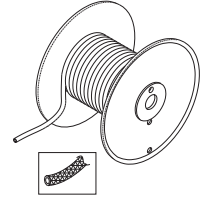

RPI Part #RPC443
OEM Part #PFM50955 (Complete Filter Kit)

CAP

- 6 per package; 1/2" ID; Black textured
- Replacement for cap included in Fresh Air Intake Filter Kit (RPI Part #CMK003)



RPI Part #RPC442
OEM Part #PFM50955 (Complete Filter Kit)

UNICLAMP

- 6 per package; Fits 3/4" OD tubing
- Replacement for uniclamp included in Fresh Air Intake Filter Kit (RPI Part #CMK003)



Don't forget ... RPI has these parts and more to fit Dental Compressors!

- | | | |
|-----------------------------------|------------------------------------|--------------------------------|
| • Air Intake Filters and Elements | • Desiccants | • Pressure Switches and Valves |
| • Air Filter Assemblies | • Differential Pressure Indicators | • Pressure Gauges |
| • Carbon Filter Elements | • Fresh Air Intake Filters | • Run Capacitors |
| • Coalescing Filter Assemblies | • Moisture Indicators | • Safety Valves |
| • Coalescing Filter Elements | • Mounting Brackets | • Sight Glasses |
| • Compressor Oil | • Particle Filter Assemblies | • Start Boxes |
| • Compressor PM Kit | • Particle Filter Elements | • Start Capacitors |
| • Cooling Fans | • Purge Filters and Mufflers | • Thermal Protector Assemblies |