



replacement parts industries, inc.

CALL 800-221-9723 or 818-882-8611 • FAX 818-882-7028
E-MAIL: techsupport@rpiparts.com • WEBSITE: www.rpiparts.com

"The Alternate Source"

SCK037 DRAIN KIT WITH PUMP FILTER INSTALLATION INSTRUCTIONS

LIST OF PARTS INCLUDED IN DRAIN KIT WITH PUMP FILTER (RPI PART# SCK037)

- | | |
|--|--|
| <input type="checkbox"/> BARB TEE (1 piece) (RP Part #RPB703) | <input type="checkbox"/> DRAIN TUBE KIT (RPI Part #RPK432) |
| <input type="checkbox"/> CABLE CLAMP (1 piece) (RPI Part #RPC701) | <input type="checkbox"/> FEMALE QUICK CONNECT FITTING (RPI Part #RPF428) |
| <input type="checkbox"/> CABLE HOLDER (1 piece) (RPI Part #RPC702) | <input type="checkbox"/> HEX NUT (1 piece) (RPI Part #RPH111) |
| <input type="checkbox"/> CABLE TIE (3 pieces) (RPI Part #RPT083) | <input type="checkbox"/> SILICONE TUBING (45.50") (RPI Part #RPT373) |
| <input type="checkbox"/> CORD CLIP (1 piece) (RPI Part #ADC058) | <input type="checkbox"/> WATER FILTER (IN-LINE) (RPI Part #SCF034) |

- 1) Disconnect the power to the sterilizer. Remove the cover. Disconnect the two cables from the PC board - one cable from the LCD display board and the other from the keypad.
- 2) Siphon all water from the reservoir.
- 3) Remove and discard the two pump screen filters (Mesh Filter) located in each end fitting of the water pump. Remove both end fittings from the pump (see Figure 1). Reinstall fittings. Reconnect the metering tube from the steam generator/boiler to the pump. Disconnect and discard the tubing from reservoir to the pump.
- 4) Disconnect the power switch wires.
- 5) Remove the three reservoir mounting cap nuts from underneath the chassis (see Figure 2) and save two cap nuts for use later in these instructions.

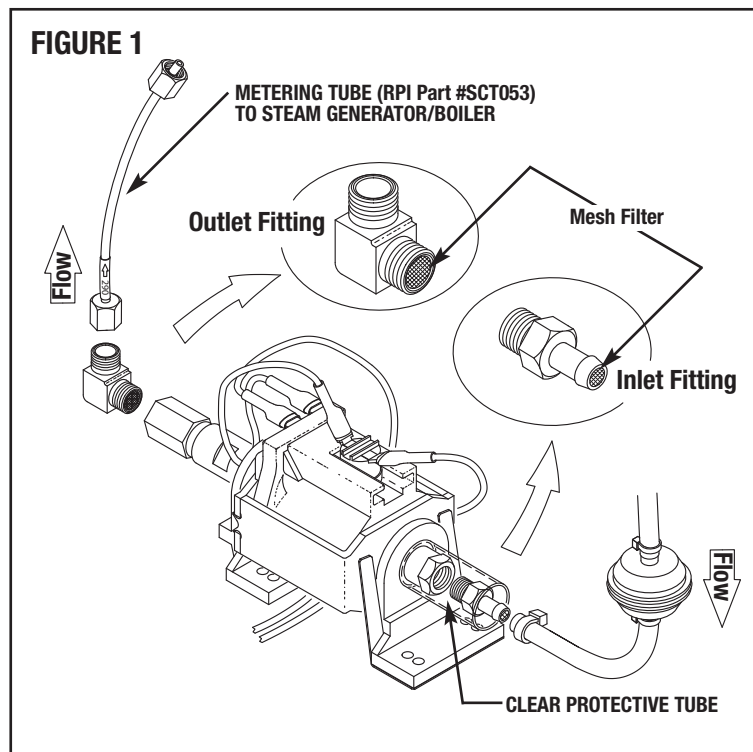

FIGURE 1

FIGURE 2

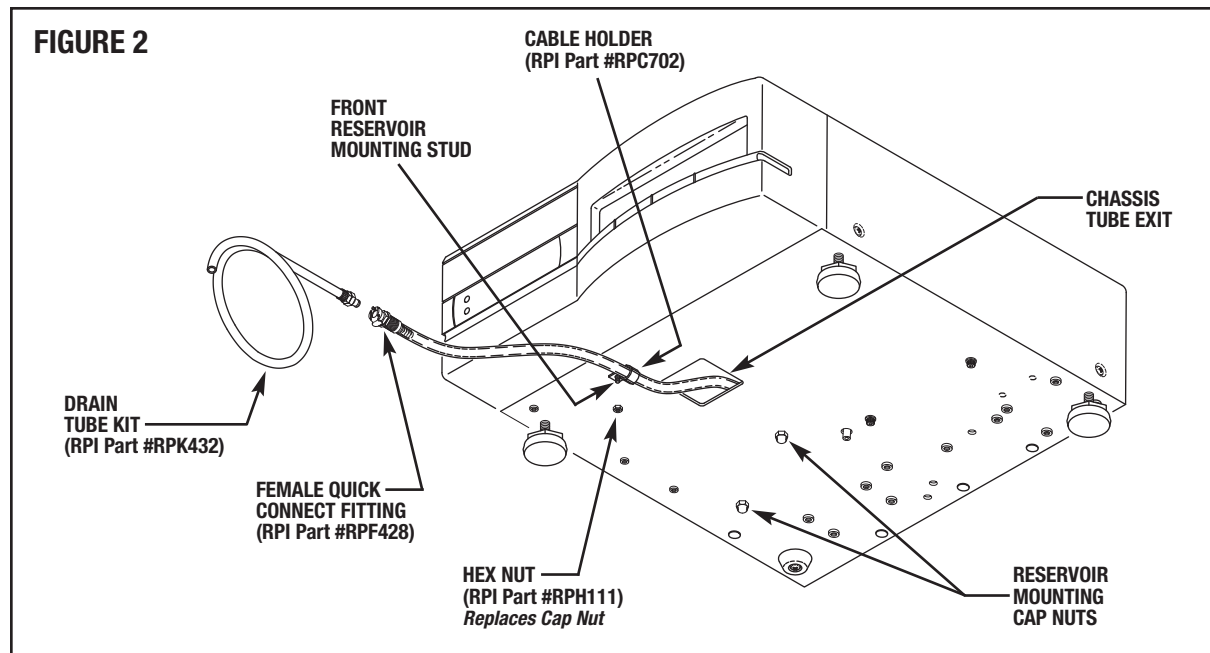
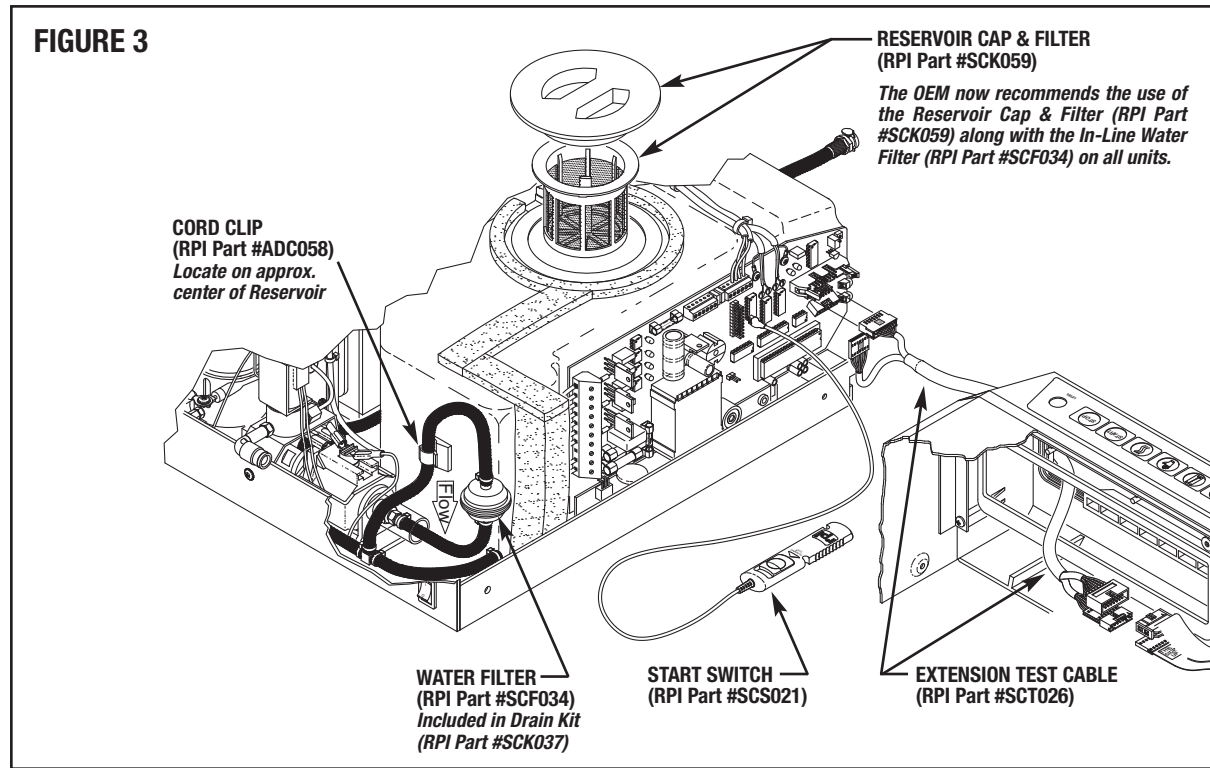
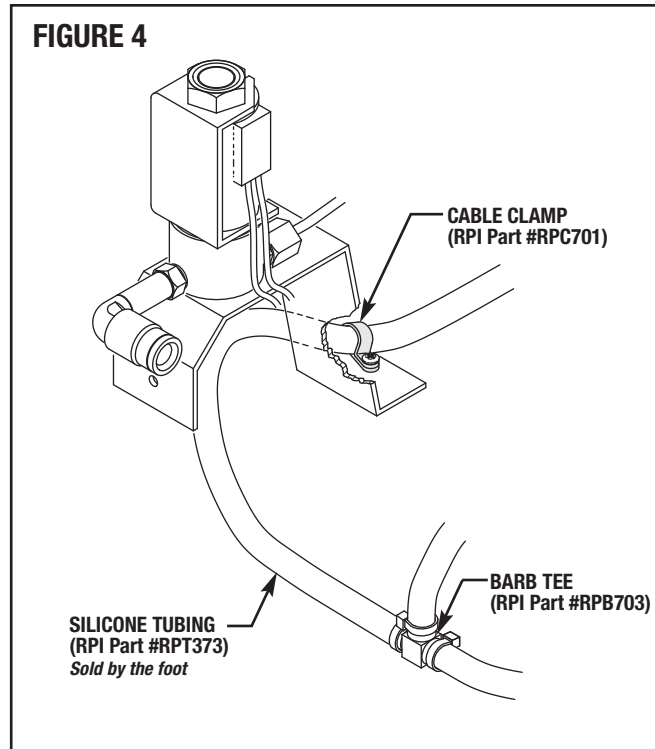

FIGURE 3



Continued on reverse side.

- 6) Place the new drain tubing along the rear fold in the chassis and underneath the switch wires and power module (if present). Connect the short non-filtered tube to the reservoir and run the filtered tubing through the clear protective tube and connect to the barb on the pump. Secure these connections using Cable Ties (RPI Part #RPT083) supplied in this kit and connect the clear protective tubing (see Figure 3). Run the long end of tubing with the Female Quick Connect (RPI Part #RPF428) underneath the solenoid valve bracket (see Figure 4). Lift the reservoir upwards and run the tubing along the side of the reservoir and exit to the underside of the sterilizer through the chassis opening (see Figure 2).



- 7) Reinstall the reservoir to its original position and check for kinks in the tubing. Attach the Cable Holder (RPI Part #RPC702) to the front reservoir mounting stud (underneath chassis) using the Hex Nut (RPI Part #RPH111) provided in this kit. Reinstall the two cap nuts from Step #5 onto the two remaining mounting studs and tighten. (CAUTION: Do not over tighten nuts, threaded stud could be snapped.) Place tubing into cable holder and check again for kinks in the tubing at the chassis tube exit (see Figure 2).
- 8) Secure tubing at solenoid valve by installing Cable Clamp (RPI Part #RPC701) over tubing and attaching to the inner screw on the solenoid valve bracket (see Figure 4). Use the supplied Cord Clip (RPI Part #ADC058) to secure the filtered tube onto the reservoir, locate on approximate center of reservoir end panel (see Figure 3).
- 9) Reconnect the power switch wires (see Figure 5).
- 10) Fill the reservoir (use distilled water only). Connect the new Drain Tube Kit (RPI Part #RPK432) included in this package to the female quick disconnect (on drain tubing) and allow water to drain into a bucket until most of the air bubbles are gone. Allow to drain for at least 30 seconds, then disconnect the drain tube kit. Push excess drain tubing back into the cable holder under sterilizer until quick connect fitting is tucked away to clear counter top area.

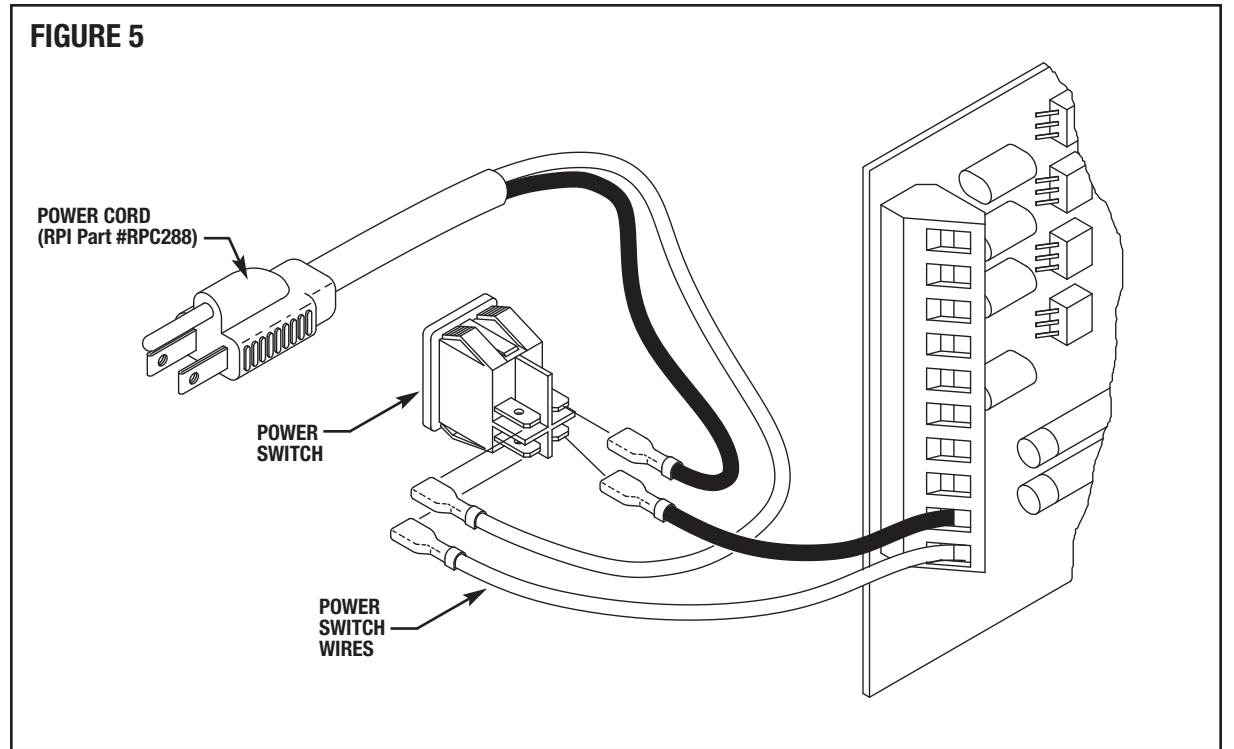

- 11) Upgrade is now complete.
- 12) Reconnect the ribbon cables from the cover to the main PCB. For ease of testing, use our Extension Test Cable - RPI Part #SCT026 (see Figure 3).
- 13) Restore power and prime pump. Activate the pump to purge trapped air from the tubing (until water passes through the pump) by using our Start Switch (RPI Part #SCS021) or by jumpering Pins 16 and 18 on the "20 Pin Connector" (P1) located on the main PC board. Run test cycles and check for leaks.
- 14) If attached, remove the RPI Extension Test Cable and replace the cover. Repeat test cycle.