



replacement parts industries, inc.

CALL (800) 221-9723 or (818) 882-8611 • FAX (818) 882-7028  
E-MAIL: techsupport@rpiparts.com • WEBSITE: www.rpiparts.com

Proud to be ISO Certified

## PCK780 FOOT CONTROL VALVE KIT INSTALLATION INSTRUCTIONS

### Parts Checklist:

- Regulator Diaphragm (RPI Part #PCD748)
- Stem (RPI Part #PCS779)
- Micro-Switch & Diaphragm Assembly (RPI Part #PCA752)
- Check Valve (RPI Part #PCV755)

1. With a felt tipped marker, draw a line that extends the length from top to bottom of the Foot Control Valve – **See Figure 1**. This will allow you to maintain proper alignment for the tubing when reconnecting the three parts of the Foot Control Valve.
2. Remove the 90° Male Elbow Fitting from the Foot Control Valve top.
3. Remove the three 1-1/4" long Slotted Screws that hold the Foot Control Valve Chamber to the Foot Control Valve bottom. Separate the Foot Control Valve Chamber from Foot Control Valve bottom.
4. Turn the Foot Control Valve Chamber over in your hand. Push the Piston Regulator down with your fingers and remove the #4-40 x 1/8" long Slotted Screw and the Support Disk. Save removed parts for later use.
5. Note the orientation of the Regulator Diaphragm (this will be helpful when reinstalling it in Step #9), then gently remove the Regulator Diaphragm from the Piston Regulator.
6. Use a 1/16" Hex Key to loosen the set screw that holds the Stem to the Piston Regulator. Remove the Piston Regulator and Spring from the Stem. Remove the Stem through the top of the Foot Control Valve Chamber where the elbow fitting was originally located.
7. Install the new Stem by placing it back down through the top of the Foot Control Valve Chamber. Use a 1/16" Hex Key to tighten the set screw that holds the Piston Regulator and Spring to the Stem.
8. Reinstall the 90° Male Elbow Fitting removed in Step 2.
9. Maintaining its original orientation noted in Step 5, install the new Regulator Diaphragm. Reinstall the original Support Disk and the #4-40 x 1/8" long Slotted Screw that was removed in Step 4 above. (Note: Make sure the Regulator Diaphragm is seated firmly around the Piston Regulator, and that the Spring is seated properly.)
10. Test that the Piston Regulator moves up and down freely.
11. Reconnect the Foot Control Valve Chamber to the Foot Control Valve bottom. Ensure proper alignment by matching up the line markings that were drawn in Step 1. Reinstall the three 1-1/4" long Slotted Screws from Step 3.
12. Replace Micro-Switch & Diaphragm Assembly.
13. Replace Check Valve.
14. Test Foot Control operation.

Figure 1  
Foot Control Valve

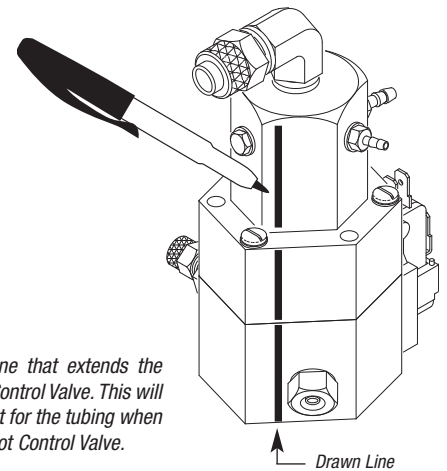

With a felt tipped marker, draw a line that extends the length from top to bottom of the Foot Control Valve. This will allow you to maintain proper alignment for the tubing when reconnecting the three parts of the Foot Control Valve.

Foot Control Valve  
Block Assembly  
Exploded View

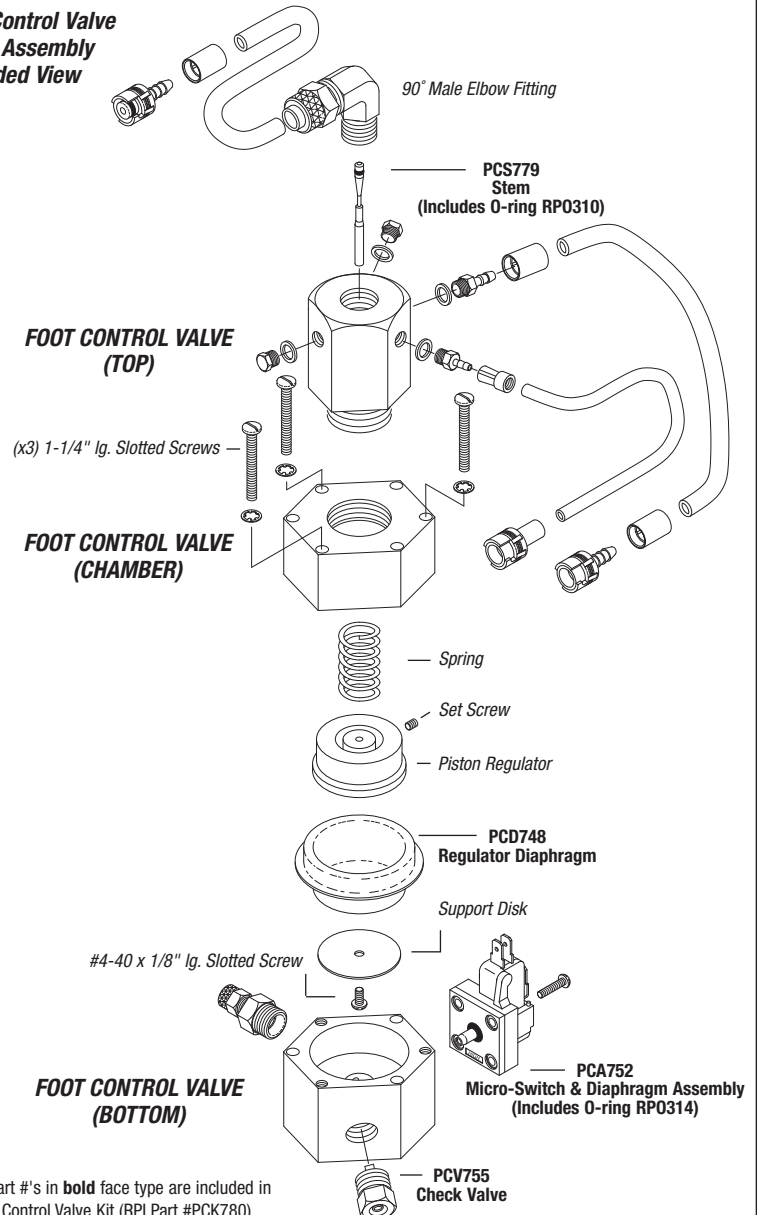

NOTE: Part #'s in **bold** face type are included in the Foot Control Valve Kit (RPI Part #PCK780).