



replacement parts industries, inc.

A Healthcare Components Group Company
 CALL 800-221-9723 or 818-882-8611 • FAX 818-882-7028
 E-MAIL: techsupport@rpiparts.com • WEBSITE: www.rpiparts.com

MIA315 & MIA317 BACK & TILT ACTUATOR INSTALLATION INSTRUCTIONS

NOTE: Depending on model and serial number, the RPI Part #MIA315 may be used as a tilt actuator, a back actuator or both. Refer to the sections below based on location for removal and installation information.

BACK REMOVAL AND INSTALLATION DIRECTIONS (see Figure 1 for parts I.D.)

1. Raise TILT UP and BACK UP functions all the way.
2. Unplug the table power cord from the wall outlet. See "WARNING" note below.



WARNING: Disconnect the power from the table before removing covers/shrouds or making any repairs to prevent the possibility of electrical shock, severe personal injury, or death.

3. Cut cable ties securing the wire harnesses to the actuator.
4. Tag and disconnect (3) back actuator wires from (3) chassis (in-line quick connector set) wires.

CAUTION: The back section of the table MUST be supported during the remaining steps. If possible, have an assistant available to support the back section. Failure to do so could result in damage to the chair or injury to the installer.

5. While supporting the back section of the table, remove the back actuator by removing the e-clips and the clevis pins. Retain all parts for reuse later.
6. Secure yoke of new actuator by screwing yoke into the actuator shaft until completely tightened and use (2) set screws (provided installed) to lock the yoke in place.
7. While supporting the back section of the table, reinstall the back actuator by using the e-clips and the clevis pins retained earlier.
8. Connect (3) actuator wires to (3) tagged wires using quick connect terminals supplied.
9. Secure wire harnesses to actuator body with cable ties provided.
10. Plug power cord into wall receptacle.
11. If available, run AUTO RETURN function to reset home position.

Figure 1 - Typical Back Actuator Exploded View
 MIA315 (No Limit Switches) shown below
 MIA317 (With Limit Switches) not shown

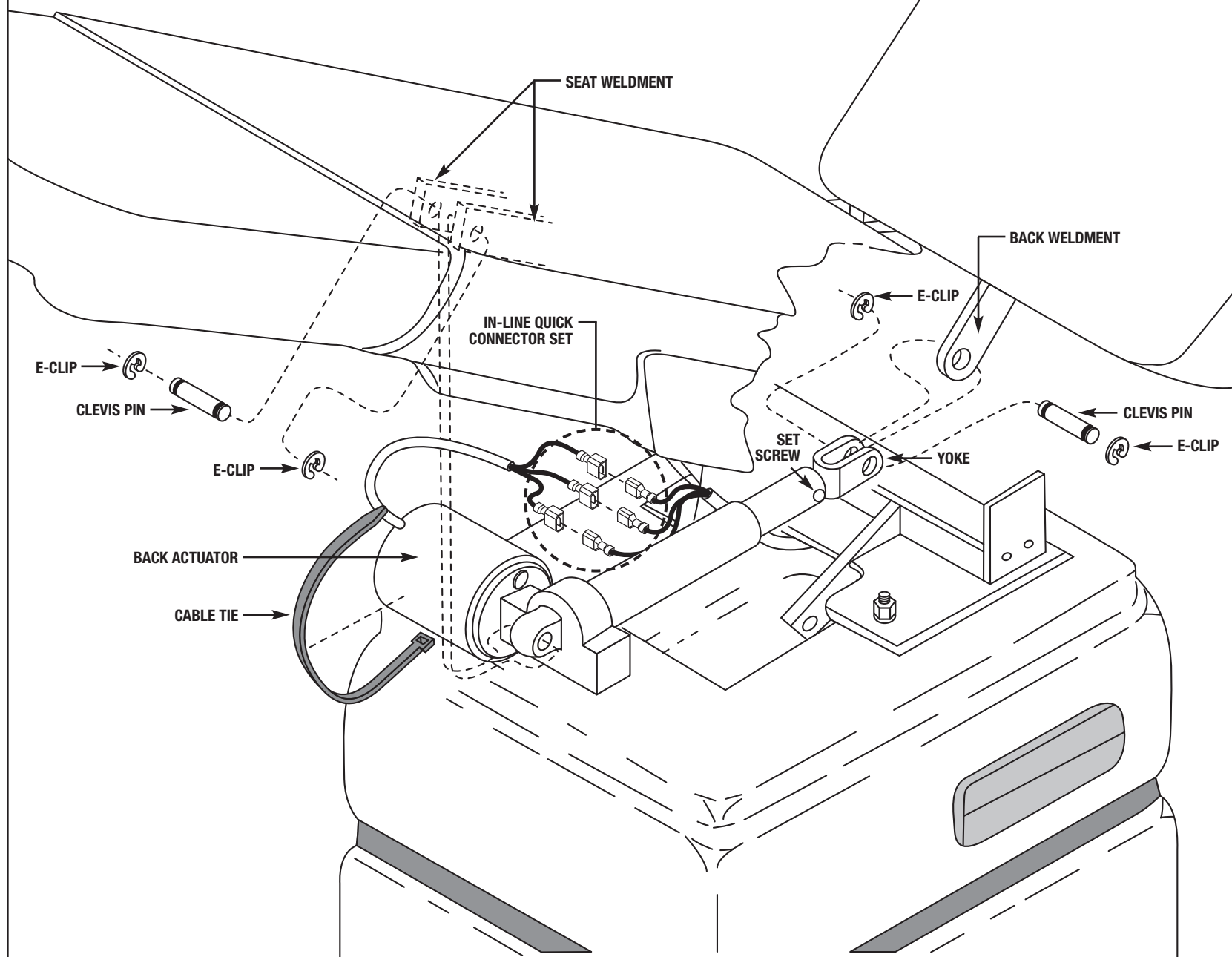

TILT REMOVAL AND INSTALLATION DIRECTIONS (see Figure 2 for parts I.D.)

1. Raise TILT UP functions all the way.
2. Unplug the table power cord from the wall outlet. See “WARNING” note below.



WARNING: Disconnect the power from the table before removing covers/shrouds or making any repairs to prevent the possibility of electrical shock, severe personal injury, or death.

3. Cut cable ties securing the wire harnesses to the actuator as needed.
4. Tag and disconnect (3) tilt actuator wires from (3) chassis (in-line quick connector set) wires.
5. While supporting the foot section of the table, remove the tilt actuator by removing the e-clips and the clevis pins. Retain all parts for reuse later.
6. Secure yoke of new actuator by screwing yoke into the actuator shaft until completely tightened and use (2) set screws (provided installed) to lock the yoke in place.

7. While supporting the foot section of the table, reinstall the tilt actuator by using the e-clips and the clevis pins retained earlier.
8. Connect (3) actuator wires to three tagged wires using quick connect terminal supplied.
9. Secure wire harnesses to actuator assembly with cable ties provided.
10. Plug power cord into wall receptacle.
11. If available run **AUTO RETURN** function to reset home position.

