



replacement parts industries, inc.

CALL 800-221-9723 or 818-882-8611 • FAX 818-882-7028
E-MAIL: techsupport@rpi.com • WEBSITE: www.rpiparts.com

"The Alternate Source"

MIA272 ACTUATOR (FOOT) INSTALLATION INSTRUCTIONS

REMOVAL - Refer to Figure 1.

1. If possible, raise the foot section and then place a wood support under the foot section.

NOTE: If the foot section is in its lowest position and cannot be raised, it may be necessary to remove the screw and shoulder washer before performing the next step (see **A** in figure 1).

2. Remove the two E-rings and clevis pin from the foot end of the actuator.
3. Using the foot or hand control, if possible, retract the foot actuator into the chair seat.
4. Unplug the table from wall.

WARNING: Ensure power has been disconnected before proceeding to prevent the possibility of electrical shock, severe personal injury, or death.

5. Using 4 knobs, remove the seat upholstery and then remove the electrical cover.
6. Disconnect the two wires from the terminals of the limit switch mounted on foot actuator.
7. Remove the hole plug from the seat frame and the two E-rings from the motor drive end of the actuator; then using a hammer and punch, drive the clevis pin out thru the hole in the seat frame.
8. Remove the nut and ground wire from the foot actuator motor - retain nut for later use.
9. Disconnect the foot actuator wire from the wire harness.
10. Using a screwdriver, pry the tab of the mounting bracket outward then remove the foot start capacitor from mounting bracket. Carefully remove the cover from the foot capacitor and retain for later use. Be cautious not to touch the capacitor terminals – see **"DANGER" note below.**

DANGER: Never touch the terminals of a capacitor until it has been properly discharged. Personal injury or death could occur because a capacitor can store an electrical charge for many years even if the power has been shut off.

11. Using a suitable device, discharge the foot capacitor.
12. Disconnect the two actuator wires from the terminals of the foot capacitor.
13. Remove the foot actuator from the chair seat. Remove the two screws, two nuts and the limit switch from the foot actuator. Retain the limit switch and all of the hardware for later use.
14. Remove the screw and nut from the clevis cover. Remove the top clevis cover and the bottom clevis cover and retain along with all of the hardware for later use.
15. Measure the distance from the actuator face to the clevis for use in setting the distance on the replacement actuator (see **B** in figure 1).

NOTE: If replacing the Motor Coupler using RPI Part # MIC166, or replacing the Brake and Coupler using RPI Part #MIK167, see the reverse side of this page for installation instructions.

INSTALLATION - Refer to Figure 1.

1. On the new actuator, set the shaft clevis distance to the measurement previously taken onto the new actuator (see **B** in figure 1). Ensure that the set screws are tightened after this adjustment.

2. Installation is the reverse of the removal process. Be sure to check the crimped on terminals for tightness and insure that the foot capacitor has its cap installed correctly and that the capacitor is fully snapped into the mounting bracket. When installing the limit switch, leave the hardware loose until the foot has been fully raised and then set the final limit switch location so that the switch is activated and then tighten the hardware.

FIGURE 1

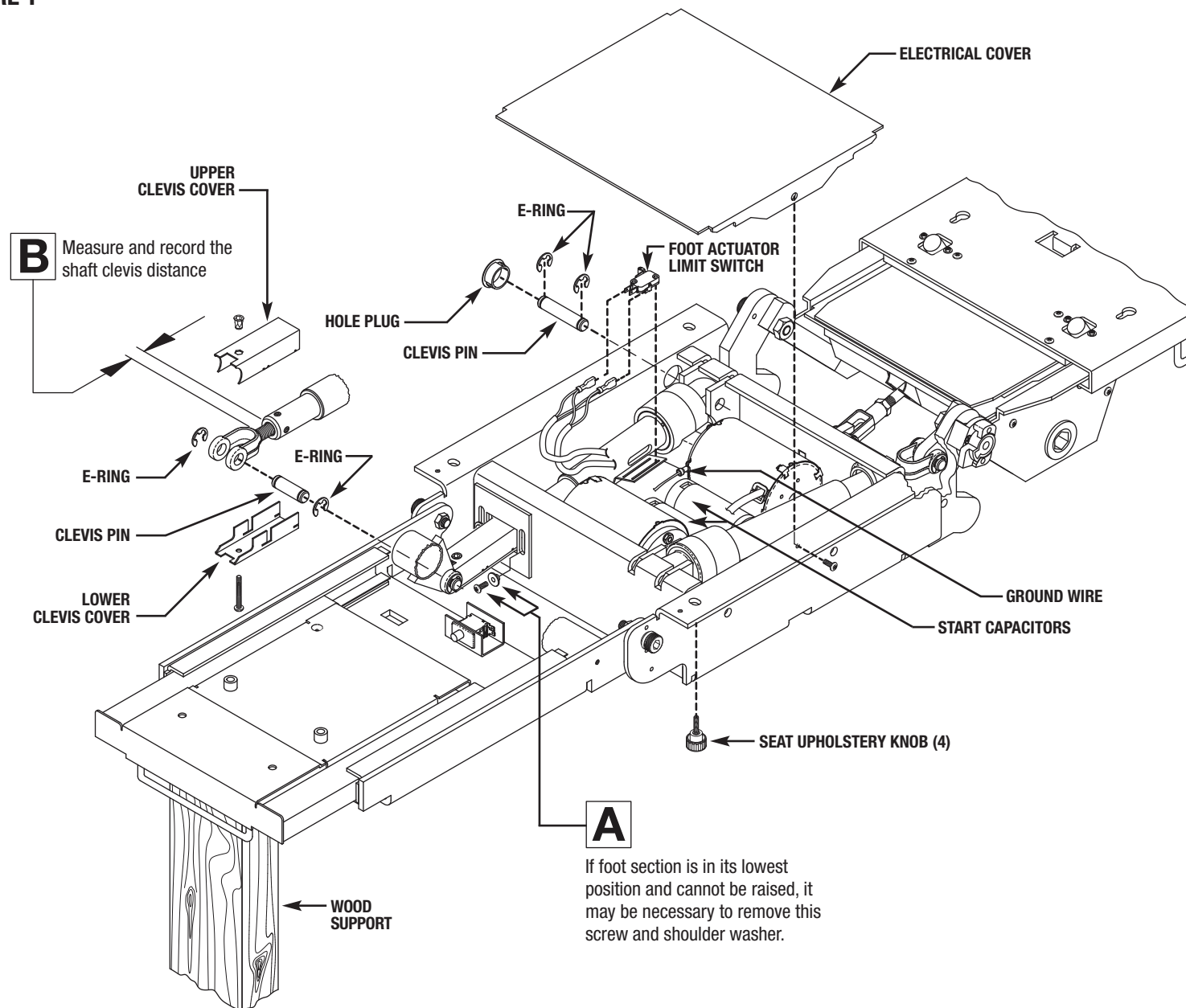

INSTALLATION INSTRUCTIONS

RPI Part #MIC166 - Motor Coupler

RPI Part #MIK167 - Brake & Coupler Kit

1. Remove the foot actuator, see "REMOVAL" Steps #1-13 on the reverse side of this page.
2. Separate the motor from the actuator and replace the motor coupler and brake (see Figure 2 below).

Note: The brake is not used in actuator assemblies manufactured by Fasco.

3. Reinstall the actuator, see "INSTALLATION" Step #2 on the reverse side of this page.

FIGURE 2

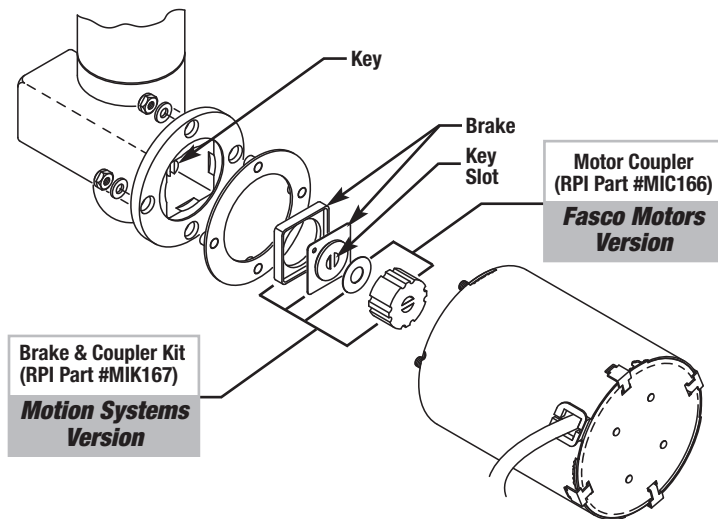

NOTE: Ensure that the Keys and the Key Slots are properly aligned, allowing the Brake and Coupler to easily engage the motor and Actuator.