



MIA218 ACTUATOR (TILT) INSTALLATION INSTRUCTIONS

REMOVAL - Refer to Figure 1.

1. Run the **TABLE UP** function to raise the table to the highest position. Then disconnect the power - see "Warning" note below.

WARNING: Disconnect the power from the table before removing covers/shrouds or making any repairs to prevent the possibility of electrical shock, severe personal injury, or death.

2. Remove the right and left side outer shrouds.
3. Lower the middle outer shroud assembly down and out of the way.
4. Cut the cable ties securing the actuator cable to the shaft of the tilt actuator assembly. Remove the connection cover and cut the cable tie holding the cable to the capacitor mounting bracket.
5. Remove the capacitor mounting bracket and remove the cap from the tilt capacitor. Be cautious not to touch the capacitor terminals - see "Warning" note below.

DANGER: Never touch the terminals of a capacitor until it has been properly discharged. Personal injury or death could occur because a capacitor can store an electrical charge for many years even if the power has been shut off.

6. Identify, tag and disconnect the three actuator wires. The yellow and the orange wires connected to the tilt capacitor do not need to be disconnected.
7. Support the foot end of the table - see "Warning" note below. Then remove the two e-rings and the clevis pin that secure the base of the tilt actuator to the column adapter weldment.

DANGER: Support the foot end of the table top before removing the clevis pin to prevent the table top from falling onto the technician resulting in possible severe personal injury or death.

8. Remove the left side stirrup housing from the seat weldment.
9. Raise the seat weldment up far enough to gain access to the pivot pin. Support the seat weldment in this position using a block (see Figure 2). Then remove the two e-rings, and drive the pivot pin from the seat weldment using a hammer and a punch.
11. Remove the tilt actuator from the table.

NOTE: If you are replacing the Brake and Coupler Kit (RPI Part #MIK167), see the reverse side of this page for installation instructions.

INSTALLATION - Refer to Figure 1.

1. Cut the actuator cable to length and prepare the cable end for the terminals. Crimp the two 1/4" flag terminals to the Red and the Black wires, and the 1/4" fully insulated male tab to the White wire.
2. Install the new actuator and reattach the base of the tilt actuator to the column adapter weldment using the clevis pin and the two e-rings.
3. Reattach the three actuator wires and reassemble the capacitor.
4. Secure the wire harness to the capacitor mounting bracket using a cable tie included in this kit and reinstall the capacitor cover.
5. Secure the actuator cable to the actuator with the three remaining cable ties.
6. Using the spanner holes, position the adjustable clevis until it is even with the top of the actuator rod.
7. Reconnect the power to the table.
8. Run the **TILT UP** function to extend the rod of the tilt actuator 3 - 4 inches (7.6 - 10.2 cm).
9. Remove the block supporting the foot end of the table top; then temporarily connect the tilt actuator to the seat weldment using the clevis pin.
10. Lower the **TILT DOWN** function all the way down (until tilt actuator can be heard free wheeling). **Note:** If the tilt actuator does not free wheel at the end of its stroke, the seat weldment is hitting the column adapter weldment. This condition will create premature failure of the tilt actuator. To alleviate this condition, reposition the adjustable clevis.
11. The seat weldment should now be parallel with the top of the column adapter weldment. If not parallel, once again, run the **TILT UP** function to extend the actuator rod 3 - 4 in. (7.6 - 10.2 cm), and then reinsert the block to support the foot end of the table. Remove the clevis pin and reposition the adjustable clevis to compensate for the non-parallel alignment, then repeat Steps #8 through #10 above.
12. Secure the clevis pin in place with the two e-rings.
13. Install the left side stirrup housing onto the seat weldment.
14. Install the right and left side outer shrouds (tuck the shroud tabs into the mating slots in the column adapter weldment) and secure with the mounting screws, ensuring that the middle outer shroud assembly is captured by the right and left side outer shrouds.

FIGURE 1

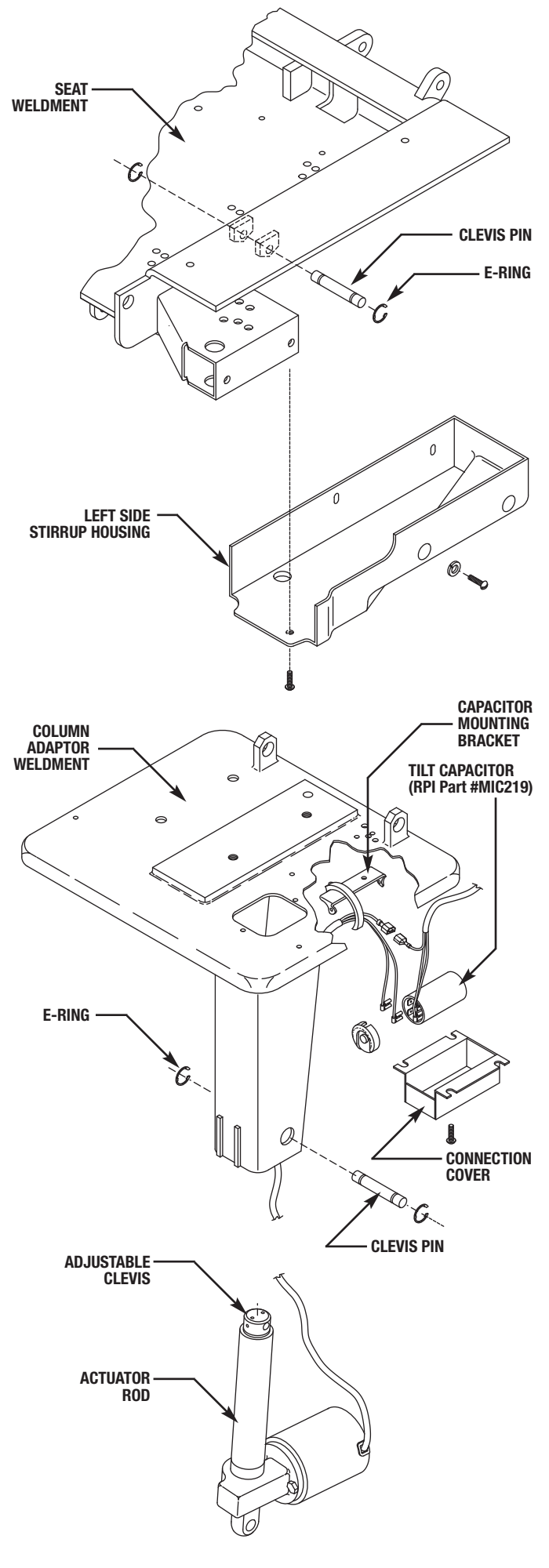
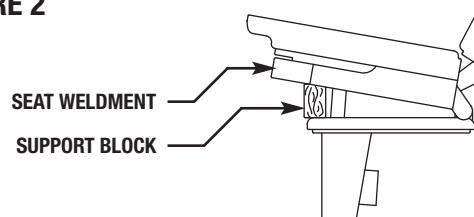

FIGURE 2



Raise the seat weldment up far enough to gain access to the pivot pin. Support the seat weldment in this position using a block. Then remove the two e-rings, and drive the pivot pin from the seat weldment using a hammer and a punch

INSTALLATION INSTRUCTIONS

RPI Part #MIC166 - Motor Coupler
RPI Part #MIK167 - Brake & Coupler Kit

1. Remove the tilt actuator, see "REMOVAL" Steps #1-11 on the reverse side of this page.
2. Separate the motor from the actuator and replace the motor coupler and brake (see Figure 1).

Note: The brake is not used in actuator assemblies manufactured by Fasco.

3. Reinstall the actuator, see "INSTALLATION" Steps #1-14 on the reverse side of this page.

