



replacement parts industries, inc.

CALL 800-221-9723 or 818-882-8611 • FAX 818-882-7028
E-MAIL: techsupport@rpi.com • WEBSITE: www.rpiparts.com

"The Alternate Source"

MIA215 ACTUATOR (FOOT) INSTALLATION INSTRUCTIONS

REMOVAL - Refer to Figure 1.

1. Disconnect the power from the table - see "Warning" note below.

WARNING: Disconnect the power from the table before removing covers/shrouds or making any repairs to prevent the possibility of electrical shock, severe personal injury, or death.

2. Squeeze the release latches and remove the foot board assembly from the foot extension weldment.
3. Remove the front trim from the foot extension weldment.
4. Partially remove the foot capacitor cover (by removing the 2 screws) from the foot extension weldment.
5. Disconnect the foot actuator wire and remove the cap from the capacitor. Be cautious not to touch the capacitor terminals - see "Warning" note below.

DANGER: Never touch the terminals of a capacitor until it has been properly discharged. Personal injury or death could occur because a capacitor can store an electrical charge for many years even if the power has been shut off.

6. Identify, tag and disconnect the two actuator wires from the foot capacitor terminals.
7. Pull the actuator wires thru the snap bushing.
8. Remove the hole plug from the foot extension weldment.
9. Remove the two e-rings from the clevis pin.
10. Drive the clevis pin attaching the foot extension weldment to the actuator body out using a hammer and a punch.
11. Support the foot extension weldment in position. On the shaft end of the actuator, loosen the two jam nuts, then remove the two pivot screws securing the foot actuator to the seat weldment.
12. Remove the foot actuator. Then remove the bellows from the shaft of the foot actuator and install onto the new foot actuator.

NOTE: If you are replacing the Brake and Coupler Kit (RPI Part #MIK167), see the reverse side of this page for installation instructions.

INSTALLATION - Refer to Figure 1.

1. Cut the actuator cable to length and prepare the cable end for the terminals. Crimp the two 1/4" flag terminals to the Red and the Black wires, and the 1/4" fully insulated male tab to the White wire.
2. Reassemble in the reverse order. Do not fully tighten the pivot screws and the jam nuts at this time.
3. Reconnect the power to the table.
4. Run the **FOOT UP** function until the foot actuator is fully extended (the actuator can be heard free wheeling).
5. The foot extension weldment should now be level with the seat weldment. If not level, adjust the actuator end mount accordingly.
6. Tighten the two pivot screws until they bottom out, then back the pivot screws off 1/8 to 1/4 turn ensuring that the actuator end mount is centered between the seat weldment mounting flanges.
7. Secure the two pivot screws in their position by tightening the jam nuts to 45 - 55 lb-ft (61 - 74.5 nm).
8. Install the foot board assembly onto the foot extension weldment, making sure the foot board weldment is properly latched.

FOOT CAPACITOR COVER ASSEMBLY DETAIL

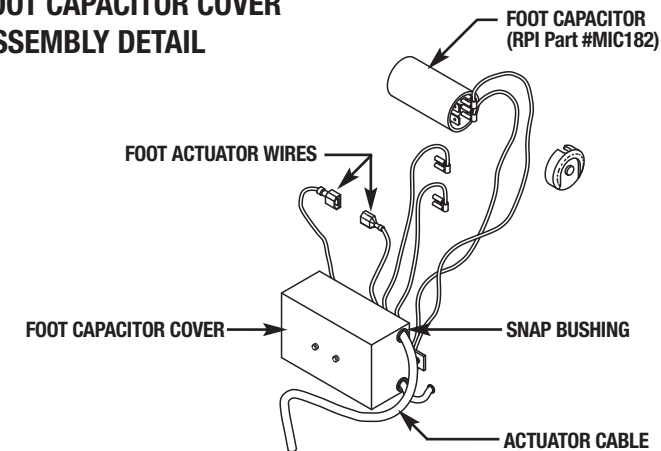
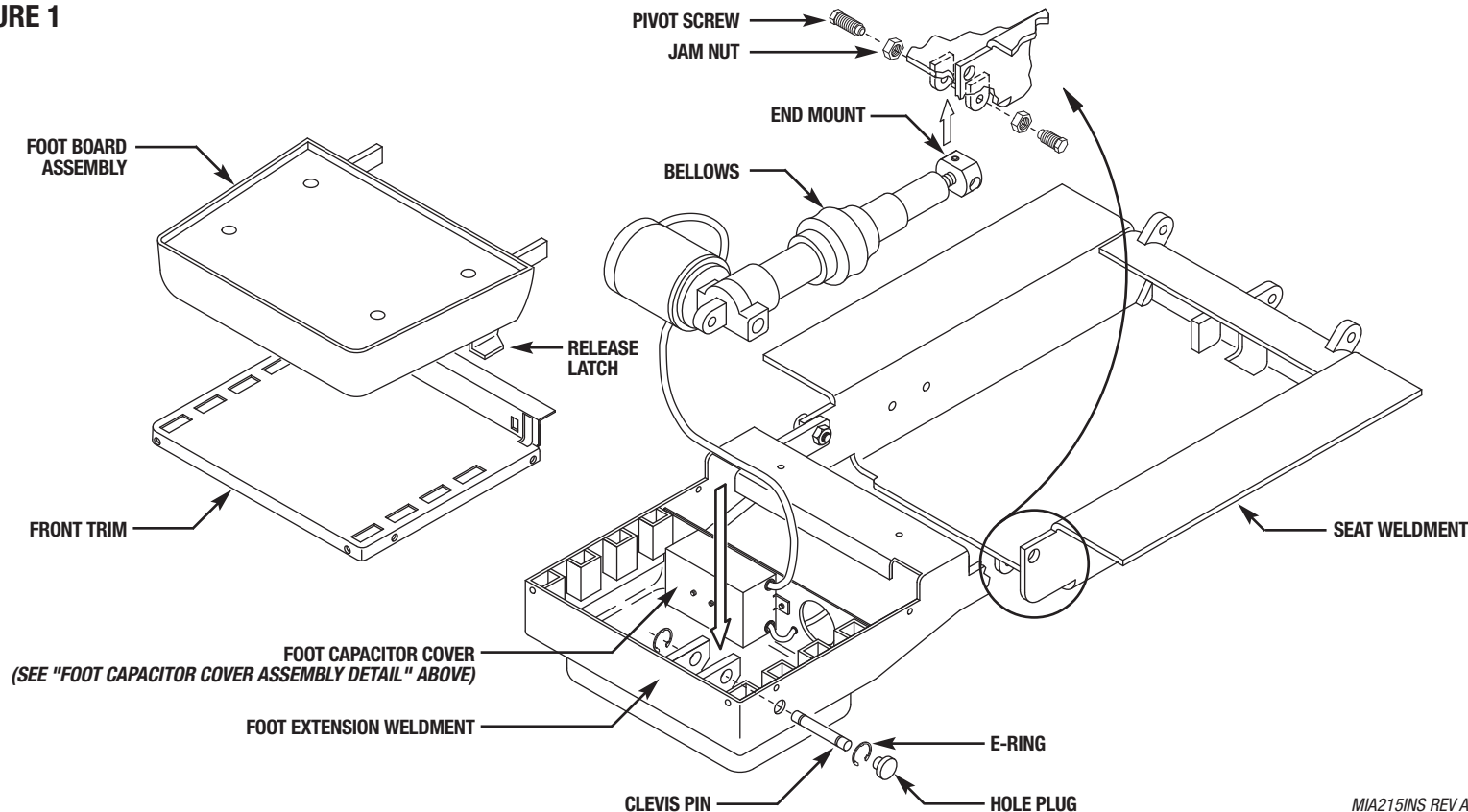

FIGURE 1



INSTALLATION INSTRUCTIONS

RPI Part #MIC166 - Motor Coupler

RPI Part #MIK167 - Brake & Coupler Kit

1. Remove the foot actuator, see "REMOVAL" Steps #1-12 on the reverse side of this page.
2. Separate the motor from the actuator and replace the motor coupler and brake (see Figure 1).

Note: The brake is not used in actuator assemblies manufactured by Fasco.

3. Reinstall the actuator, see "INSTALLATION" Steps #1-8 on the reverse side of this page.

FIGURE 1

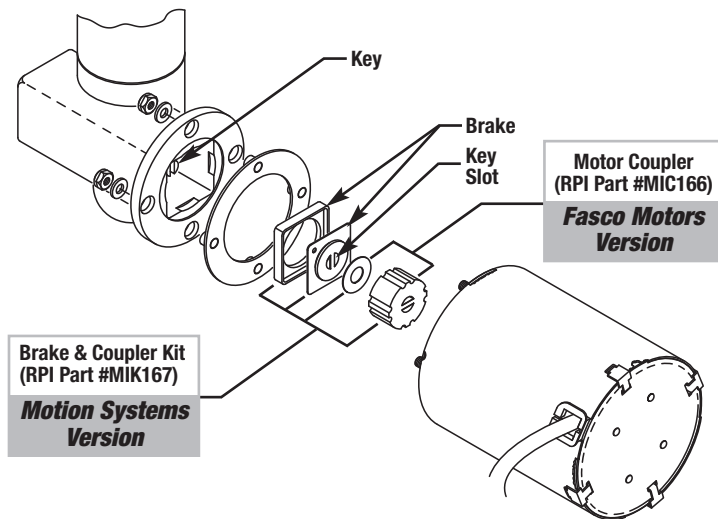

NOTE: Ensure that the Keys and the Key Slots are properly aligned, allowing the Brake and Coupler to easily engage the motor and Actuator.