



CSK066 CHECK VALVE REBUILD KIT INSTALLATION INSTRUCTIONS

WARNING: To prevent the possibility of death, serious injury or property damage, depressurize valve and vent to a safe area before servicing the valve.

Note: Removal of valve from pipeline is not necessary for rebuilding.

Disassemble Valve

1. Unscrew end cap from valve body.
2. Remove end cap gasket, gasket retainer if present, return spring, disc holder and seal from valve body.
3. Remove and clean out any debris found inside the valve.

Assemble Valve

1. Reassemble valve using the exploded view for part identification and placement. (See Figure 1.)

Note: When rebuilding the check valve, it is important to install all new parts included in the rebuild kit. Utilizing both old and new parts could result in valve malfunction.

2. Lubricate end cap gasket with Dow Corning® 200 Fluid Lubricant or an equivalent high-grade silicone fluid.
3. Install disc holder and seal in valve body.
4. Install gasket retainer (if present in existing valve), then install the end cap gasket and return spring in valve body. (Note: If replacing the gasket retainer, then be sure that the shoulder side faces the end cap gasket, see Figure 1 or 2.)
5. Hand thread end cap into valve body as far as possible, then torque to 175 ± 25 in-lbs ($19,8 \pm 2,8$ Nm).

WARNING: To prevent the possibility of death, serious injury or property damage, make sure check valve is functioning properly before resuming normal operations. In addition, use a nonhazardous, noncombustible fluid to perform internal seat and external leakage tests.

6. Restore line pressure.
7. After maintenance is completed, operate the valve to be sure of proper operation.

Figure 1

Configuration to fit:

- 3/8" Check Valve (OEM Part #513361)

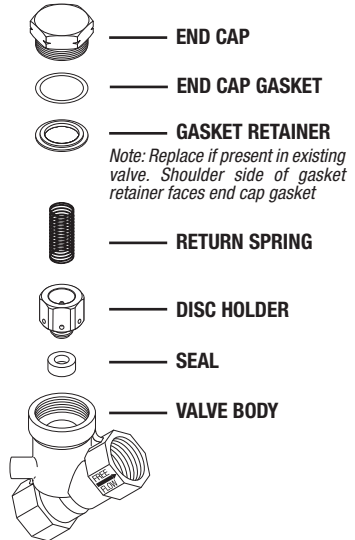

Configuration to fit:

- 1/2" Check Valve (OEM Part #513362)
- 3/4" Check Valve (OEM Part #513363)

