



**replacement parts industries, inc.**

CALL (800) 221-9723 or (818) 882-8611 • FAX (818) 882-7028

EMAIL techsupport@rpiparts.com • WEBSITE www.rpiparts.com

## CSK065 CHECK VALVE REBUILD KIT INSTALLATION INSTRUCTIONS

**WARNING:** To prevent the possibility of death, serious injury or property damage, depressurize valve and vent to a safe area before servicing the valve.

**Note:** Removal of valve from pipeline is not necessary for rebuilding.

### Disassemble Valve

1. Unscrew end cap from valve body.
2. Remove spring, end cap gasket, disc holder and seal from valve body.
3. Remove and clean out any debris found inside the valve.

### Assemble Valve

1. Reassemble valve using the exploded view for part identification and placement. (See Figure 1.)

**Note:** When rebuilding the check valve, it is important to install all new parts included in the rebuild kit. Utilizing both old and new parts could result in valve malfunction.

2. Lubricate end cap gasket with Dow Corning® 200 Fluid Lubricant or an equivalent high-grade silicone fluid.
3. Install disc holder and seal in valve body.
4. Install end cap gasket and spring in valve body.
5. Hand thread end cap into valve body as far as possible, then torque to  $175 \pm 25$  in-lbs ( $19,8 \pm 2,8$  Nm).

**WARNING:** To prevent the possibility of death, serious injury or property damage, make sure check valve is functioning properly before resuming normal operations. In addition, use a nonhazardous, noncombustible fluid to perform internal seat and external leakage tests.

6. Restore line pressure valve.
7. After maintenance is completed, operate the valve to be sure of proper operation.

**Figure 1**

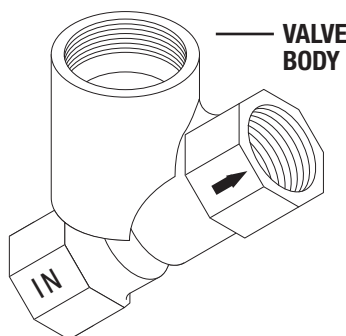
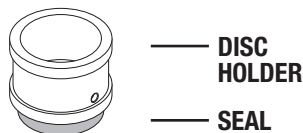
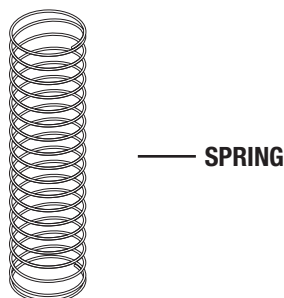
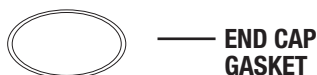
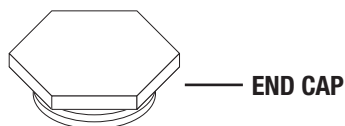

CSK065 INS REV- 08/09