



replacement parts industries, inc.

CALL 800-221-9723 or 818-882-8611 • FAX 818-882-7028
E-MAIL: techsupport@rpiparts.com • WEBSITE: www.rpiparts.com

BUS005 RECORD STYLUS INSTALLATION INSTRUCTIONS

- 1) Remove window and cover assembly on EKG machine.
- 2) Loosen terminal screws in terminal block and remove spade lug contacts (**See Figure 1**).
- 3) Loosen set screws in aluminum hub as shown and remove existing stylus assembly.
- 4) Before mounting replacement stylus, loosen set screws (2 places) in Teflon® hub (**See Figure 2**).
- 5) Install new stylus (RPI Part #BUS005) by inserting onto galvanometer shaft as shown. Tighten set screws (2 places).
- 6) Reconnect spade lug contacts to terminal block. Red lead connects to rear screw, and blue lead connects to front screw of terminal block.
- 7) Run machine and check for proper damping. Adjust pen tip pressure adjustment screw for over or under damping.
- 8) Replace window and cover assembly.

FIGURE 1
EXISTING STYLUS

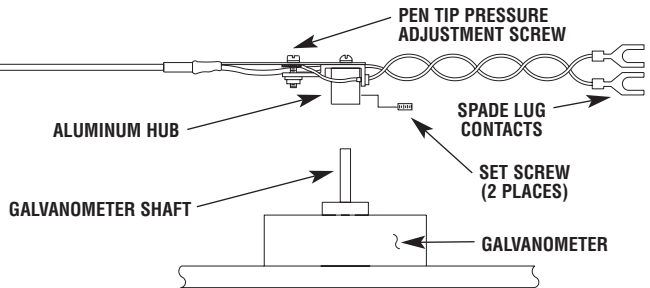

FIGURE 2
STYLUS (RPI Part #BUS005)

