



replacement parts industries, inc.

CALL 800-221-9723 or 818-882-8611 • FAX 818-882-7028
E-MAIL: techsupport@rpiparts.com • WEBSITE: www.rpiparts.com

ADK220 SOLENOID VALVE REPAIR KIT INSTALLATION INSTRUCTIONS



Warning – High Voltage

Hazardous voltages are present. Unplug the chair from the power source before servicing. Failure to do so could result in serious injury or death.



Note: Before installing the new Solenoid Valve Repair Kit (RPI Part #ADK220), please note that there are two versions of the manifold and each uses a different size o-ring. Two o-rings are included in this repair kit: one large and one small. Simply match the correct one to your manifold block.

1. Run the chair base and chair back to the lowest (full down) positions to depressurize the hydraulic system.
2. Remove power to the chair by unplugging it from the wall.
3. Remove the pump cover.
4. Position a towel under the manifold to collect any excess oil before you detach it by removing the two screws that secure the manifold in place.
5. Loosen and remove the hex nut that secures the solenoid valve and coil to the manifold and remove the coil.
6. Cut the defective solenoid coil wires approximately three inches from the coil and discard the coil. Strip the remaining coil wires approximately $\frac{1}{2}$ " long.
7. Use a large flat blade screwdriver to remove the old stem and plunger from the manifold. Discard these parts.
8. Remove the old o-ring and clean out the solenoid manifold cavity.
9. Install the same size o-ring and the new solenoid valve provided in this kit into the solenoid manifold cavity. **Note:** Be sure to follow the correct order of assembly (see illustration) and only use a large flat blade screwdriver to tighten the solenoid stem to approximately 35-40 in. lbs.
10. Place the new coil onto the new solenoid stem and secure it with the new hex nut.
11. Cut the new solenoid coil wires approximately three inches from the coil and strip the wires approximately $\frac{1}{2}$ " long. Connect the wires using the wire nuts provided in the kit. Bundle and secure the wires using the included cable tie.
12. Reattach the solenoid manifold using the mounting screws removed in Step #4.
13. Recheck all wire connections and the cable tie. Remove the towel from Step #4 and clean up any oil.
14. Plug the chair back into the wall and check all chair functions. Then position the chair up and down several times in order to expel any air trapped in the system. Check for oil leaks. Install the pump cover.

Solenoid Manifold Assembly

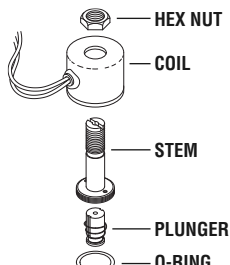

Note: Be sure to follow the correct order of assembly as shown, and only use a large flat blade screwdriver to tighten the solenoid stem to approximately 35-40 in. lbs.

TWO IDENTIFICATION MARKS

MANIFOLD