



replacement parts industries, inc.

CALL 800-221-9723 or 818-882-8611 • FAX 818-882-7028  
E-MAIL: techsupport@rpiparts.com • WEBSITE: www.rpiparts.com

## ADK089

### FOOT CONTROL SERVICE KIT (NEW STYLE) INSTALLATION INSTRUCTIONS

1. Turn off master switch. Remove screws from base plate. Remove foot control cover and retaining ring.
2. Completely disassemble foot control valve.
3. Inspect all parts and replace as needed. Be sure to clean and lubricate the Foot Control Stem (RPI Part #ADS090) and the Relay Valve Stem (RPI Part #ADS087) using Lubricant (RPI Part #RPL090) prior to reassembly. Refer to diagram below to make sure that all parts are properly located.
4. Install foot control cover and recheck the function of the foot control. (*See "Warning" note below.*)

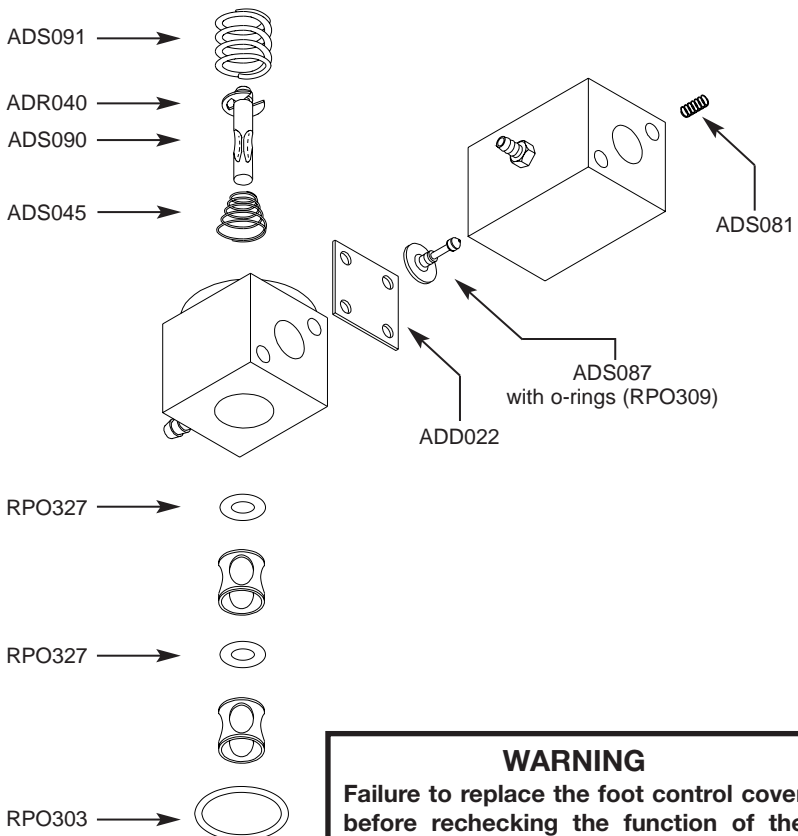

#### WARNING

Failure to replace the foot control cover before rechecking the function of the foot control may result in serious injury.