



## ADK088 & ADP084

### FOOT CONTROL SERVICE KIT (OLD STYLE) & PISTON WITH ADJUSTING SCREW INSTALLATION INSTRUCTIONS

1. Turn off master switch. Remove screws from base plate. Remove foot control cover and retaining ring.

2. Completely disassemble foot control valve.

3. Inspect all parts and replace as needed with parts included in kit per diagram below. Be sure to clean and lubricate the Piston (RPI Part #ADP084) and the Relay Valve Stem (RPI Part #ADS087) using Lubricant (RPI Part #RPL090) prior to reassembly. Apply Threadlocker (RPI Part #RPA032) to Piston Adjusting Screw, screw into place on piston, then follow "Adjustment Procedures" above.

4. See "Warning" note below. Install foot control cover and check the function of the foot control.

Adjustment Procedures	
PROBLEM	REMEDY
Too much free play or low pressure.	Remove cover and turn piston adjusting screw one quarter turn counter-clockwise.
Foot control does not shut off completely.	Remove cover, turn piston adjusting screw one quarter turn clockwise.

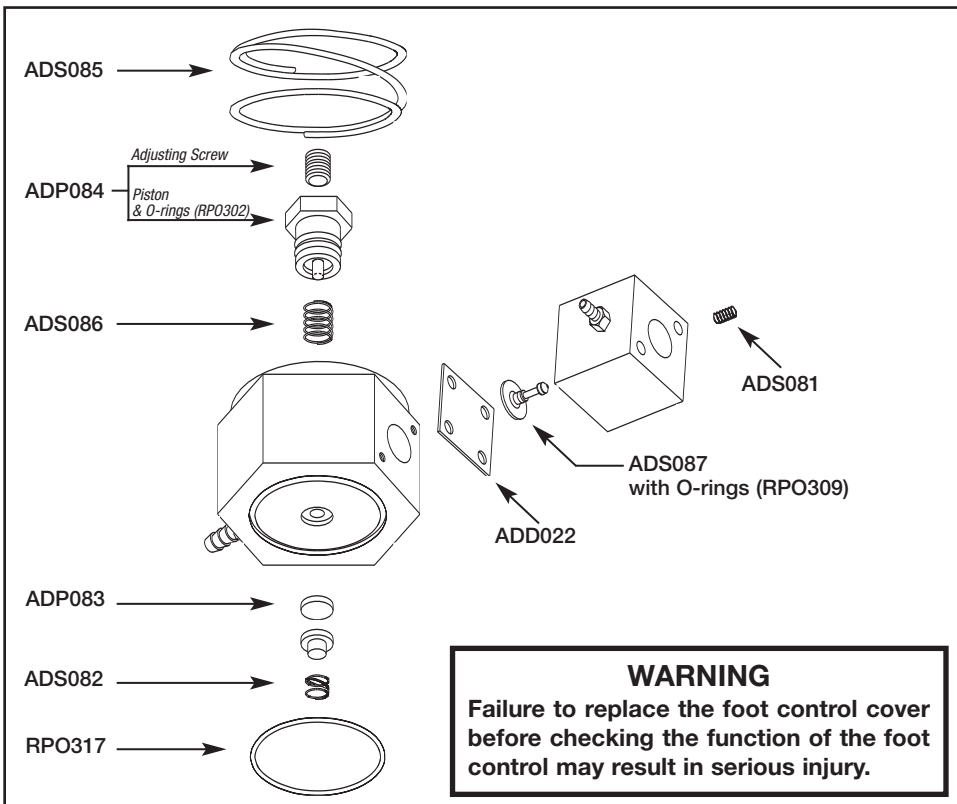

**WARNING**  
Failure to replace the foot control cover before checking the function of the foot control may result in serious injury.