

**MOTORS & GEARS TO FIT AIR TECHNIQUES
PERI-PRO (90000), PERI-PRO II (91000)
& PERI-PRO III (94000)**

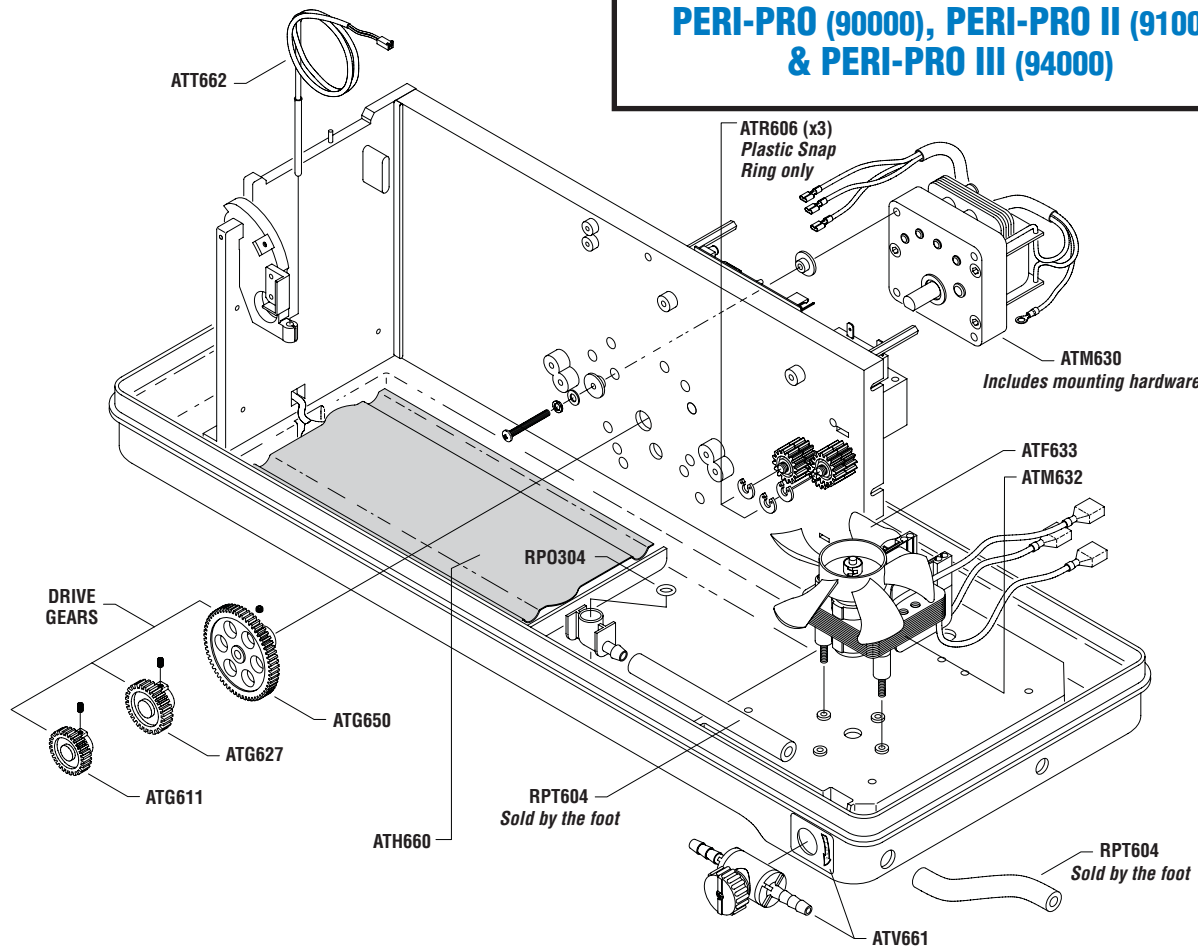

RPI PART #	OEM PART #	DESCRIPTION	PKG QTY	PERI-PRO			NOTES
				I	II	III	
ATG611	90995	MAIN DRIVE GEAR	1	•			<ul style="list-style-type: none"> • 30 teeth; .312" ID x 1.34" OD • Fits: Main Drive Motor
ATG627	90996	MAIN DRIVE GEAR	1		•		<ul style="list-style-type: none"> • 36 teeth; .312" ID x 1.57" OD • Fits: Main Drive Motor
ATG650	94995	MAIN DRIVE GEAR	1			•	<ul style="list-style-type: none"> • 66 teeth; .312" ID x 2.82" OD • Fits: Main Drive Motor
ATH660	94970	HEATER PLATE	1			•	<ul style="list-style-type: none"> • 40W, 24VDC; Thermal cutout opens at 112°F
ATM630	90147	MAIN DRIVE MOTOR	1	•	•	•	<ul style="list-style-type: none"> • 115VAC, 60 Hz. • Includes mounting hardware
ATM632	90880	DRYER FAN & MOTOR ASSEMBLY	1	•	•	•	<ul style="list-style-type: none"> • 115VAC, 60 Hz. • Includes Fan Blade (RPI Part #ATF633) • Includes mounting hardware
ATF633	90102	DRYER FAN BLADE	1	•	•	•	<ul style="list-style-type: none"> • Plastic • Mounts on 3/16" dia. motor shaft • Fits: Fan Motor Assembly
ATT662	94975	THERMISTOR PROBE	1			•	<ul style="list-style-type: none"> • Rated: 5000Ω at 25°C
ATV661	94994	DRAIN VALVE	1			•	<ul style="list-style-type: none"> • Includes valve handle, mounting hardware and decal • 1/4" hose barb
RPO304	60604	O-RING	12			•	<ul style="list-style-type: none"> • .301" ID x .441" OD x .070" C/S
RPT604	94124	DRAIN TUBING	Sold by the foot			•	<ul style="list-style-type: none"> • 1/4" ID x 3/8" OD • Material: clear flexible PVC • Fits: Drain Valve (RPI Part #ATV661)



replacement parts industries, inc.

CALL (800) 221-9723 • FAX (818) 882-7028 • EMAIL order@rpiparts.com • WEBSITE www.rpiparts.com

The above parts are manufactured by Replacement Parts Industries, Inc. to fit Air Techniques equipment. All product names used in this document are trademarks or registered trademarks of their respective holders. WEB 02/09