

More New Parts to fit Dental Compressors!

For more information about the parts listed in this flyer, see our website www.rpiparts.com

Includes all parts
as shown!

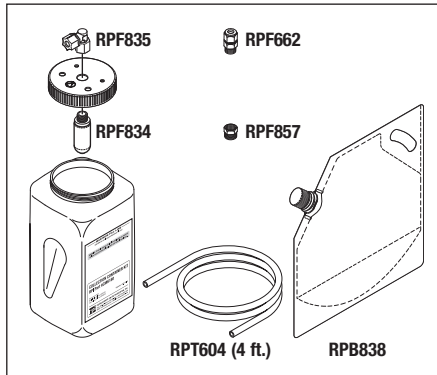

RPI Part #CMK180
OEM Part # See Chart on Back Page

COLLECTION CONTAINER KIT

- This one-of-kind collection bottle can replace the purge drain lines and be directly connected with tubing to the compressor so that the purge waste water and oil can be collected and disposed of properly according to local, state and federal regulations - It's the RPI Advantage!

Fits: Purge Assembly

Models: All Lubricated Compressors with Pressurized Purge Systems

Includes all parts
as shown!

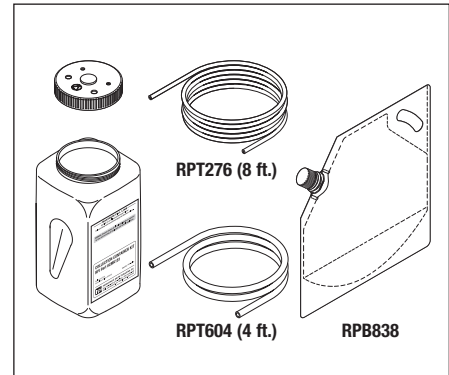

RPI Part #CMK181
OEM Part # See Chart on Back Page

COLLECTION CONTAINER KIT

- Accommodates up to 2 ea. 1/4" dia. tubing and 1 ea. 3/8" dia. tubing
- This one-of-kind collection bottle can replace the purge drain lines and be directly connected with tubing to the compressor so that the purge waste water and oil can be collected and disposed of properly according to local, state and federal regulations - It's the RPI Advantage!

Fits: Purge Assembly

Models: All Lubricated Compressors with Gravity Drain systems

Easy to fill,
transport and
dispose used oil!

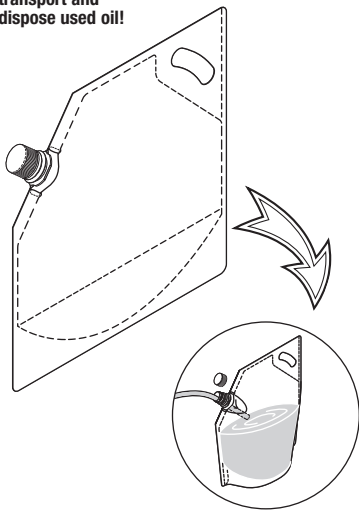

RPI Part #RPB838
OEM Part # See Chart on Back Page

DISPOSAL BAG

- Used oil collection and disposal bag
- 3 per package
- 1 gallon, clear plastic bag with cap, built in handle and expandable base
- Included in: Collection Container Kit (RPI Part #'s CMK180 & CMK181)

Models: All Lubricated Compressors

RPI Part #RPF662
OEM Part # See Chart on Back Page

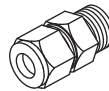

MALE CONNECTOR

- Material: Brass
 - Size: 1/4" MPT x 3/8" Tube
 - Includes: Compression Nut (RPI Part #RPF222) and Compression Sleeve (RPI Part #RPF218)
- Fits:** Collection Container Kit and Unloader Valve



RPI Part #RPF834
OEM Part # See Chart on Back Page

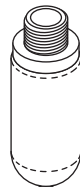

FILTER/MUFFLER

- Size: ~1" OD X 2-3/4" O/A lg.; 3/8" MPT
- Fits:** Collection Container Kit (RPI Part #CMK180)



RPI Part #RPF835
OEM Part # See Chart on Back Page

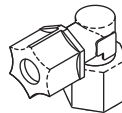

ELBOW FITTING

- Size: 3/8" Tube x 3/8" FPT
 - Material: Durable Nylon®
- Fits:** Collection Container Kit (RPI Part #CMK180)



RPI Part #RPF857
OEM Part # See Chart on Back Page

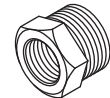

ADAPTOR (1/4 FPT x 3/8 MPT)

- 2 per package; Material: Brass
 - Size: 1/4" FPT x 3/8" MPT
- Fits:** Collection Container Kit (RPI Part #CMK180)

RPI Part #RPT276
OEM Part # See Chart on Back Page

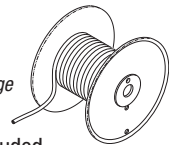

TUBING (1/4 OD CLEAR POLY)

- Sold by the foot, reel not included
 - Size: .159" ID x .250" OD
- Fits:** Collection Container Kit (RPI Part #CMK181) and Syringe Pump/Extractor (RPI Part #RPT842)

RPI Part #RPT604
OEM Part # See Chart on Back Page

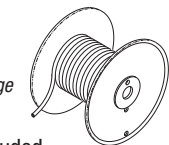

TUBING (1/4 ID CLEAR PVC)

- Sold by the foot, reel not included
 - Size: 1/4" ID x 3/8" OD
- Fits:** Drain Valve, Drain Port and Collection Container Kit (RPI Part #'s CMK180 & CMK181)

Air Techniques, Apollo/Midmark®, DentalEZ®/ Custom Air/RamVac, Jun-Air, Matrix/Midmark®, MDT McKesson, Midmark®, & Tech West

DENTAL COMPRESSORS -

SECTION

4

PAGE

415

UPDATED

04/14

Includes all parts as shown!

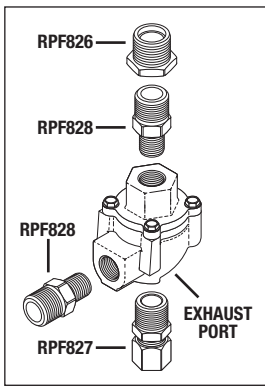

RPI Part #CMV121

OEM Part # See Chart on Back Page

UNLOADER VALVE

- Right angle quick exhaust valve with (2) 1/4" FPT ports and (1) 3/8" FPT exhaust port
- Also available: Unloader Valve Repair Kit (RPI Part CMK122), 1/4" Teflon Thread Sealing Tape (RPI Part #RPT579) and Copper Tubing (RPI Part #RPT547)

Fits: Desiccant Tank

RPI Part #RPF826

OEM Part # See Chart on Back Page

ADAPTOR (3/8 FPT x 1/2 MPT)

- 2 per package; Material: Brass
- Size: 3/8" FPT x 1/2" MPT

Fits: Unloader Valve

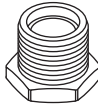

RPI Part #RPF827

OEM Part # See Chart on Back Page

MALE CONNECTOR

- 2 per package; Material: Brass
- Size: 3/8" tube x 3/8" MPT

Fits: Unloader Valve

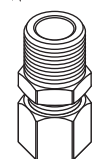

RPI Part #RPF828

OEM Part # See Chart on Back Page

ADAPTOR (1/4 MPT x 3/8 MPT)

- 2 per package; Material: Brass
- Size: 1/4" MPT x 3/8" MPT

Fits: Unloader Valve

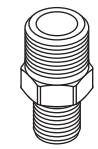

RPI Part #CMK122

OEM Part # See Chart on Back Page

UNLOADER VALVE REPAIR KIT

- Includes all parts as shown
- Also available: Unloader Valve (RPI Part CMV121)

Fits: Unloader Valve (RPI Part CMV121) only

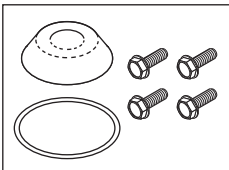

Includes all parts as shown!

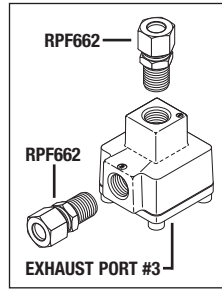

RPI Part #CMV123

OEM Part # See Chart on Back Page

UNLOADER VALVE

- Quick exhaust valve with (3) 1/4" FPT ports
- Also available: Unloader Valve Repair Kit (RPI Part #CMK124), 1/4" Teflon Thread Sealing Tape (RPI Part #RPT579) and Copper Tubing (RPI Part #RPT547)

Fits: Desiccant Tanks (MDT McKesson Part #3-08-0729-20 & 3-08-0800-30)

RPI Part #CMK124

OEM Part # See Chart on Back Page

UNLOADER VALVE REPAIR KIT

- Includes: Valve disk and O-ring
- Also available: Unloader Valve (RPI Part #CMV123)

Fits: Unloader Valve (RPI Part #CMV123)

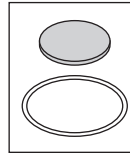

RPI Part #CMM017

OEM Part # See Chart on Back Page

PURGE MUFFLER

- Material: Sintered bronze
- Size: ~1-1/4" long; 1/4" MPT
- Also available: Unloader Valve (RPI Part #CMV123)

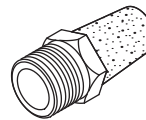

RPI Part #CMF127

OEM Part # See Chart on Back Page

CONE FILTER

- Material: Sintered bronze
- Size: ~.86" dia. x ~4.00" lg.
- Also available: Desiccant (Grade 20 G Silica Gel) (RPI Part #CMD091)

Fits: Drying Chamber

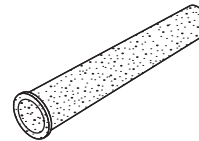

NEW

RPI Part #CMF129

OEM Part # See Chart on Back Page

DESICCANT TANK FILTER

- Material: Sintered bronze
- 3/8" FPT x 1/2" MPT
- Size: ~.87" dia. x ~3.62" lg.
- Also available: Desiccant (Grade 20 G Silica Gel) (RPI Part #CMD091), Desiccant (Activated Alumina) (RPI Part #CMD093) and Desiccant (Molecular Sieve) (RPI Part #CMD094)

Fits: Drying Chamber

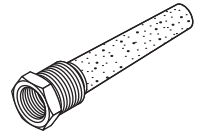

NEW

RPI Part #CMF130

OEM Part # See Chart on Back Page

DESICCANT TANK FILTER

- Material: Sintered bronze
- 1/4" FPT x 1/2" MPT
- Size: ~.87" dia. x ~3.62" lg.
- Also available: Desiccant (Grade 20 G Silica Gel) (RPI Part #CMD091), Desiccant (Activated Alumina) (RPI Part #CMD093) and Desiccant (Molecular Sieve) (RPI Part #CMD094)

Fits: Drying Chamber

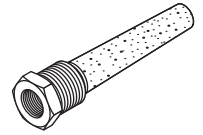

RPI Part #CMD091

OEM Part # See Chart on Back Page

DESICCANT

- Sold in 2 lb. bag
- Material: Grade 20 G Silica Gel

Fits: Desiccant Tank

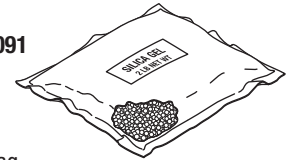

RPI Part #CMD093

OEM Part # See Chart on Back Page

DESICCANT

- Sold in 2 lb. bag
- Material: Activated Alumina

Fits: Desiccant Tank



RPI Part #CMD094

OEM Part # See Chart on Back Page

DESICCANT

- Sold in 2 lb. bag
- Material: Molecular Sieve

Fits: Desiccant Tank





RPI Part #CMV132
OEM Part # See Chart on Back Page

- SOLENOID VALVE (PURGE)**
- 1/4" FPT ports
 - 120VAC, 60 Hz., 8.7 W
 - Also available: Solenoid Valve Repair Kit (RPI Part #CMK133) and Adaptor (RPI Part #RPF833)
- Fits:** Purge Assembly

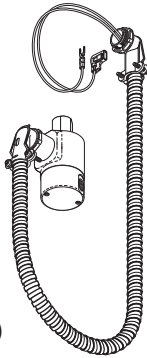

RPI Part #CMV134
OEM Part # See Chart on Back Page

- SOLENOID VALVE (PURGE)**
- 1/4" FPT ports
 - 230VAC, 60 Hz., 8.7 W
 - Also available: Solenoid Valve Repair Kit (RPI Part #CMK133) and Adaptor (RPI Part #RPF833)
- Fits:** Purge Assembly

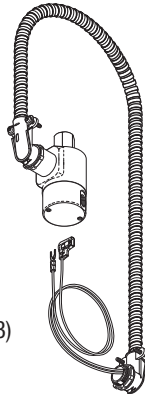

RPI Part #CMK133
OEM Part # See Chart on Back Page

- SOLENOID VALVE REPAIR KIT**
- Includes all parts as shown
 - Also available: Solenoid Valve (Purge) (RPI Part #'s CMV132 & CMV134)
- Fits:** Solenoid Valve (Purge)

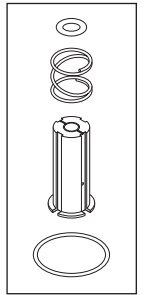

Includes all parts as shown!



RPI Part #CMV135
OEM Part # See Chart on Back Page

- SOLENOID VALVE (PURGE)**
- 120VAC, 50/60 Hz., 8W; 1/4" FPT ports
 - Also available: Solenoid Valve Repair Kit (RPI Part #CMK136), Exhaust Silencer (RPI Part #CMS128), and Adaptor (RPI Part #RPF833)
- Fits:** Purge Assembly

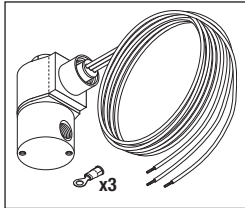

Includes all parts as shown!



RPI Part #CMV137
OEM Part # See Chart on Back Page

- SOLENOID VALVE (PURGE)**
- 208VAC, 60 Hz., 9W; 1/4" FPT ports
 - Also available: Solenoid Valve Repair Kit (RPI Part #CMK136), Exhaust Silencer (RPI Part #CMS128), and Adaptor (RPI Part #RPF833)
- Fits:** Purge Assembly

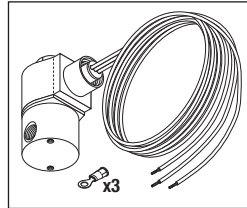

RPI Part #CMK136
OEM Part # See Chart on Back Page

- SOLENOID VALVE REPAIR KIT**
- Includes all parts as shown
 - Also available: Solenoid Valve (Purge) (RPI Part #'s CMV135 & CMV137)
- Fits:** Purge Solenoid Valve

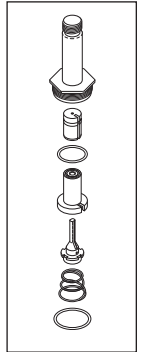

Includes all parts as shown!



RPI Part #CMV138
OEM Part # See Chart on Back Page

- SOLENOID VALVE (PURGE)**
- 120VAC, 50/60 Hz., 11W; 1/4" FPT ports
 - Also available: Solenoid Valve Repair Kit (RPI Part #CMK139) and Adaptor (RPI Part #RPF833)
- Fits:** Purge Assembly

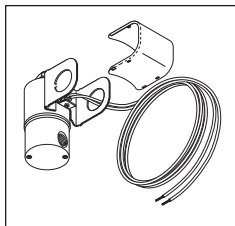

Includes all parts as shown!



RPI Part #CMV140
OEM Part # See Chart on Back Page

- SOLENOID VALVE (PURGE)**
- 230VAC, 50/60 Hz., 11W; 1/4" FPT ports
 - Also available: Solenoid Valve Repair Kit (RPI Part #CMK139) and Adaptor (RPI Part #RPF833)
- Fits:** Purge Assembly

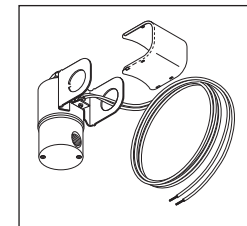

RPI Part #CMK139
OEM Part # See Chart on Back Page

- SOLENOID VALVE REPAIR KIT**
- Includes all parts as shown
 - Also available: Solenoid Valve (Purge) (RPI Part #'s CMV138 & CMV140)
- Fits:** Purge Solenoid Valve

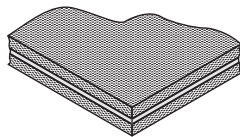
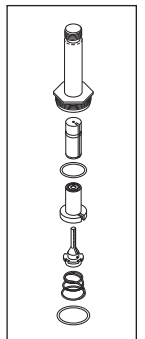

RPI Part #RPC822
OEM Part # See Chart on Back Page

- SOUND DAMPING COMPOSITE**
- Size: 12" x 12" x 1/2" thk.
 - Acoustic foam with vinyl barrier core and adhesive backing; Cut to size
- Fits:** Dental Compressor Sound Covers including: Midmark® OEM Part #'s 77001603, 77001604, 77001605, & 77001606 and Apollo/Midmark OEM Part #'s ACA70620, ACA70621, ACA70622, ACA70700, ACA70705, ACA70710, & ACA70715



RPI Part #CMS128
OEM Part # See Chart on Back Page

- EXHAUST SILENCER**
- Port Size: 1/2" FPT
 - Silences exhaust and eliminates mist
 - Also available: Adaptor (RPI Part #RPF833), Adaptor (RPI Part #RPF818), Drain Tubing (RPI Part #RPT604) and Collection Container Kit (RPI Part #CMK181)
- Fits:** Purge Solenoid Valve

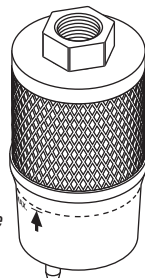

RPI Part #RPF818
OEM Part # See Chart on Back Page

- ADAPTOR (1/4 FPT x 1/2 MPT)**
- 2 per package; Material: Brass
 - Also available: Exhaust Silencer (RPI Part #CMS128)
- Fits:** Desiccant Tank Filter



RPI Part #RPF833
OEM Part # See Chart on Back Page

- ADAPTOR (1/4 MPT x 1/4 MPT)**
- 2 per package; Material: Brass
 - Also available: Exhaust Silencer (RPI Part #CMS128)
- Fits:** Exhaust Silencer





replacement parts industries, inc.

20338 Corisco Street • Chatsworth, California • 91311

PRESORTED STANDARD
U.S. POSTAGE PAID
VAN NUYS, CA
PERMIT NO. 2399

ADDRESS SERVICES REQUESTED

LOOK!

**More New Parts to fit
Dental Compressors!**

Chart of RPI parts to fit Dental Compressors included in this flyer - See our website for a complete list of parts!

RPI PART #	DESCRIPTION	AIR TECHNIQUES	APOLLO/ MIDMARK	DCI/MDT McKESSON	MATRIX/ MIDMARK	MIDMARK	TECH WEST
CMV132	Solenoid Valve (Purge)	85423, 85946, 85377-1					
CMV134	Solenoid Valve (Purge)	85424, 85377-2, 85378, 85379					
CMK133	Solenoid Valve Repair Kit	85423					
CMV135	Solenoid Valve (Purge)		PVW70501 ACA85332		77001324 77001571	002-1390-00 002-1391-00	
CMV137	Solenoid Valve (Purge)		PVW70502 ACA85332		77001325 77001572 77001570	002-1383-00 002-1384-00 002-1385-00 002-1386-00 002-1387-00 002-1388-00 002-1389-00	
CMK136	Solenoid Valve Repair Kit		No OEM Part # Available		No OEM Part # Available	No OEM Part # Available	
CMV138	Solenoid Valve (Purge)						DSV-115
CMV140	Solenoid Valve (Purge)						DSV-230
CMK139	Solenoid Valve Repair Kit						No OEM Part # Available
CMV121	Unloader Valve	60030	ACA85966				
CMK122	Unloader Valve Repair Kit	No OEM Part # Available	No OEM Part # Available				
CMV123	Unloader Valve			3-08-0308-10			
CMK124	Unloader Valve Repair Kit			No OEM Part # Available			
CMK180	Collection Container Kit		SPA95400		No OEM Part # Available	No OEM Part # Available	No OEM Part # Available
CMK181	Collection Container Kit		SPA95400		No OEM Part # Available	No OEM Part # Available	No OEM Part # Available
CMF127	Cone Filter	60097					
CMF129	Desiccant Tank Filter		PFM70301		PFM70301	PFM70301	No OEM Part # Available
CMF130	Desiccant Tank Filter		PFM70300		PFM70300	PFM70300	
CMD091	Desiccant	60010	RAM80105				
CMD093	Desiccant		RAM80100				MDS-200
CMD094	Desiccant						MDS-100
CMS128	Exhaust Silencer					62983300	
CMN017	Purge Muffler	80330		No OEM Part # Available			AS-250
RPC822	Sound Damping Composite	No OEM Part # Available	No OEM Part # Available	No OEM Part # Available	No OEM Part # Available	No OEM Part # Available	No OEM Part # Available
RPI Parts Included in Kits listed above							
RPB838	Disposal Bag		See CMK180 & CMK181		See CMK180 & CMK181	See CMK180 & CMK181	See CMK180 & CMK181
RPF662	Male Connector		See CMK180	See CMV123	See CMK180	See CMK180	See CMK180
RPF818	Adaptor (1/4 FPT x 1/2 MPT)					See CMS128	
RPF826	Adaptor (3/8 FPT x 1/2 MPT)	See CMV121	See CMV121				
RPF827	Male Connector	See CMV121	See CMV121				
RPF828	Adaptor (1/4 MPT x 3/8 MPT)	See CMV121	See CMV121				
RPF833	Adaptor (1/4 MPT x 1/4 MPT)					See CMS128	
RPF834	Filter/Muffler		See CMK180		See CMK180	See CMK180	See CMK180
RPF835	Elbow Fitting		See CMK180		See CMK180	See CMK180	See CMK180
RPF857	Adaptor (1/4 FPT x 3/8 MPT)		See CMK180		See CMK180	See CMK180	See CMK180
RPT276	Tubing (1/4 OD CLEAR POLY)		See CMK181		See CMK181	See CMK181	See CMK181
RPT604	Tubing (1/4 ID CLEAR PVC)		See CMK180 & CMK181		See CMK180 & CMK181	See CMK180 & CMK181	See CMK180 & CMK181

New Parts are shown in Bold Face type See our website www.rpiparts.com for specific models these parts fit.