

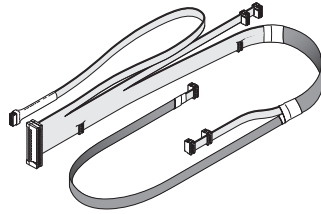

# New parts to fit A-dec Dental Chairs!

**RPI Part #ADC204**  
**OEM Part #61.0612.00**

**CABLE ASSY (MAIN)**  
 • Overall length: ~46"  
**Fits:** Connects Chair Top, Chair Seat & Chair Base Assemblies  
**Models:** Priority 1005 Chairs (serial #M1-0001 thru D3-0134)



**RPI Part #ADC207**  
**OEM Part #61.0599.00**

**CABLE ASSY (MAIN)**  
 • Overall Length: ~68"  
**Fits:** Connects Chair Top, Chair Seat and Chair Base Assemblies  
**Models:** Priority 1005 Chairs (serial #D3-0135 thru H3-0067)

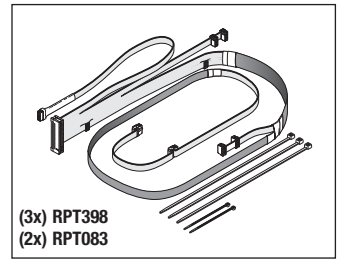

Includes all parts as shown!

**RPI Part #ADK221**  
**OEM Part #041.164.00 & 90.1031.00**

**CAPACITOR KIT**  
 • 50uf, 280VAC, 50/60Hz  
**Fits:** "B" Box  
**Models:** Priority 1005 Chairs (serial #M1-0001 to present), Cascade, Decade, Positioner & Performer III Chairs

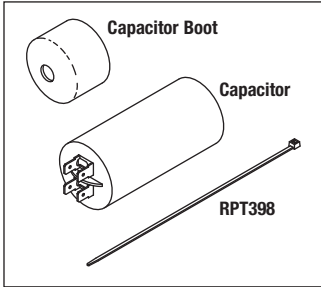

Includes all parts as shown!

**RPI Part #ADK208**  
**OEM Part #61.0668.00**

**CABLE ASSY (MAIN COMPLETE)**  
 • Overall Length: ~70.50"  
**Fits:** Connects chair Top, Chair Seat and Chair Base Assemblies  
**Models:** Priority 1005 Chairs (serial #H3-0068 thru present)

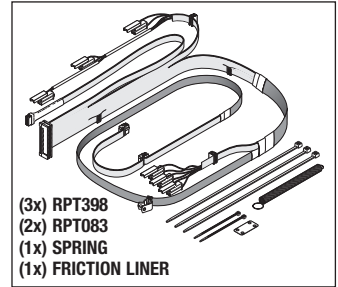

Includes all parts as shown!

**RPI Part #ADC205**  
**OEM Part #61.0624.00**

**CABLE ASSY (CTRL SWITCHES)**  
 • Overall length: ~24"  
**Fits:** Chair Back Assembly  
**Models:** Priority 1005 Chairs (serial #M1-0001 thru D3-0134)

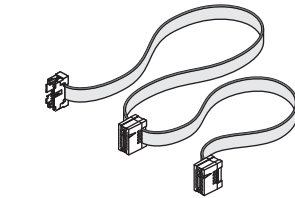

**RPI Part #ADC209**  
**OEM Part #61.0693.00**

**CABLE (PRE-POSITION BASE)**  
 • Overall Length: ~12.50"  
**Fits:** Connects the Main Cable to Lift Pre-Position Assembly (OEM Part #61.0593.00)  
**Models:** Priority 1005 chairs (serial #H3-0068 thru present)

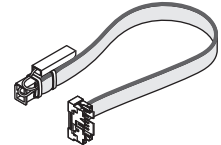

**RPI Part #ADC206**  
**OEM Part #61.0613.00**

**CABLE ASSY (LIFT LIMIT)**  
 • Over length: ~18.25"  
**Fits:** Base Assembly  
**Models:** Priority 1005 Chairs (serial #M1-0001 thru H3-0067)

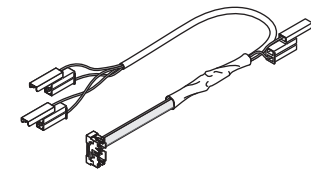

**RPI Part #ADC210**  
**OEM Part #61.0614.00**

**CABLE ASSY (STOP PLATE)**  
 • Overall Length: ~23.50"  
**Fits:** Base Assembly  
**Models:** Priority 1005 Chairs (serial #M1-0001 thru present)

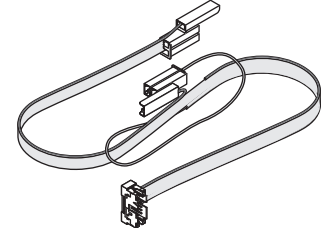

**RPI Part #ADC226**  
**OEM Part #61.0025.00 (Cable) & 006.023.00 (Nut)**

**BRAKE CABLE**  
**Fits:** Swivel and Brake Assembly  
**Models:** Priority 1005 Chairs (serial #M1-0001 thru H3-0067)

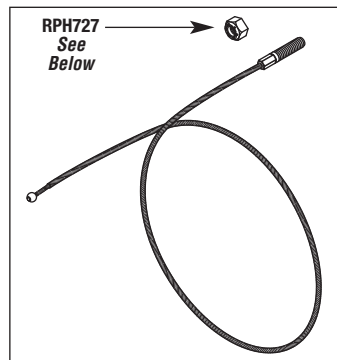

Includes all parts as shown!

Also available, NUT, HEX (1/4-20) (RPI Part #RPH727) -10/Pkg

**RPI Part #ADM225**  
**OEM Part #61.0081.00 (Mount) & 010.028.00 (Retaining Ring)**

**MOUNT (BRAKE CABLE)**  
**Fits:** Swivel and Brake Assembly  
**Models:** Priority 1005 Chairs (serial #M1-0001 thru H3-0067)

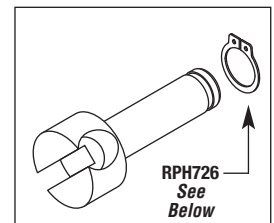

Includes all parts as shown!

Also available, RETAINING RING (EXTERNAL) (RPI Part #RPH726) -10/Pkg



replacement parts industries, inc.

CALL (800) 221-9723 • FAX (818) 882-7028 • EMAIL order@rpiparts.com • WEBSITE www.rpiparts.com

The above parts are manufactured by Replacement Parts Industries, Inc. to fit A-dec equipment. All product names used in this document are trademarks or registered trademarks of their respective holders. Web 11/10

# Dental Equipment

Model: Cascade 1040; Decade 1010, 1011, 1020 & 1021; Performer I, II & III; Positioner 1030; Priority 1005

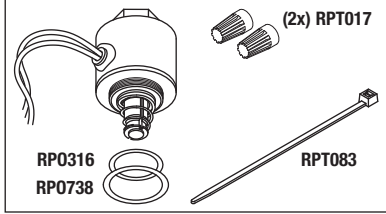

Includes all parts as shown!

RPI Part #ADK220  
OEM Part #60.0601.00

### SOLENOID VALVE REPAIR KIT

• 24 VDC; 7.4 W; Coil ~78 Ω with ~18" lg black wires

**Fits:** Manifold Assembly

**Models:** Priority 1005 Chairs (serial #M1-0001 thru L3-0200)

Also available,

RPI Part #RPO316

OEM Part #030-015-02

O-RING -12/Pkg

RPI Part #RP0738

OEM Part #35.041.02

O-RING -10/Pkg

RPI Part #RPT083

OEM Part # (No OEM Part # Available)

CABLE TIE (4" WHITE) -25/Pkg



RPI Part #ADS211  
New OEM Part #044.184.01  
Old OEM Part #044.049.01

### LIMIT SWITCH (MODIFIED)

• 15.1A @ 125/250 VAC

**Fits:** Various positions & chairs

**Models:** Cascade 1040; Decade 1010, 1011, 1020 & 1021; Performer III; Positioner 1030; Priority 1005 Chairs

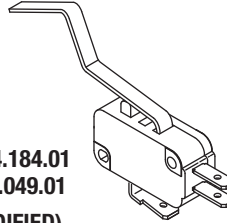

RPI Part #ADS223  
OEM Part #041.119.00

### SWITCH (MINIATURE)

• 10.1A @ 125/250VAC

**Fits:** 8 Function Footswitch (OEM Part #61.3043.80) 100VAC/120VAC & 240 VAC

**Models:** Priority 1005 Chairs (serial #M1-0001 to Present)

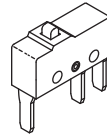

RPI Part #ADS212  
New OEM Part #044.184.00  
Old OEM Part #044.049.00

### MICRO-SWITCH

• 15.1A @ 125/250 VAC

**Fits:** Various positions and chairs

**Models:** Decade 1010, 1011, 1020 & 1021; Performer I, II & III

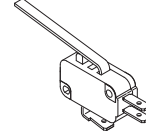

RPI Part #ADS224  
OEM Part #041.059.00

### SWITCH (PUSHBUTTON)

• 5A @ 120VAC, 2.5A @ 220VAC

**Fits:** 8 Function Footswitch, Multi-Function Footswitch, Auto Return and Pre-position Assemblies

**Models:** Cascade 1040; Decade 1021; Priority 1005 Chairs (serial #D3-0135 to present)

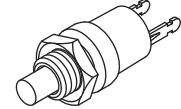

RPI Part #ADH217  
OEM Part #61.0217.01

### HOSE ASSY (TILT CYLINDER)

• Length: ~44.00"

• Fittings: 7/16-20 Flare Female x 7/16-20 Flare 90° Elbow

**Fits:** Tilt Cylinder

**Models:** Priority 1005 Chairs (serial #M1-0001 thru present)

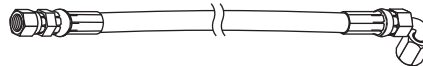

RPI Part #ADH218  
OEM Part #61.0218.01

### HOSE ASSY (LIFT CYLINDER)

• Length: ~10.00"

• Fittings: 7/16-20 Flare Female x 7/16-20 Flare 90° Elbow

**Fits:** Lift Cylinder

**Models:** Priority 1005 Chairs (serial #M1-0001 thru present)



**Don't Forget ...**  
RPI also carries

- Tilt Cylinders
- Lift Cylinders
- Hydraulic Fluid to fit A-dec Chairs.

Look inside for  
new parts to fit  
A-dec Dental Chairs!

ADDRESS SERVICES REQUESTED

PERMIT NO. Z399  
VAN NUYS, CA  
U.S. POSTAGE PAID  
PRESORTED STANDARD

20338 Corisco Street • Chatsworth, California • 91311  
**replacement parts industries, inc.**

