

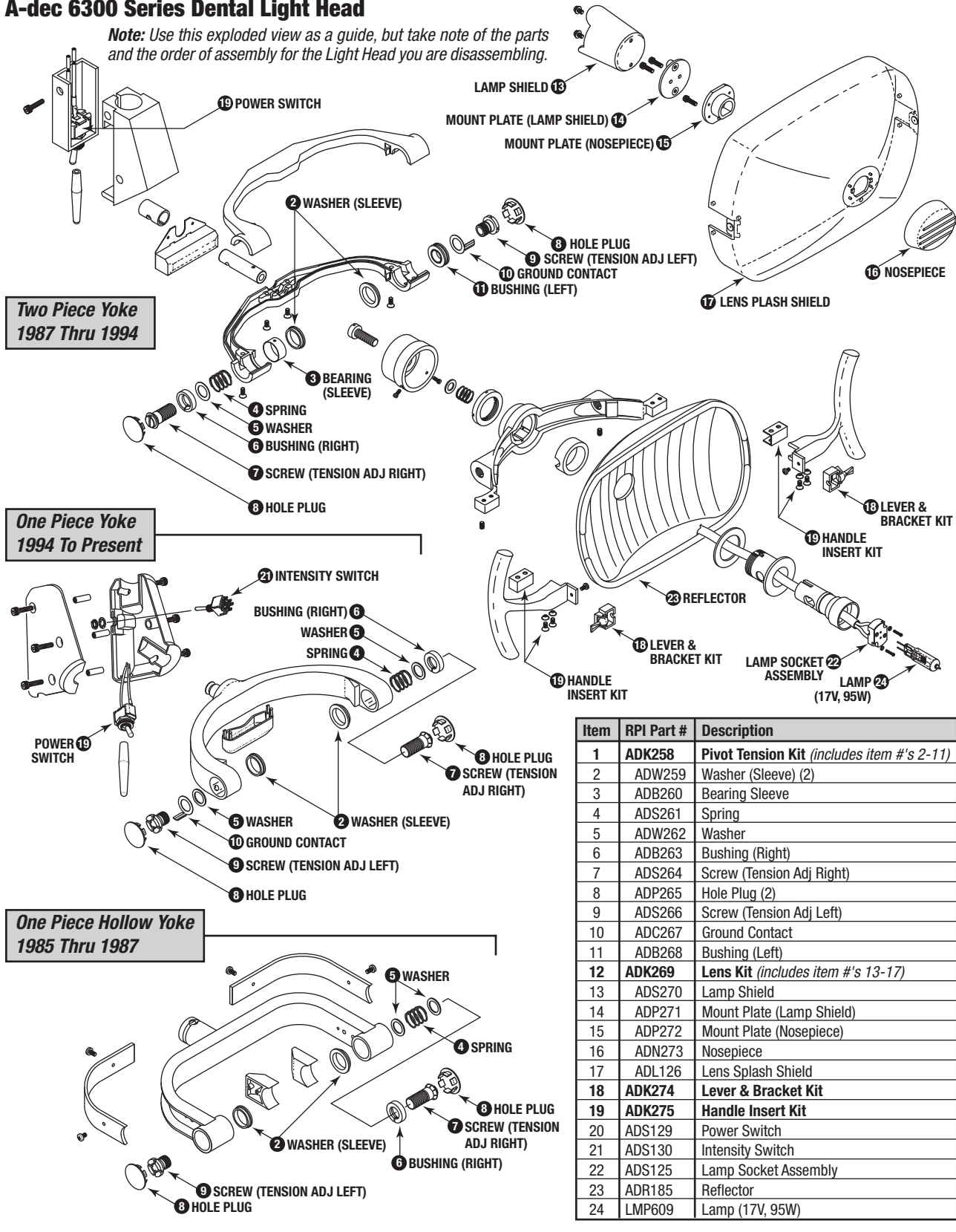

# New parts to fit A-dec 6300 Series Dental Lights!

## A-dec 6300 Series Dental Light Head

*Note: Use this exploded view as a guide, but take note of the parts and the order of assembly for the Light Head you are disassembling.*



Item	RPI Part #	Description
1	ADK258	Pivot Tension Kit (includes item #'s 2-11)
2	ADW259	Washer (Sleeve) (2)
3	ADB260	Bearing Sleeve
4	ADS261	Spring
5	ADW262	Washer
6	ADB263	Bushing (Right)
7	ADS264	Screw (Tension Adj Right)
8	ADP265	Hole Plug (2)
9	ADS266	Screw (Tension Adj Left)
10	ADC267	Ground Contact
11	ADB268	Bushing (Left)
12	ADK269	Lens Kit (includes item #'s 13-17)
13	ADS270	Lamp Shield
14	ADP271	Mount Plate (Lamp Shield)
15	ADP272	Mount Plate (Nosepiece)
16	ADN273	Nosepiece
17	ADL126	Lens Splash Shield
18	ADK274	Lever & Bracket Kit
19	ADK275	Handle Insert Kit
20	ADS129	Power Switch
21	ADS130	Intensity Switch
22	ADS125	Lamp Socket Assembly
23	ADR185	Reflector
24	LMP609	Lamp (17V, 95W)

The above parts are manufactured by Replacement Parts Industries, Inc. to fit A-dec equipment. All product names used in this document are trademarks or registered trademarks of their respective holders. Show 10/12

# Dental Equipment

Models: 6300 Series



**RPI Part #ADL126**  
**OEM Part #28-0503-01**

**LENS SPLASH SHIELD**

- Clear plastic
- Mounting hardware not included

**Fits:** Light head  
**Models:** 6300 Series

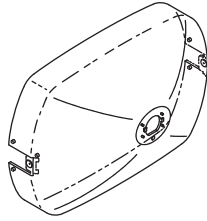

**RPI Part #ADR185**  
**OEM Part #** (No OEM Part # Available)

**REFLECTOR**

- New glass - Not Re-coated

**Fits:** Light head  
**Models:** 6300 Series



**Includes Reflector and a FREE Lens Splash Shield (RPI Part #ADL126)**

**RPI Part #ADK269**  
**OEM Part #28.0503.02**

**LENS KIT**

- Includes all parts as shown
- All parts sold separately
- Also available: Lever & Bracket Kit (RPI Part #ADK274)

**Fits:** Lens Assembly  
**Models:** 6300 Series

RPI PART #	OEM PART #	DESCRIPTION	MATERIAL	QTY PER PACKAGE
ADL126	28-0503-01	Lens Splash Shield	Clear Plastic	1
ADN273	75.007.00 & 28.0504.00	Nosepiece • Includes: Mounting Screw	Plastic	1
ADP271	28.0554.00	Mount Plate (Lamp Shield) • Includes: (2) Mounting Screws	Plastic	1
ADP272	28.0553.00	Mount Plate (Nosepiece) • Includes: Mounting Screw	Plastic	1
ADS270	28.0555.00	Lamp Shield • Includes: (2) Mounting Screws	Flat Black Steel	1

**RPI Part #ADK258**  
**OEM Part #28.0770.00 (Bearing Sleeve only)/ 018.063.00 (Black Hole Plug only)/28.1536.00 (Surf Hole Plug only)**

**PIVOT TENSION KIT**

- Includes all parts as shown
- All parts sold separately

**Fits:** Yoke Assembly  
**Models:** 6300 Series

*Note: The assembly order of the parts included in our Pivot Tension Kit vary dramatically depending upon the Light Head. The Light Heads will use all or some of the parts included in our Pivot Tension Kit.*

RPI PART #	OEM PART #	DESCRIPTION	MATERIAL	KIT QUANTITY	REORDER QUANTITY
ADB260	28.0770.00	Bearing Sleeve	Nickel Plated Brass	1	1
ADB263	No OEM Part # Available	Bushing (Right)	White Plastic	1	1
ADB268	No OEM Part # Available	Bushing (Left)	White Plastic Sleeve & Brass Bushing	1	1
ADC267	No OEM Part # Available	Ground Contact	Copper	1	1
ADP265	018.063.00 (Black) & 28.1536.00 (Surf)	Hole Plug	Off-White Plastic	2	2
ADS261	No OEM Part # Available	Spring	Music Wire	1	1
ADS264	No OEM Part # Available	Screw (Tension Adj. Right)	Brass	1	1
ADS266	No OEM Part # Available	Screw (Tension Adj. Left)	Brass	1	1
ADW259	No OEM Part # Available	Washer (Sleeve)	White Plastic	2	1
ADW262	No OEM Part # Available	Flat Washer	White Plastic	2	1



**RPI Part #ADK274**  
**OEM Part #28.1012.00 (Surf)/28.0643.00 (Black)**

**LEVER & BRACKET KIT**

- 2 per package
  - Color: Gray
- Fits:** Lens Assembly  
**Models:** 6300 Series

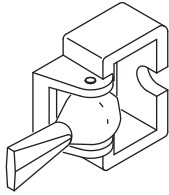

**RPI Part #ADS125**  
**OEM Part #28-0633-00**

**LAMP SOCKET ASSEMBLY**

- Includes all parts as shown
  - Also available: Lamp (RPI Part #LMP609)
- Fits:** Inside of Focus Tube  
**Models:** 6300 Series

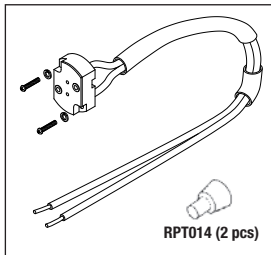

**RPI Part #LMP609**  
**OEM Part #041.709.00/041.179.00/041.179.01/ 28.1004.00 (Bulb & Holder only)**

**LAMP (17V, 95W)**

- Halogen Bulb
  - G6.35 2-Pin base
  - Also available: Lamp Socket Assembly (RPI Part #ADS125)
- Fits:** Light Socket Assembly  
**Models:** 6300 Series



**RPI Part #ADT127**  
**OEM Part #28-0566-00**

**LOCKING TAB**

- Material: Oilite bronze
- Fits:** Pivot Arm to Mounting Hub  
**Model:** 6300 Series



**RPI Part #ADK275**  
**OEM Part #28.0628.00 (Handle only)/28.0629.00 (Handle only)**

**HANDLE INSERT KIT**

- 2 per package
  - Material: Plastic
  - Includes all parts as shown
- Fits:** Handles  
**Models:** 6300 Series

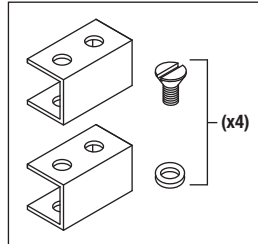

**RPI Part #ADS129**  
**OEM Part #041-336-00/90.1039.00**

**POWER SWITCH**

- Toggle switch
  - 20A @ 125VAC; 10A @ 250VAC; SPST
  - Includes all parts as shown
- Fits:** Head Assembly and Swivel Block  
**Models:** 6300 Series

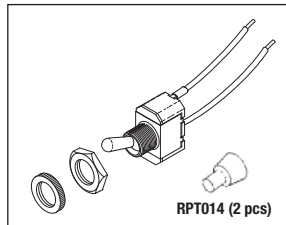

**RPI Part #ADS130**  
**OEM Part #041-177-00**

**INTENSITY SWITCH**

- Toggle switch
  - 6A @ 125VAC; 3A @ 250VAC
  - On-On-On; DPDT; .093" Tabs
  - Includes: Mounting hardware
- Fits:** Transformer Housing, Box Assembly and Pivot Arm Assembly  
**Models:** 6300 Series

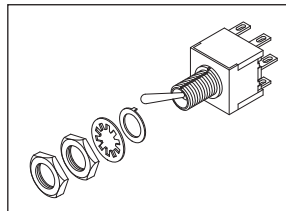

**RPI Part #RPH243**  
**OEM Part #046-123-000**

**CIRCUIT BREAKER**

- 10A @ 250VAC
  - Includes all parts as shown
  - Manual reset
- Fits:** Transformer Housing of Ceiling, Wall, Unit and Track Assembly  
**Models:** 6300 Series

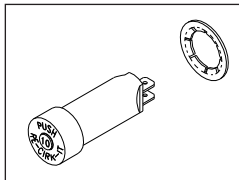

**RPI Part #ADT132**  
**OEM Part #28-0724-00/90.1041.00**

**TRANSFORMER**

- 120/240V, 50/60Hz
  - Includes all parts as shown
- Fits:** Preference II, Box Assembly  
**Models:** 6300 Series

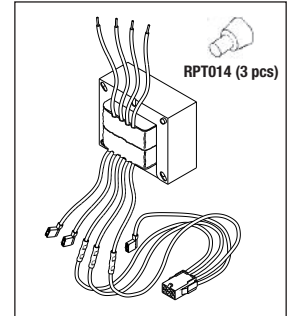

**RPI Part #ADT133**  
**OEM Part #28-0822-00/90.1040.00**

**TRANSFORMER**

- 120/240V, 50/60Hz
  - Includes all parts as shown
- Fits:** Track Light, Box Assembly  
**Models:** 6300 Series (before 1993)

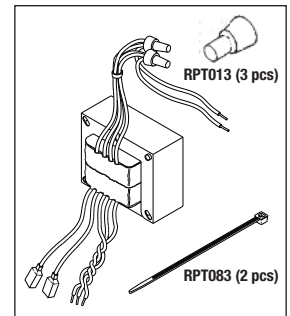

**RPI Part #ADT134**  
**OEM Part #28-0720-00/90.1040.00**

**TRANSFORMER**

- 120/240V, 50/60Hz
  - Includes all parts as shown
- Fits:** Rigid Arm Assembly on Ceiling, Wall and Unit Mounted Lights  
**Models:** 6300 Series - Excellence and Preference I

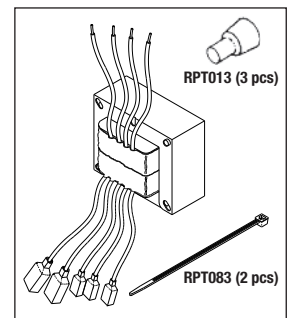



**replacement parts industries, inc.**

20338 Corisco Street • Chatsworth, California • 91311

PRESORTED STANDARD  
U.S. POSTAGE PAID  
VAN NUYS, CA  
PERMIT NO. 2399

ADDRESS SERVICES REQUESTED

## List of RPI Parts to fit A-dec 6300 Series Dental Lights!

RPI PART #	OEM PART #	DESCRIPTION
ADB260	28.0770.00	Bearing Sleeve
ADB263	No OEM Part # Available	Bushing (Right)
ADB268	No OEM Part # Available	Bushing (Left)
ADC267	No OEM Part # Available	Ground Contact
ADK258	28.0770.00 (Bearing Sleeve only), 018.063.00 (Black Hole Plug only) & 28.1536.00 (Surf Hole Plug only)	Pivot Tension Kit
ADK269	28.0503.02	Lens Kit
ADK274	28.1012.00 (Surf) & 28.0643.00 (Black)	Lever & Bracket Kit - 2/Pkg
ADK275	28.0628.00 (Handle only) & 28.0629.00 (Handle only)	Handle Insert Kit
ADL126	28-0503-01	Lens Splash Shield
ADN273	75.007.00 & 28.0504.00	Nosepiece
ADP265	018.063.00 (Black) & 28.1536.00 (Surf)	Hole Plug - 2/Pkg
ADP271	28.0554.00	Mount Plate (Lamp Shield)
ADP272	28.0553.00	Mount Plate (Nosepiece)
ADR185	No OEM Part # Available	Reflector - Includes <b>FREE</b> Lens Splash Shield (RPI Part #ADL126)
ADS125	28-0633-00	Lamp Socket Assembly
ADS129	041-336-00	Power Switch
ADS130	041-177-00	Intensity Switch
ADS261	No OEM Part # Available	Spring
ADS264	No OEM Part # Available	Screw (Tension Adj Right)
ADS266	No OEM Part # Available	Screw (Tension Adj Left)
ADS270	28.0555.00	Lamp Shield
ADT127*	28-0566-00	Locking Tab
ADT132	28-0724-00 & 90.1041.00	Transformer
ADT133	28-0822-00 & 90.1040.00	Transformer
ADT134**	28-0720-00 & 90.1040.00	Transformer
ADW259	No OEM Part # Available	Washer (Sleeve)
ADW262	No OEM Part # Available	Flat Washer
LMP609	041.179.00, 041.179.01, 041.709.00 & 28.1004.00 (Bulb & Holder only)	Lamp (17V, 95W)
RPH243	046-123-000	Circuit Breaker

\* Fits 6300 Series Ceiling/Track Mount, Preference I/II and Wall Mount

\*\* Fits 6300 Series - Excellence and Preference I

CALL (800) 221-9723 • FAX (818) 882-7028 • EMAIL [order@rpiparts.com](mailto:order@rpiparts.com) • WEBSITE [www.rpiparts.com](http://www.rpiparts.com)